



Connells

Columbian Drive  
Cannock



### Ground Floor

#### Hallway

Having a double glazed front entrance door, vinyl flooring, radiator, ceiling light point, stairs to the first floor and doors to living room and kitchen

#### Living Room

Having a double glazed window to the front aspect, radiator, ceiling light point and laminate flooring

#### Kitchen/Diner

Being a fitted kitchen with a range of wall, base and drawer units with laminate work surfaces over and having a sink/drain, integrated oven stack, extractor fan, tiled splash-backs, plumbing for the washing machine, space for appliances, radiator, two ceiling light points, laminate flooring, space for dining furniture, double glazed window to the rear aspect and a double glazed door to the rear garden



## First Floor

### Landing

Having carpeted flooring, ceiling light point, carpeted flooring, loft hatch and doors to the bedrooms and bathroom

### Bedroom 1

Having a double glazed window to the front aspect, fitted wardrobes, over bed storage space, radiator, ceiling light point and carpeted flooring

### Bedroom 2

Having a double glazed window to the rear aspect, built in wardrobes, radiator, ceiling light point and carpeted flooring

### Bedroom 3

Having a double glazed window to the front aspect, radiator, ceiling light point and carpeted flooring

### Bathroom

Having a double glazed window to the rear aspect, WC, wash hand basin, bath with shower over, tiled walls, radiator, ceiling light point and carpeted flooring

## Outside

### Front

Having a brick paved driveway to the side, lawn area to the front, floral borders and gated access to the rear garden

### Rear

Having a paved patio area, lawn area, mature borders with a variety of shrubs, trees and floral displays, rear decking area, two garden sheds and a summer house







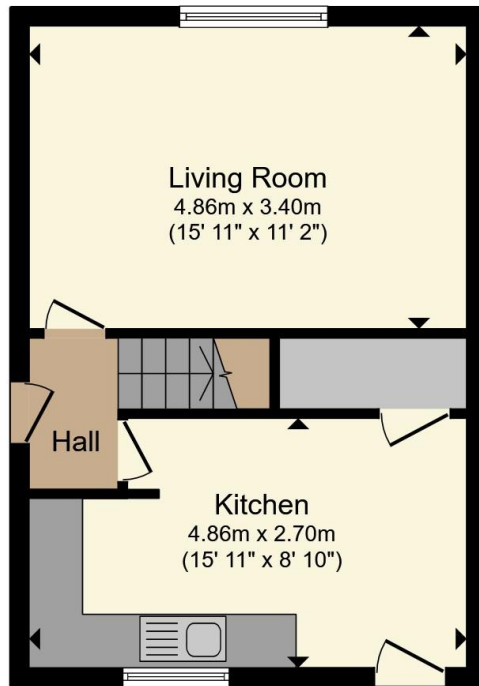

**Ground Floor**

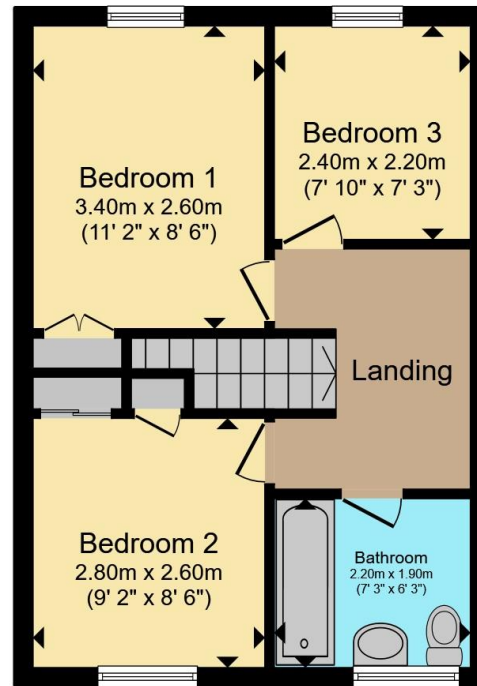

**First Floor**

Total floor area 70.6 m<sup>2</sup> (759 sq.ft.) approx

This floor plan is for illustrative purposes only. It is not drawn to scale. Any measurements, floor areas (including any total floor area), openings and orientation are approximate. No details are guaranteed, they cannot be relied upon for any purpose and they do not form part of any agreement. No liability is taken for any error, omission or misstatement. A party must rely upon its own inspection(s). Powered by [www.propertybox.io](http://www.propertybox.io)



To view this property please contact Connells on

**T 01543 500923**  
**E [cannock@connells.co.uk](mailto:cannock@connells.co.uk)**

10-12 Wolverhampton Road  
 CANNOCK WS11 1AH

EPC Rating: Council Tax  
 Awaited Band: B

Tenure: Freehold

**view this property online [connells.co.uk/Property/CNK108341](http://connells.co.uk/Property/CNK108341)**



1. MONEY LAUNDERING REGULATIONS Intending purchasers will be asked to produce identification documentation at a later stage and we would ask for your co-operation in order that there will be no delay in agreeing the sale. 2. These particulars do not constitute part or all of an offer or contract. 3. The measurements indicated are supplied for guidance only and as such must be considered incorrect. Potential buyers are advised to recheck measurements before committing to any expense. 4. We have not tested any apparatus, equipment, fixtures, fittings or services and it is in the buyers interest to check the working condition of any appliances.

Connells Residential is registered in England and Wales under company number 1489613, Registered Office is Cumbria House, 16-20 Hockliffe Street, Leighton Buzzard, Bedfordshire, LU7 1GN. VAT Registration Number is 500 2481 05.

**See all our properties at [www.connells.co.uk](http://www.connells.co.uk) | [www.rightmove.co.uk](http://www.rightmove.co.uk) | [www.zoopla.co.uk](http://www.zoopla.co.uk)**

Property Ref: CNK108341 - 0001