



Nightingale Lodge Cowper Road, Berkhamsted HP4 3ED



Situated at the rear of the over 60s Nightingale Lodge development the property is accessed via an entry lobby with secure phone system into a spacious hallway. The dual aspect lounge/ dining room is a fantastic bright space whilst the kitchen features a range of units offering plenty of storage and a integrated electric oven and hob. Further accommodation includes a double bedroom offering space and comfort and a bathroom with a fitted shower. Externally the property offers attractive lawned communal gardens for enjoyment and residents parking.





welcome to Nightingale Lodge Cowper Road, Berkhamsted

- Over 60's Development
- First Floor
- One Double Bedroom
- Dual Aspect Living/Dining
- Warden Controlled

Tenure: Leasehold EPC Rating: C

Council Tax Band: B Service Charge: 4524.00

Ground Rent: 150.00

This is a Leasehold property with details as follows; Term of Lease 99 years from 25 Dec 1985. Should you require further information please contact the branch. Please Note additional fees could be incurred for items such as Leasehold packs.

guide price

£130,000

A well presented and spacious one double bedroom first floor retirement apartment in the popular and conveniently located Nightingale Lodge development, located in the heart of Berkhamsted town centre.

Cowper Road, Berkhamsted, HP4

Approximate Area = 494 sq ft / 45.9 sq m

For identification only - Not to scale

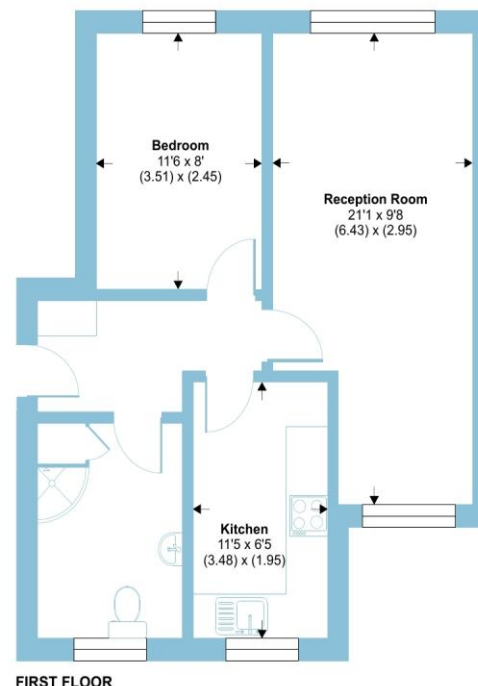

FIRST FLOOR

Floor plan produced in accordance with RICS Property Measurement 2nd Edition, incorporating International Property Measurement Standards (IPMS2 Residential). © nichicom 2025. Produced for Barnard Marcus. REF: 1387367



check out more properties at [brownandmerry.co.uk](https://www.brownandmerry.co.uk)

see all our properties on [zoopla.co.uk](https://www.zoopla.co.uk) | [rightmove.co.uk](https://www.rightmove.co.uk) | [sequencehome.co.uk](https://www.sequencehome.co.uk)



Property Reference:
BKH103141 - 0005

1. MONEY LAUNDERING REGULATIONS Intending purchasers will be asked to produce identification documentation at a later stage and we would ask for your co-operation in order that there is no delay in agreeing the sale. 2. These particulars do not constitute part or all of an offer or contract. 3. The measurements indicated are supplied for guidance only and as such must be considered incorrect. Potential buyers are advised to recheck measurements before committing to any expense. 4. We have not tested any apparatus, equipment, fixtures or services and it is in the buyers interest to check the working condition of any appliances. 5. Where an EPC, or a Home Report (Scotland only) is held for this property, it is available for inspection at the branch by appointment. If you require a printed version of a Home Report, you will need to pay a reasonable production charge reflecting printing and other costs. 6. We are not able to offer an opinion either written or verbal on the content of these reports and this must be obtained from your legal representative. 7. Whilst we take care in preparing these reports, a buyer should ensure that his/her legal representative confirms as soon as possible all matters relating to title including the extent and boundaries of the property and other important matters before exchange of contracts.



01442 870444



berkhamsted@brownandmerry.co.uk



124 High Street, BERKHAMSTED,
Hertfordshire, HP4 3AT



[brownandmerry.co.uk](https://www.brownandmerry.co.uk)