



Treearth Square  
Nottingham





## Property Description

The ground floor comprises an entrance hallway leading into a bright and spacious lounge diner, perfect for both relaxing and entertaining. The fitted kitchen offers ample storage and worktop space and is complemented by a separate utility room for added convenience.

To the first floor are three well-proportioned bedrooms, all served by a family bathroom.

Externally, the property enjoys an enclosed rear garden, providing a pleasant outdoor space for everyday use.

An excellent opportunity with practical living space throughout — early viewing is advised.

## Entrance Hallway

Accessed via UPVC front door leading into the hallway with vinyl flooring, storage cupboard and stairs rising to the first floor

## Lounge/ Diner

Having wood effect flooring, electric fireplace, French doors to the rear elevation and window to the front elevation.

## Kitchen

Having wall and base units with work surfaces over, inset stainless steel sink and a half with drainer, spot lights, UPVC door to the rear elevation, a radiator, electric double oven, induction hob with extractor over,.

## Utility Room

Having space for a fridge freezer, space and plumbing for washing machine, space and plumbing for tumble dryer and cupboard housing the meters.

## First Floor Landing

Having loft access which is part boarded and cupboard housing the boiler.

## Bedroom One

Having window to the front elevation, a radiator and over stairs storage.

## Bedroom Two

Having window to the rear elevation and a radiator.

## Bedroom Three

Having window to the front elevation and a radiator

## Bathroom

Having low level W.C, vanity wash hand basin, P-shaped panelled bath with electric shower over, chrome heated towel rail, tiled flooring, tiled walls, two obscured windows to the rear elevation and privacy lights.

## Outside

To the front of the property is a driveway providing off road parking.

To the rear the garden is fully enclosed with a patio seating area, laid lawn, outside tap and side access.







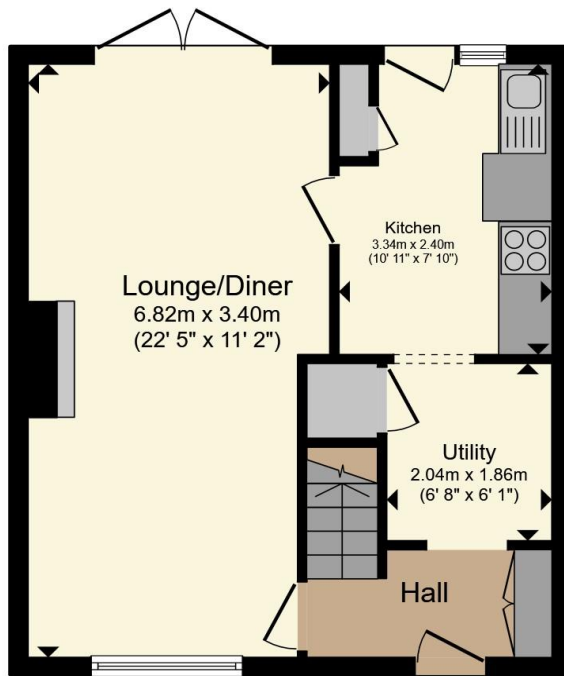

**Ground Floor**

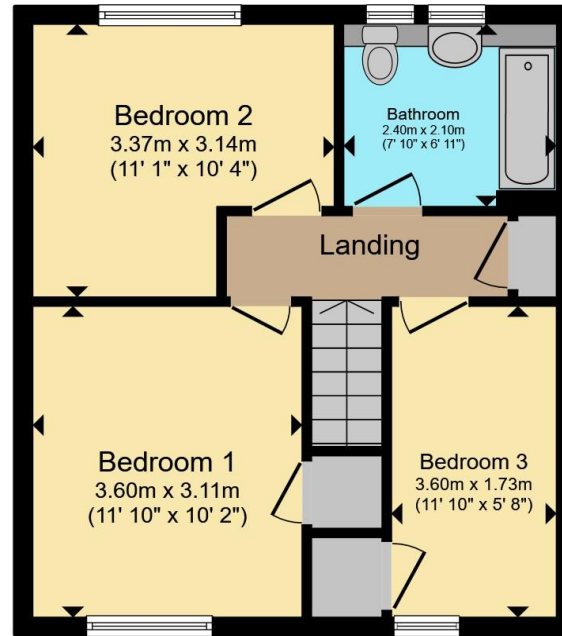

**First Floor**

Total floor area 80.5 m<sup>2</sup> (866 sq.ft.) approx

This floor plan is for illustrative purposes only. It is not drawn to scale. Any measurements, floor areas (including any total floor area), openings and orientation are approximate. No details are guaranteed, they cannot be relied upon for any purpose and they do not form part of any agreement. No liability is taken for any error, omission or misstatement. A party must rely upon its own inspection(s). Powered by [www.propertybox.io](http://www.propertybox.io)



To view this property please contact Burchell Edwards on

**T 0115 968 0528**  
**E [hucknall@burchelledwards.co.uk](mailto:hucknall@burchelledwards.co.uk)**

64 High Street Hucknall  
 NOTTINGHAM NG15 7AX

EPC Rating: F Council Tax  
 Band: A

Tenure: Freehold

**check out more properties at [burchelledwards.co.uk](http://burchelledwards.co.uk)**



1. MONEY LAUNDERING REGULATIONS Intending purchasers will be asked to produce identification documentation at a later stage and we would ask for your co-operation in order that there will be no delay in agreeing the sale. 2. These particulars do not constitute part or all of an offer or contract. 3. The measurements indicated are supplied for guidance only and as such must be considered incorrect. Potential buyers are advised to recheck measurements before committing to any expense. 4. We have not tested any apparatus, equipment, fixtures, fittings or services and it is in the buyers interest to check the working condition of any appliances.

Burchell Edwards is a trading name of Connells Residential which is registered in England and Wales under company number 1489613, Registered Office is Cumbria House, 16-20 Hockliffe Street, Leighton Buzzard, Bedfordshire, LU7 1GN. VAT Registration Number is 500 2481 05.

**See all our properties at [www.burchelledwards.co.uk](http://www.burchelledwards.co.uk) | [www.rightmove.co.uk](http://www.rightmove.co.uk) | [www.zoopla.co.uk](http://www.zoopla.co.uk)**

Property Ref: HUK104827 - 0001