



Cedar House, Heatherhayes, Ipswich, IP2 9DD

welcome to

Cedar House, Heatherhayes, Ipswich

This well-presented, ground floor flat benefits from two double bedrooms, a living room with Juliet balcony, a spacious kitchen, a garage (rented separately for £90 pcm), residents parking and communal gardens.

Entrance Hall

Carpet flooring and a storage cupboard.

Kitchen

Spacious kitchen with eye and base level units in wood with stone effect worktop surfaces, a stainless steel sink plus drainer and chrome mixer tap, a window to the side, wood effect flooring, space for a washing machine, cooker and fridge/freezer, a wall mounted, gas fired boiler and one radiator.

Living Room

A Juliet balcony to the front, wood effect flooring and one radiator.

Master Bedroom

Double glazed window to the front, carpet flooring, one radiator and a wall papered wall.

Bedroom Two

Double glazed window to the side, carpet flooring, one radiator, a fitted wardrobe and a wall papered wall.

Bathroom

Low level WC, pedestal wash hand basin, a bath with overhead shower, partially tiled walls, white heated towel rail, tiled effect flooring and extractor fan.

Communal Garden

Large communal garden with a grassed area and hedging. This area is perfect for enjoying the afternoon sun!

Garage

This garage is currently rented separately for £90 pcm but is included in the sale.

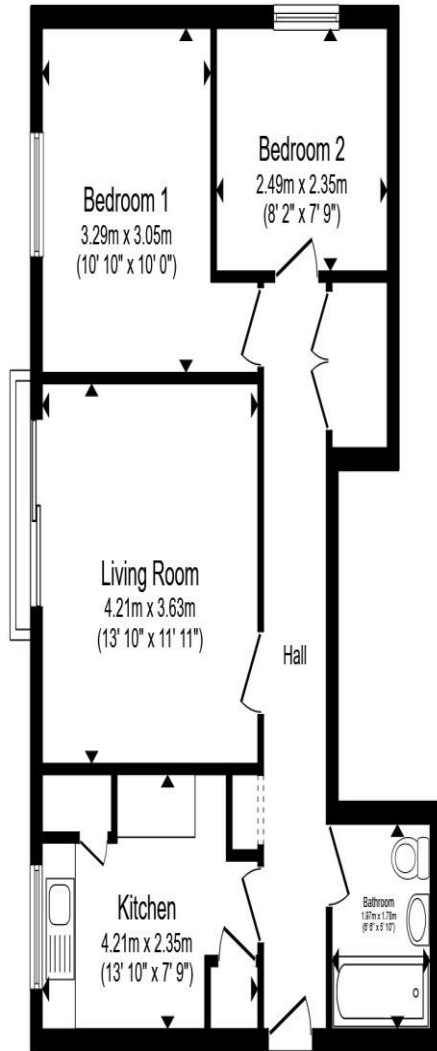

Total floor area 57.3 m² (616 sq.ft.) approx

This floor plan is for illustrative purposes only. It is not drawn to scale. Any measurements, floor areas (including any total floor area), openings and orientation are approximate. No details are guaranteed, they cannot be relied upon for any purpose and they do not form part of any agreement. No liability is taken for any error, omission or misstatement. A party must rely upon its own inspection(s). Powered by www.propertybox.io



welcome to
Cedar House, Heatherhayes,
Ipswich

- INVESTORS ONLY
- Tenant in situ
- Ground floor apartment
- Two double bedrooms
- Garage (rented separately for £90 pcm)

Tenure: Leasehold EPC Rating: C

Council Tax Band: A Service Charge: 1700.00

Ground Rent: Ask Agent

This is a Leasehold property with details as follows; Term of Lease 125 years from 29 Sep 1981. Should you require further information please contact the branch. Please Note additional fees could be incurred for items such as Leasehold packs.

£115,000



view this property online williamhbrown.co.uk/Property/IPS121351



Property Ref:
IPS121351 - 0002

1. MONEY LAUNDERING REGULATIONS Intending purchasers will be asked to produce identification documentation at a later stage and we would ask for your co-operation in order that there is no delay in agreeing the sale. 2. These particulars do not constitute part or all of an offer or contract. 3. The measurements indicated are supplied for guidance only and as such must be considered incorrect. Potential buyers are advised to recheck measurements before committing to any expense. 4. We have not tested any apparatus, equipment, fixtures or services and it is in the buyers interest to check the working condition of any appliances. 5. Where an EPC, or a Home Report (Scotland only) is held for this property, it is available for inspection at the branch by appointment. If you require a printed version of a Home Report, you will need to pay a reasonable production charge reflecting printing and other costs. 6. We are not able to offer an opinion either written or verbal on the content of these reports and this must be obtained from your legal representative. 7. Whilst we take care in preparing these reports, a buyer should ensure that his/her legal representative confirms as soon as possible all matters relating to title including the extent and boundaries of the property and other important matters before exchange of contracts.

William H Brown is a trading name of Sequence (UK) Limited which is registered in England and Wales under company number 4268443, Registered Office is Cumbria House, 16-20 Hockliffe Street, Leighton Buzzard, Bedfordshire, LU7 1GN. VAT Registration Number is 500 2481 05.



william h brown



01473 226101



ipswich@williamhbrown.co.uk



16-18 Wolsey House, Princes Street, IPSWICH,
Suffolk, IP1 1QT



williamhbrown.co.uk