



43 Berneshaw Close

Corby, Northamptonshire NN18 8EJ



Simpson West

Simpson West are delighted to offer to the market for sale this immaculately presented TWO bedroom semi detached residence located within the popular Oakley Vale area. The property occupies a pleasant position nestled away within a quiet cul-de-sac and is within walking distance to the local school, shops and amenities. Features include an entrance hall, living room and modern fitted kitchen dining room with fitted appliances. To the first floor there are two large double bedrooms and the main family bathroom with three piece suite. To the rear is a large enclosed garden with patio area. To the front is a large drive providing parking for multiple vehicles. Early viewings are highly encouraged. Energy Rating C. Council Tax Band B.

£195,000



2



1



1



Simpson West

Ground Floor



First Floor

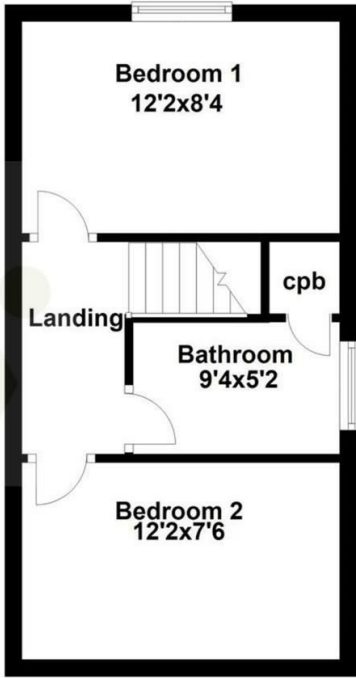

Floor plan not to scale - for guidance purposes only.
Plan produced using PlanUp.



Energy Efficiency Rating		
	Current	Potential
Very energy efficient - lower running costs		
(92 plus) A		
(81-91) B		88
(69-80) C	73	
(55-68) D		
(39-54) E		
(21-38) F		
(1-20) G		
Not energy efficient - higher running costs		
England & Wales	EU Directive 2002/91/EC	



When you buy with Simpson West, you know **you'll be in safe hands**. From the moment you walk through our doors, we'll make you **feel truly welcome**. Our sales consultants and financial advisors will take you through **every step of the process**, offering **free expert advice** along the way, from help choosing the right mortgage and insurance through to finding your conveyancer. And if you need help selling your home too, **with over 20 years of local experience, you can trust us to get you moving**.



**Simpson
West**

Making Every
Journey Personal



01536 202007

info@simpsonwest.co.uk

<https://www.simpsonwest.co.uk/>

64 Corporation Street, Corby, Northants, NN17 1NH