



Broom Road, TW11
£799,950

Waterview

A wonderful cottage situated beside Teddington Lock and presented in excellent condition. There is exceptional living / entertaining space and two double bedrooms.

Broom Road is situated just off Ferry Road, running parallel to Kingston Road. Teddington High Street and mainline station are close by.





You enter the house into an impressive split level kitchen/dining room with a pretty fireplace and a built in snug area under the stairs, it is exceptionally spacious and light. The reception room is off to the side with another fireplace and doors onto the secluded garden which if preferred could be used as an off street parking space.

Upstairs there are two double bedrooms, both including fitted wardrobes and then a bathroom. A loft room with Velux window provides plenty of storage or could be made into a study for a perfect area to work from home.

Features

- No Onward Chain
- Freehold
- Off Street Parking
- Close To The River
- Two Double Bedrooms
- Central Location



Broom Road, Teddington, TW11

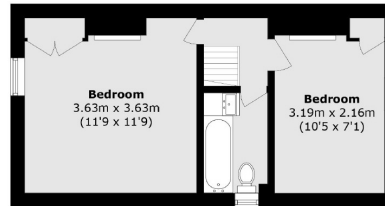

First Floor

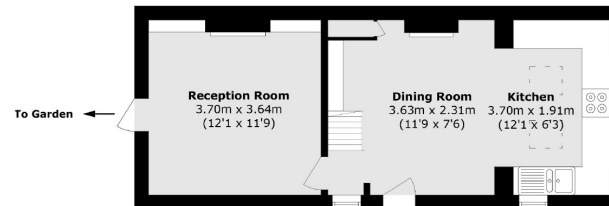

Ground Floor

Total area (approx.): 64.2 sq. m (691.0 sq. ft)

Contact

To arrange a viewing call our office on the number below or visit our website.



Energy Rating: D. We aim to make our particulars both accurate and reliable. However they are not guaranteed; nor do they form part of an offer or contract. If you require clarification on any points then please contact us, especially if you're traveling some distance to view. Please note that appliances and heating systems have not been tested and therefore no warranties can be given as to their good working order.

