



WESTBOURNE GROVE, W11

£1,050,000

Potential roof terrace (STPP)

Two double bedrooms

South-facing balcony

High ceilings

First floor

EPC- C



ABOUT THE PROPERTY

An attractive first-floor split-level apartment set within a fine terrace of Victorian houses, ideally positioned just to the west of Chepstow Road.

The nearest Underground station is Notting Hill Gate (Central, Circle and District lines), with an excellent selection of shops, cafés and restaurants all within easy reach.



STEP INSIDE WESTBOURNE GROVE

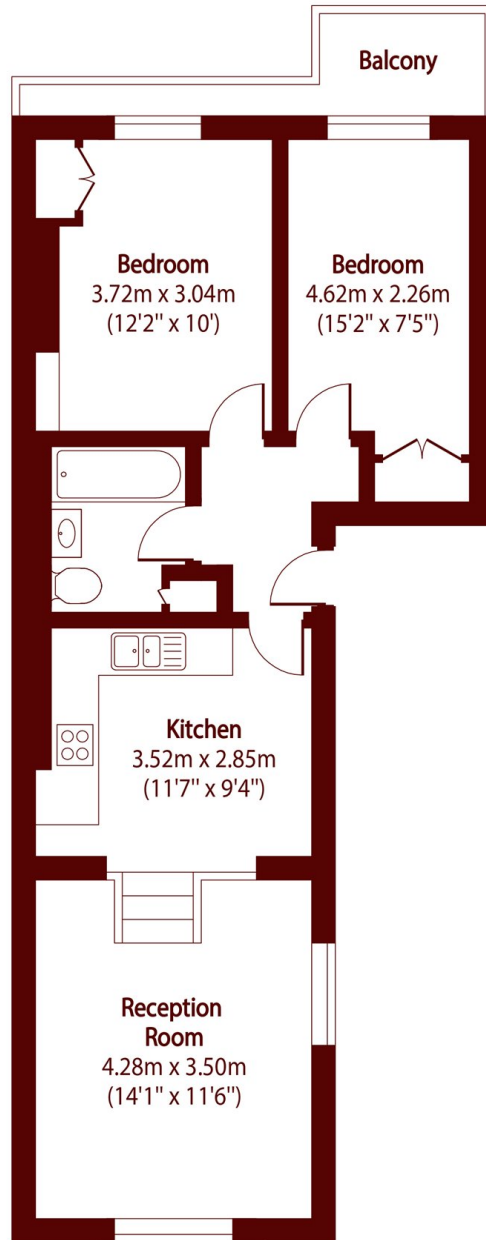

Total area (approx): 57.15 sq m (615 sq. ft)

Balcony total area (approx): 4.25 sq m (46 sq. ft)

Notting Hill
020 7313 2890

Energy Rating: C We aim to make our particulars both accurate and reliable. However, they are not guaranteed; nor do they form part of an offer or contract. If you require clarification on any points then please contact us, especially if you're traveling some distance to view. Please note that appliances and heating systems have not been tested and therefore no warranties can be given as to their good working order

MARSH &
PARSONS