



RICHMONDS

Firs Drive, Hedge End, Southampton, SO30 4QQ

£699,995

A substantial five-bedroom family home offering approximately 2,100 sq. ft. of well-proportioned accommodation, set on the edge of Hedge End village and benefiting from no forward chain.

The property sits within a generous plot, featuring a large rear and surrounding garden along with ample parking for multiple vehicles.

Internally, the accommodation comprises a welcoming entrance hallway, spacious sitting room, separate dining room kitchen/breakfast room, study, and utility room. Upstairs offers five bedrooms and two bathrooms, including an en-suite to the principal bedroom.

Built circa 1990, this characterful home also benefits from double-glazed windows, a serviced boiler, and a partially boarded loft providing useful additional storage.

This is an excellent opportunity to acquire a spacious family home with scope for personalisation, conveniently located close to local amenities and transport links.

Other Information

Tenure: Freehold
Approximate Age: Built circa. 1990
Heating: Gas central heating (serviced boiler)
Windows: Double glazing
Loft: Partially boarded
Energy Rating: D
Sellers Position: No forward chain

Local Information:

Council Tax: F
Local Authority: Eastleigh Borough Council



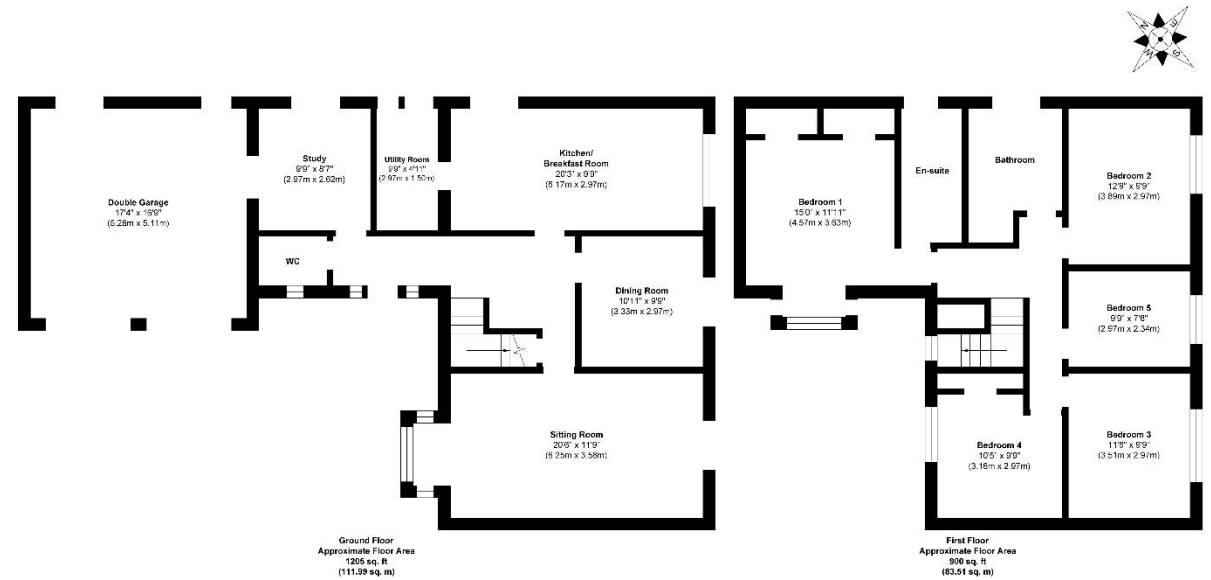

Approx. Gross Internal Floor Area 2105 sq. ft / 195.50 sq. m (Including Garage)

Illustration for identification purposes only. measurements are approximate, not to scale.

Produced by Elements Property

Score	Energy rating	Current	Potential
92+	A		
81-91	B		
69-80	C		77 C
55-68	D	67 D	
39-54	E		
21-38	F		
1-20	G		

www.harpsurveyors.co.uk

Agents Note: The sellers of the property have provided the above information to us and we are therefore reliant on them providing the correct information. The floor plan and sizes are to be used as a guide only. Please check room sizes prior to ordering carpets or furniture. If you require confirmation on any particular point for specific purposes please contact our office for further information. If you have other questions about this property, please telephone **01489 789933**

R545 Ravensworth 01670 713330

Lankester House, 1 Freegrounds Road, Hedge End, Southampton SO30 0HG • 01489 789933 • admin@richmondsproperty.co.uk

