



**Christopher Acre**  
**Norden, Rochdale OL11 5FE**  
**ASKING PRICE £340,000**

**Adamsons Barton Kendal** are delighted to present this beautiful four-bedroom detached family home in Norden Village.

\*

Perfectly positioned in the heart of Norden, the property occupies a pleasant cul-de-sac location, offering a wonderful balance of convenience and tranquillity. Ideally situated close to well-regarded local schools including Whittaker Moss, Caldershaw and St Vincent's, the home also benefits from easy access to nearby countryside and popular walking routes.

\*

The property boasts a double driveway leading to a single garage. Internally, it offers a spacious lounge with a handy dining area, featuring patio doors that open directly onto the rear garden—creating an ideal space for family living and entertaining guests. The fitted kitchen/breakfast room includes integrated appliances such as a fridge, freezer, ovens and cooker.

\*

Upstairs, the principal bedroom benefits from fitted wardrobes and cupboards, along with a modern en-suite shower room. There are two further double bedrooms and an additional single bedroom, currently utilised as a study, providing flexible accommodation.

\*

Externally, the property features a patio seating area and a raised lawn, creating a good-sized family garden perfect for children and outdoor enjoyment.

\*

This home represents a fantastic opportunity for growing families and has been lovingly cared for and maintained by the current owners.

\*

Early viewing is highly recommended.

**Christopher Acre, Norden, Rochdale OL11 5FE**

**THE ACCOMMODATION COMPRISES:**

(Measurements are approximate to the nearest 0.1m and for guidance only and they should not be relied upon for the fitting of carpets or the placement of furniture). No checks have been made on any fixtures and fittings or services where connected (water, electricity, gas and drainage) heating appliances or any other electrical or mechanical equipment in this property).

**Ground Floor**

Lounge: 4.22 x 4.89 metres

Dining Area: 3.04 x 2.39 metres

Kitchen: 3.04 x 2.40 metres

Breakfast Room: 3.04 x 2.54 metres

Garage: 5.21 x 2.54 metres

Separate WC

**First Floor**

Bedroom : 5.65 x 2.54 metres

En Suite: 1.61 x 2.54 metres

Bathroom: 1.61 x 2.13 metres

Bedroom 2: 3.45 x 3.01 metres

Bedroom 3: 3.81 x 3.01 metres

Bedroom 4: 2.36 x 2.24 metres



**Christopher Acre, Norden, Rochdale OL11 5FE**



**Christopher Acre, Norden, Rochdale OL11 5FE**



Christopher Acre, Norden, Rochdale OL11 5FE



Christopher Acre, Norden, Rochdale OL11 5FE

# VIEWING STRICTLY BY APPOINTMENT WITH SOLE AGENTS ADAMSONS BARTON KENDAL

## Tenure

TBC

## Council Tax Band

Band D

## Energy Performance Certificate

TBC

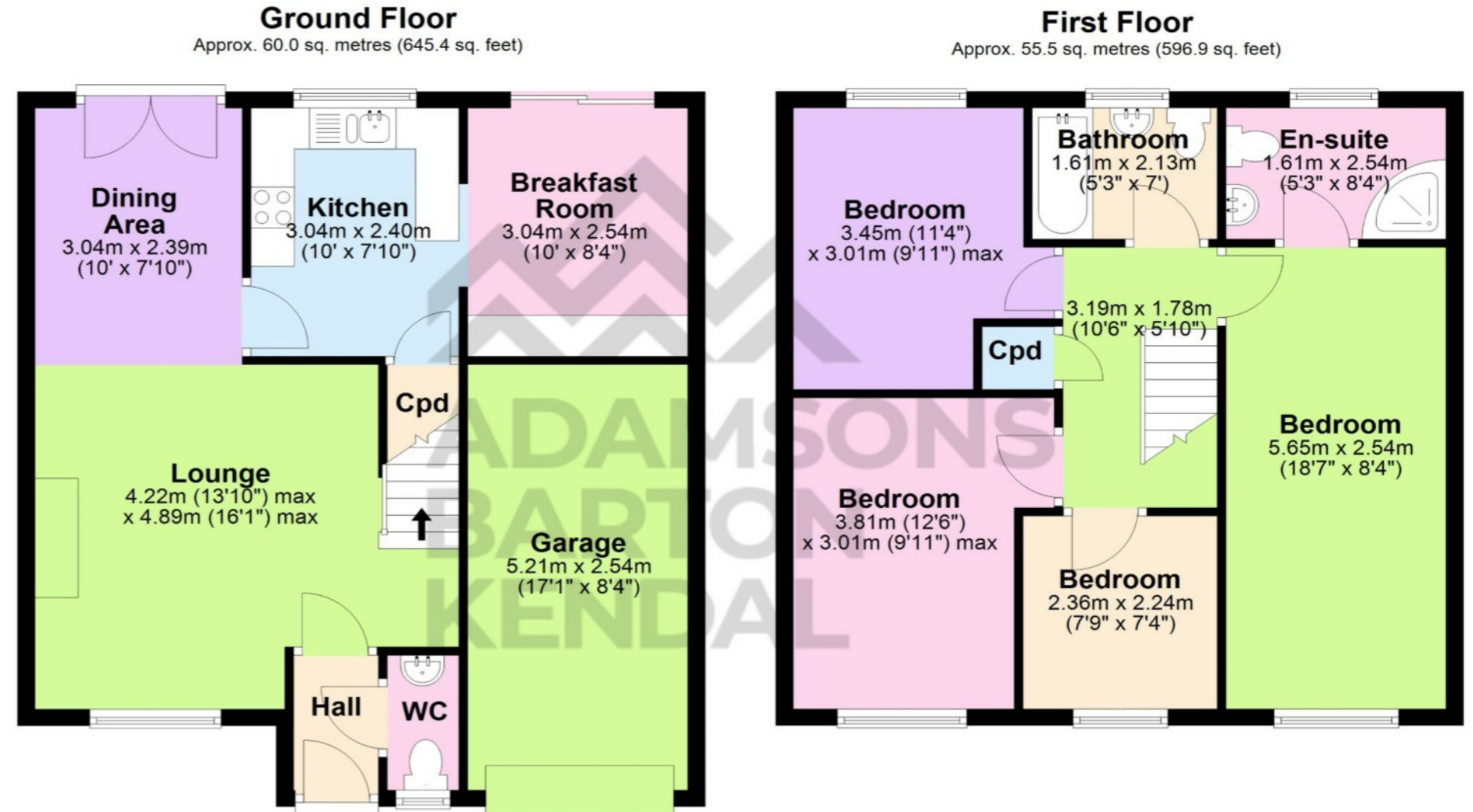

Total area: approx. 115.4 sq. metres (1242.4 sq. feet)

Disclaimer - Whilst every attempt has been made to ensure the accuracy of the floor plan contained here, this plan is for illustrative purposes only and should only be used as such by any prospective purchaser.  
Plan produced using PlanUp.

w - [abkproperty.co.uk](http://abkproperty.co.uk) e - [sales@abkproperty.co.uk](mailto:sales@abkproperty.co.uk)

Adamsons Barton Kendal for themselves and for the vendors or lessors of this property whose agents they are, give notice that (i) the particulars are set out as a general outline only for the guidance of intending purchasers or lessees, and do not constitute, nor constitute part of an offer or contract; (ii) all descriptions, dimensions, references to condition and necessary permission for use and occupation, and other details are given without responsibility and any intending purchasers or tenants should not rely on them as statements or representations of fact but must satisfy themselves by inspection or otherwise as to the correctness of each of them; (iii) no person in the employment of Adamsons Barton Kendal has any authority to make or give any representations or warranty in relation to this property.

Due to a change in the legislation as from 1<sup>st</sup> March 2004 we are required to check your identification. This is a legal requirement and applies to all Estate Agents: (i) proceeding to market any property; and (ii) should you make an offer on one of our properties and this offer becomes acceptable, before we can instruct Solicitors to proceed with the transaction. Suitable identification can be: Current signed Passport; New style Driving Licence with photograph; Inland Revenue Tax notification