



40 School Road, Bulkington

Bedworth

Offers in Region of £630,000



**SHELDON
BOSLEY
KNIGHT**

LAND AND
PROPERTY
PROFESSIONALS

40 School Road

Bulkington, Bedworth

****CHAIN FREE****

Presenting an exceptional opportunity to acquire a five-bedroom detached residence finished to an immaculate standard throughout, this spacious family home offers a wealth of versatile accommodation across multiple floors. The property features a superb gym and a dedicated cinema room, complete with a 100-inch screen and surround sound, ideal for both fitness enthusiasts and those who enjoy entertaining at home. Two modern bathrooms and two additional downstairs toilets provide convenience for larger families or guests. The ground and lower ground floors benefit from Hetta smart underfloor heating, which can be controlled remotely for optimum comfort, while the state-of-the-art Vent Axia MVHR system efficiently draws in filtered external air, extracts internal air, and recovers heat, ensuring a fresh and energy-efficient living environment. The well-appointed utility room adds further practicality, supporting a seamless lifestyle. Off-street parking is available for five to seven cars, offering ample space for residents and visitors alike. The property is situated within easy walking distance of local shops and amenities, making day-to-day living remarkably convenient. Facing a beautiful church, the home enjoys tranquil and picturesque views, providing a sense of peace and serenity. Every detail of this residence has been carefully considered to deliver a modern, luxurious living experience, from the high-quality finishes to the advanced home technology. This outstanding home is perfectly suited to those seeking space, privacy, and comfort in a highly desirable location.

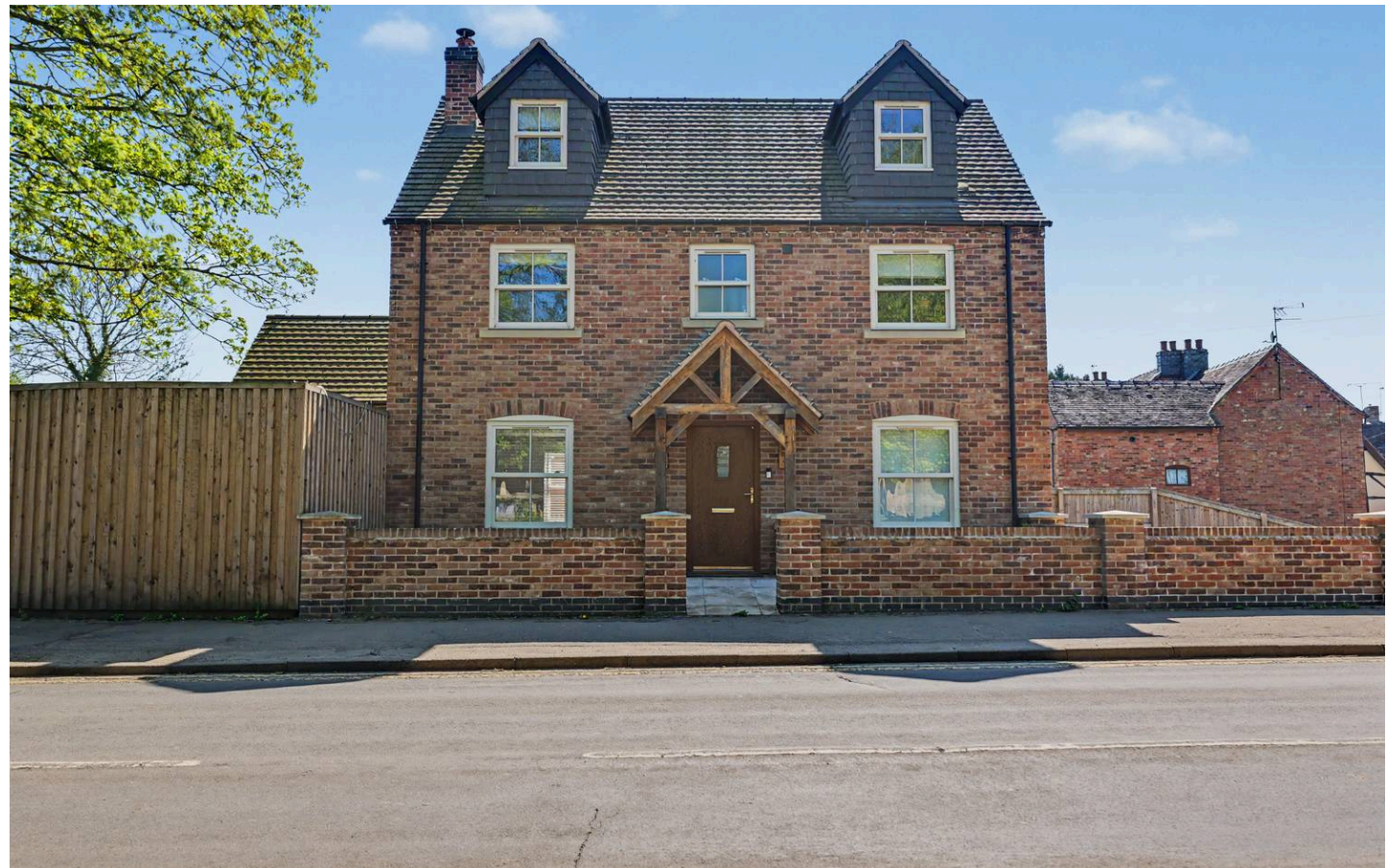



Lower Ground Floor

Approx. 48.5 sq. metres (521.9 sq. feet)

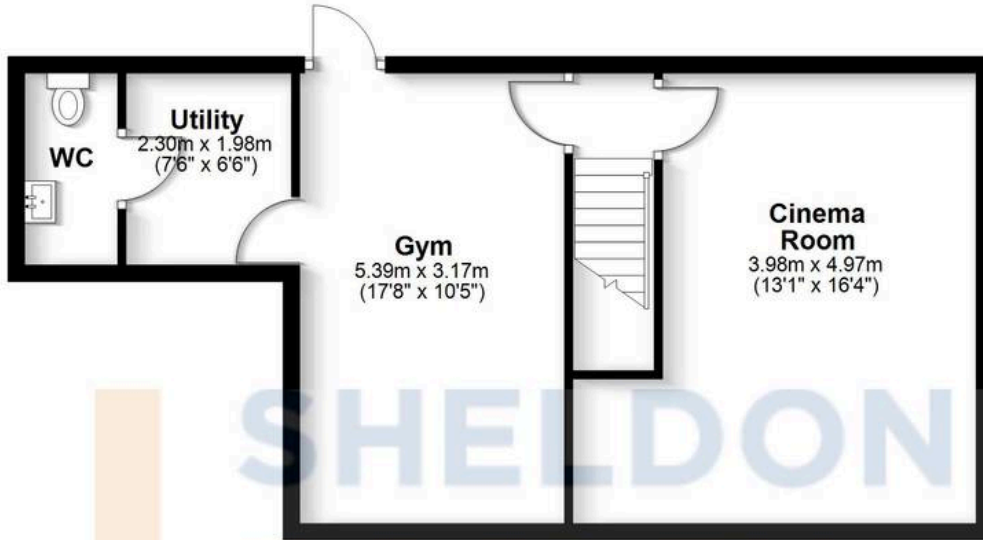

First Floor

Approx. 43.5 sq. metres (468.7 sq. feet)

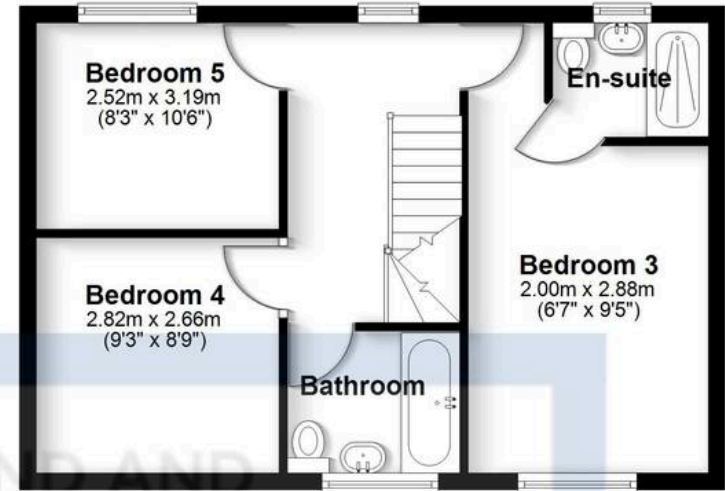

Ground Floor

Approx. 55.2 sq. metres (593.7 sq. feet)

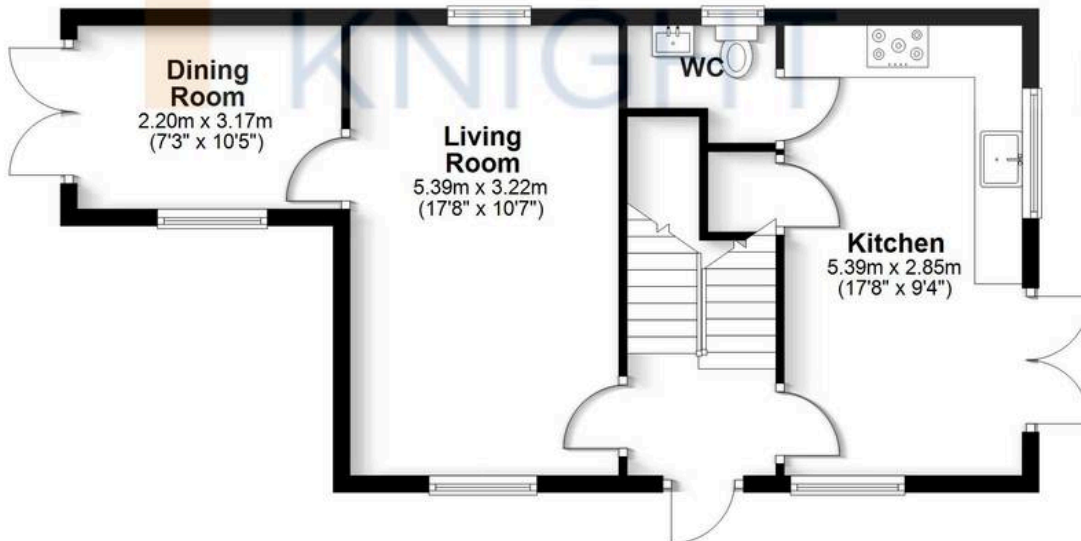

Second Floor

Approx. 37.1 sq. metres (399.2 sq. feet)

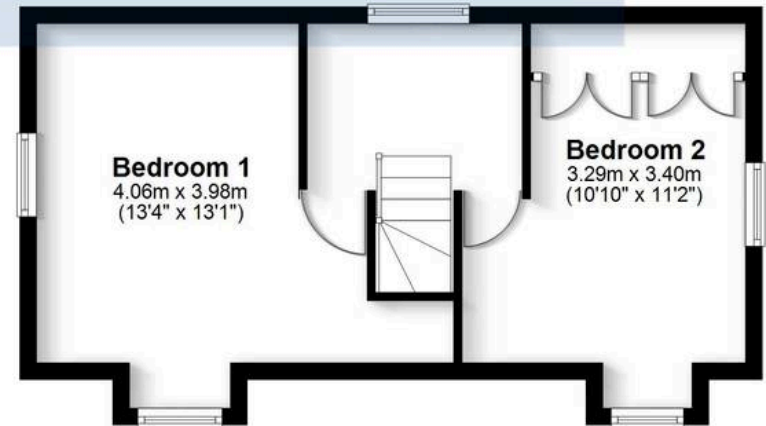

Total area: approx. 184.3 sq. metres (1983.6 sq. feet)

All efforts have been made to ensure the measurements are accurate on this floor plan, however these are for guidance purposes only.
Plan produced using PlanUp.



Sheldon Bosley Knight Nuneaton

Sheldon Bosley Knight, 39 Newdegate Street, Nuneaton - CV11 4ER

02476374949 • nuneaton@sheldonbosleyknight.co.uk • www.sheldonbosleyknight.co.uk/