



**9 Beresford Road**

, Bedford, MK40 3SD

**£475,000**



## Floor Plan

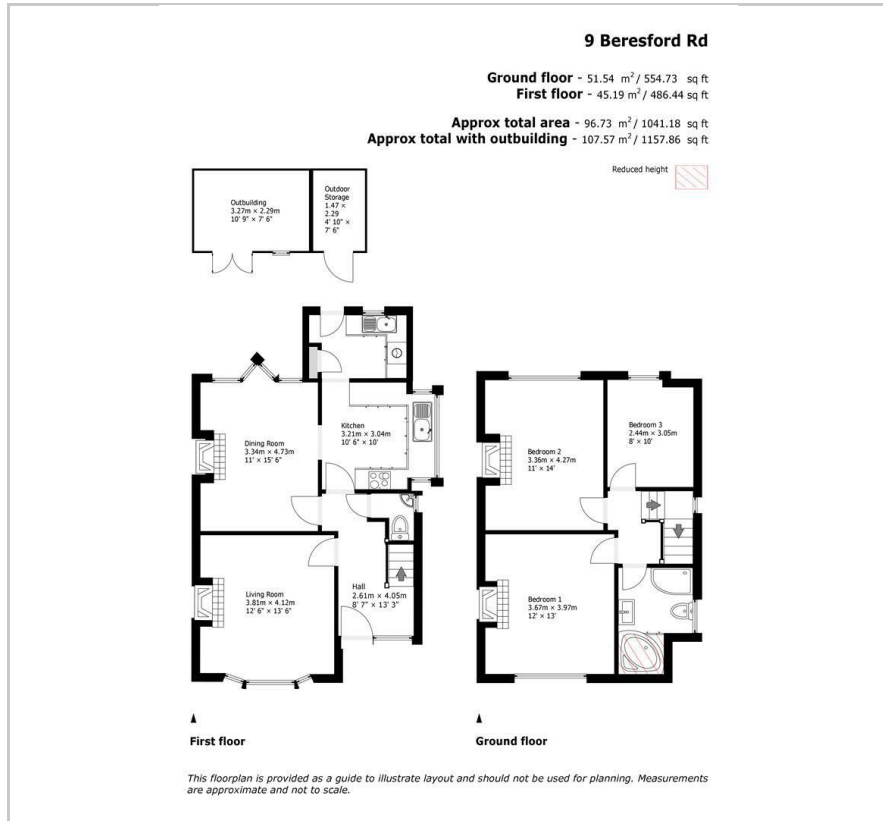

## Area Map

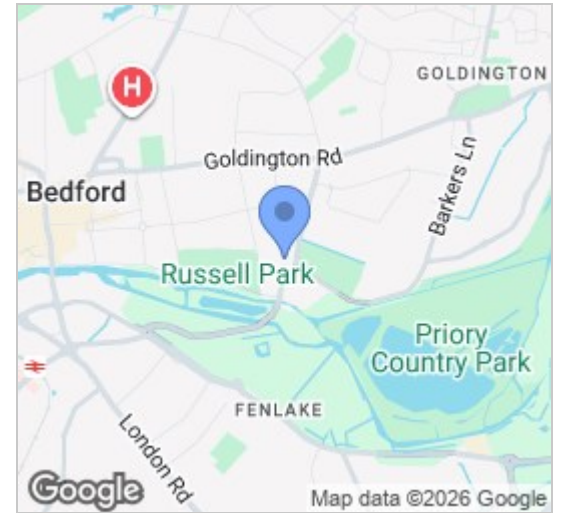

## Energy Efficiency Graph

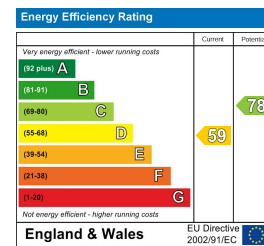

## Viewing

Please contact our Bedford Office on 01234 216612 if you wish to arrange a viewing appointment for this property or require further information.



This distinctive semi detached home occupies a popular position on the edge of the 'Castle Quarter' just a few steps away from The Embankment and provides spacious and adaptable rooms with useful additions such as a utility room and ground floor cloakroom. Improved in recent months, the accommodation includes three good size bedrooms and a cosy self-contained front sitting room with solid fuel burner. The separate dining room connects to the kitchen via an archway to provide an open family space with both rear and side bay windows providing additional natural light. The utility room provides further storage space, the WC is fitted nicely underneath the stairs and the first floor bathroom has a separate shower cubicle. Further features include pull-out under stairs storage, upgraded electrics and gas to radiator heating from a combination boiler as well as double glazed windows throughout. Outside, the enclosed garden has been very well maintained, is walled all around and has a newly-laid patio along with a recently added timber garden building and shed.

Located on the eastern edge of the area, Beresford Road enjoys easy access to many of the town's most popular attractions. In addition to the Embankment, Russell Park is just around the corner as is the choice of specialist shops, cafes and delis along Castle Road. Further nearby facilities include Priory Country Park and a handy Marks & Spencer 'Simply Food'. Bedford town centre is under a mile away and offers a wider choice of shops and restaurants as well as fast rail links into London St Pancras. EER C



**163 Castle Road, MK40 3RT**

**Tel: 01234 216612**

**www.hollandsmith.co.uk**