

£270,000

Forest Close

Mansfield, NG21 0HN

ASHFORD
& MOULT

PROPERTY SUMMARY

NO CHAIN

Located at the end of a quiet cul-de-sac, this individually designed three-bedroom detached home offers spacious and flexible accommodation, together with beautifully maintained private gardens, excellent parking and a garage. Having been well cared for over the years and updated in parts, the property is ready for its next owners to make it their own.

The accommodation begins with a welcoming entrance hall, which offers ample space for a dining area or home office if required. The lounge is bright and comfortable, with large windows allowing plenty of natural light, while a feature fireplace provides a lovely focal point to the room. The kitchen is fitted with a range of modern white units, offering excellent cupboard and worktop space for everyday living.

Also on the ground floor is the family bathroom, along with a well-proportioned third bedroom, which could also be used as a guest room, home office or playroom, depending on individual needs.

To the first floor are two further bedrooms, with the main bedroom benefiting from fitted wardrobes.

3



1



1





BAXI

YORKSHIRE
TEA
LEAF
JOBKSHIRE

Herbs
& Spices

ASHFORD
& MOULT
ESTATE AGENTS





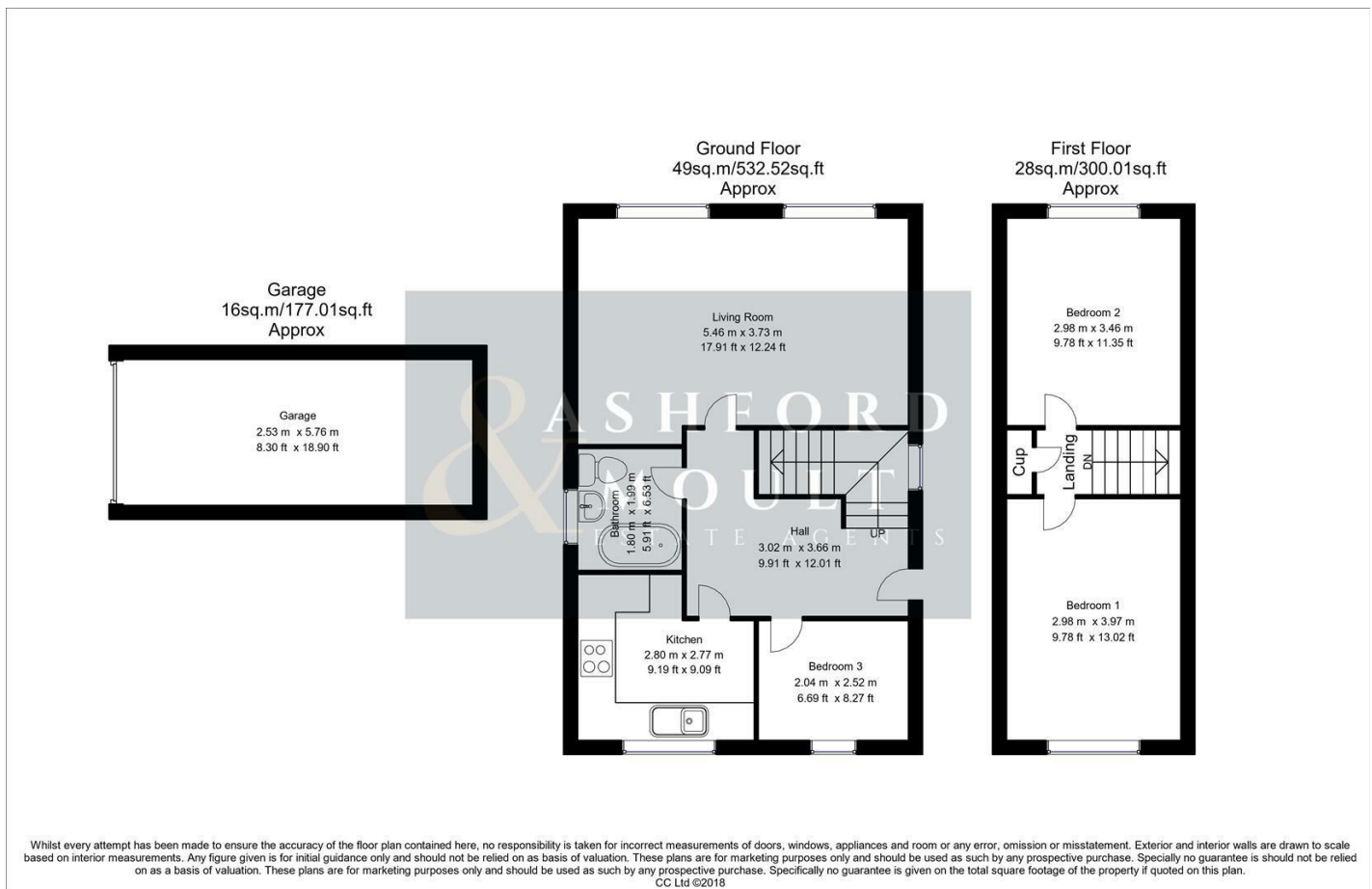

LOCAL AUTHORITY
Newark and Sherwood District Council

TENURE
Freehold

COUNCIL TAX BAND
C

VIEWINGS
By prior appointment only

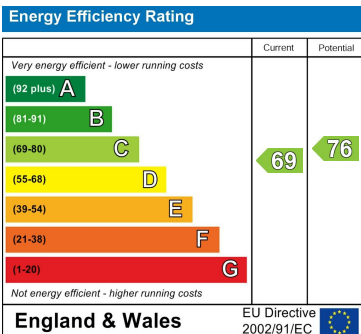

Agents Note: Whilst every care has been taken to prepare these particulars, they are for guidance purposes only. All measurements are approximate and are for general guidance purposes only and whilst every care has been taken to ensure their accuracy, they should not be relied upon and potential buyers/tenants are advised to recheck the measurements

OFFICE ADDRESS

56 Main Street
Calverton
Nottinghamshire
NG14 6FN

OFFICE DETAILS

01158 656675
sales@ashfordandmoult.co.uk