

Barley Close
Bristol BS36 2ED

Price:
£1,650 PCM

Property Features

- Terraced House
- Three/Four Double Bedrooms
- One/Two Reception Rooms
- Modern Kitchen
- UPVC Double Glazing
- Gas Central Heating
- Immaculately Presented
- Available Immediately
- No Pets
- MUST BE VIEWED

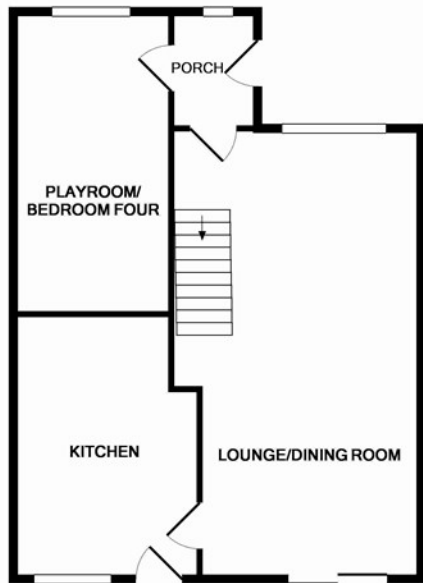

GROUND FLOOR

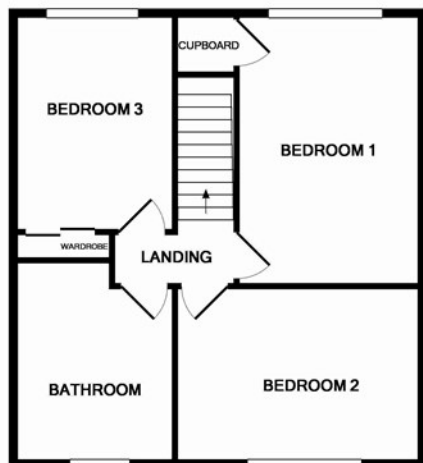

1ST FLOOR

Measurements are approximate. Not to scale. Illustrative purposes only
Made with Metropix ©2018

4 Flaxpits Lane
Winterbourne
Bristol
BS36 1JX

www.aj-homes.co.uk
info@aj-homes.co.uk
01454 252140



Full Description

ENTRANCE HALL

LOUNGE/DINING ROOM 24'5" x 13'3"

KITCHEN 12'3" x 9'8"

PLAY ROOM/BEDROOM FOUR 18'6" x 8'4"

LANDING

BEDROOM ONE 14'9" x 9'11"

BEDROOM TWO 13'3" x 9'5"

BEDROOM THREE 11'7" x 8'3"

BATHROOM

REAR GARDEN

PARKING

Agents Note: Whilst every care has been taken to prepare these sales particulars, they are for guidance purposes only. All measurements are approximate are for general guidance purposes only and whilst every care has been taken to ensure their accuracy, they should not be relied upon and potential buyers are advised to recheck the measurements