



**Bramley Crescent, Bearsted, Maidstone, Kent, ME15 8JZ**

**Price £350,000**



\*\*\* Guide Price £350,000 - £375,000 \*\*\*

This exceptionally well-positioned two bedroom chalet-style residence is located in the sought-after road of Bramley Crescent on the edge of an established residential development in Bearsted.

Accessed via a substantial triple-length driveway alongside a well-tended front garden, you step inside the front door into the inviting entrance hall which leads to a bright and spacious sitting room, a dining room with a staircase leading to the upstairs bedroom, a well-appointed kitchen, and a bathroom with a separate WC. The first floor boasts a generous double bedroom complete with eaves storage.

Externally, a carport covers part of the driveway, while the rear garden is predominantly laid to lawn, offering a high degree of privacy. This delightful outdoor space is enhanced by flower and shrub borders, as well as a patio seating area at the rear, perfect for those who enjoy soaking up the sun.

Madginford offers a variety of amenities, including shops, a library, and schools. The charming village centre of Bearsted, with its historic buildings, green spaces, sports clubs, pubs, restaurants, church, and a London line station, is close by. Mote Park's beautiful grounds are within a few minutes walk, and there's easy access to Maidstone town centre, approximately 3 miles away, via a frequent bus service. Tenure: Freehold. Council Tax Band: D. EPC Rating: Awaited.



**GROUND FLOOR**

Entrance Hall

Lounge

Dining Room

Kitchen

Conservatory/Garden Room

Bedroom 2

Bathroom

Separate Cloakroom

**FIRST FLOOR**

Bedroom 1

**EXTERNALLY**

Large Covered Carport

Gardens

**VIEWING**

Strictly by arrangement with the Agent's Bearsted Office, 132 Ashford Road, Bearsted, Maidstone, Kent ME14 4LX. Tel: 01622 739574.

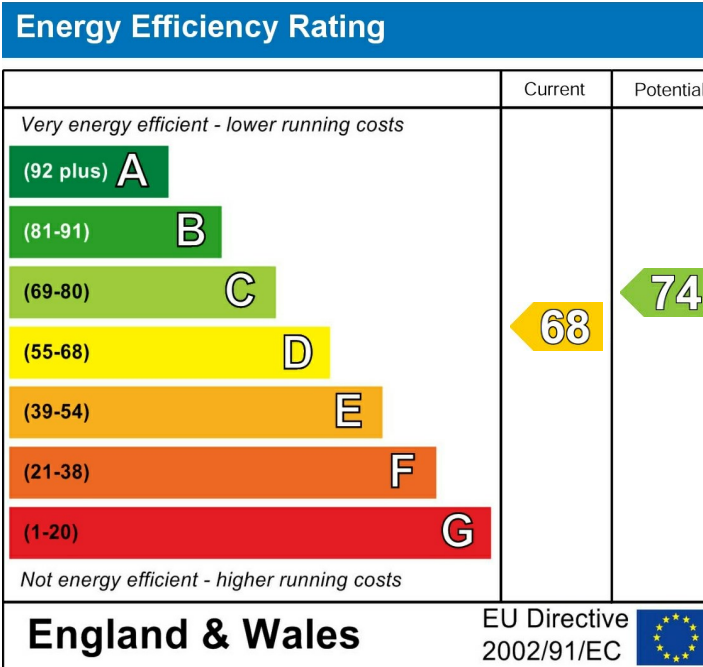

Page & Wells limited for themselves and for the vendors of this property whose agents they are give notice that: 1. These particulars do not constitute any part of, an offer or a contract. 2. All statements contained in these particulars as to this property are made without responsibility on the part of Page & Wells Limited or the Vendor. 3. None of the statements contained in these particulars as to the property is to be relied on as statements or representations of fact. 4. Any intending purchaser must satisfy himself by inspection or otherwise as to the correctness of each of the statements contained in these particulars. 5. The vendor does not make or give, and neither Page & Wells Limited nor any person in their employment has any authority to make or give any representation whatsoever in relation to this property. These particulars are supplied on the understanding that all negotiations are carried out throughout Page & Wells Limited. Properties with a reference prefixes EAA are those which Page & Wells Limited disclose an interest in accordance with the provisions of the Estates Agents Act 1979

## Ground Floor

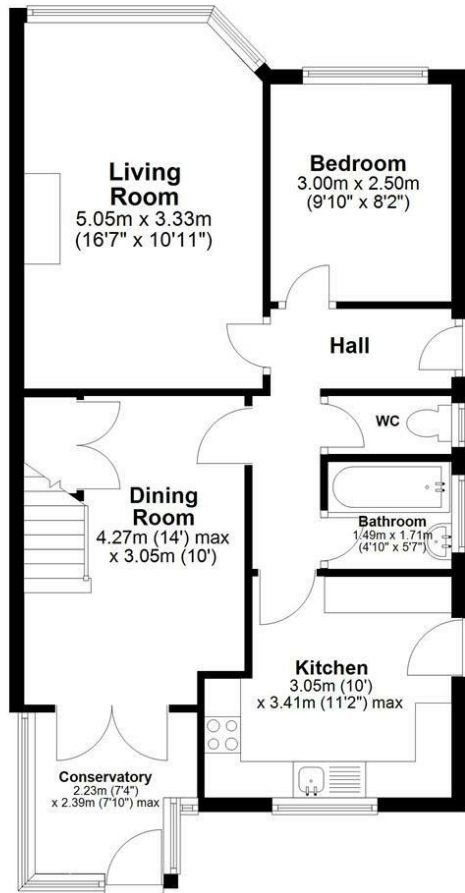

## First Floor

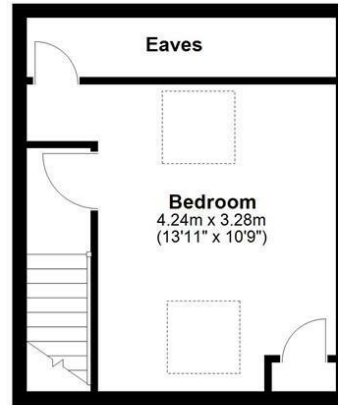

Total area: approx. 81.2 sq. metres (874.0 sq. feet)

