



Exeter Place, SE26

£550,000

Discover modern living in the heart of Sydenham with this beautifully presented new build apartment. Offering two spacious bedrooms and two contemporary bathrooms, the property is thoughtfully designed for comfort and style. A private balcony provides the perfect spot to relax, while the added benefit of allocated parking and excellent nearby transport links make commuting effortless.

Exeter Place enjoys a convenient setting close to Sydenham Station and Sydenham Hill Station, offering excellent transport connections, while also being within easy reach of the green open spaces of Sydenham Wells Park and Crystal Palace Park. Ideally located, it's just a short walk from Sydenham Hill Wood, Crystal Palace, Forest Hill, or Sydenham high street. With direct connections to Victoria and Blackfriars in under 30 minutes, this home is perfectly positioned for both convenience and connectivity.

Features

- New Build
- Two Bedrooms
- Two Bathrooms
- Private Balcony
- Allocated Underground Parking
- Close To Stations

Exeter Place,
London, SE26

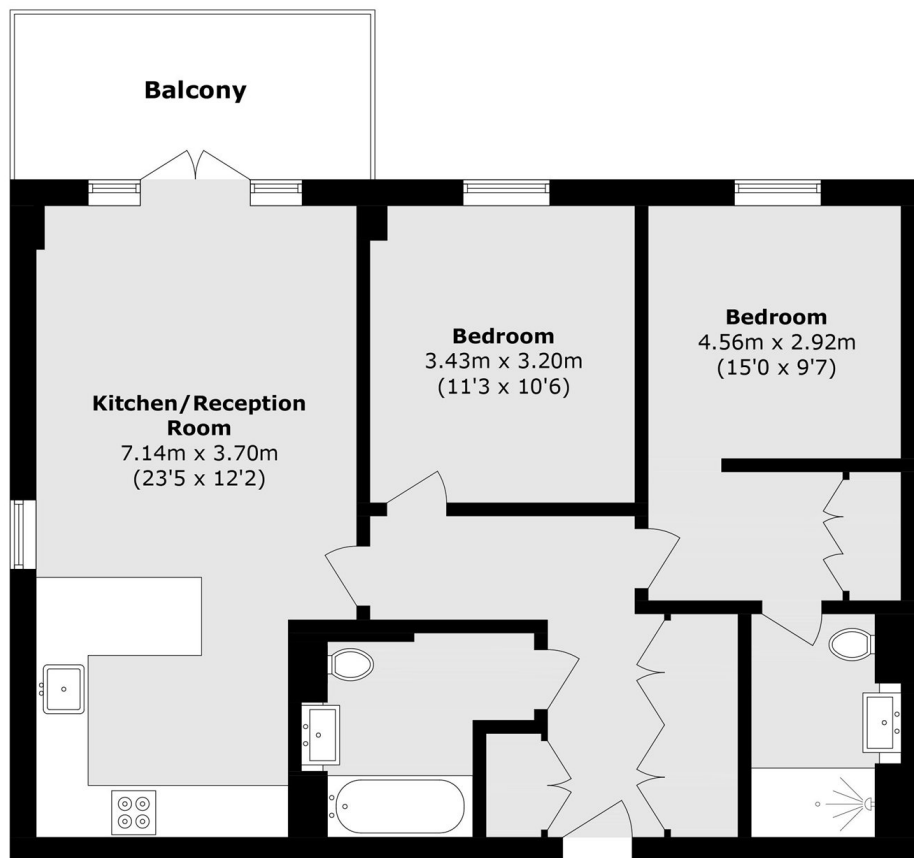

Total area (approx.): 72.7 sq. m (782.5 sq. ft)
Balcony area (approx.): 7.8 sq. m (83.9 sq. ft)