



**patrick
gardner**
RESIDENTIAL

1 Owen Place, Leatherhead, KT22 8JA

Price Guide £500,000



- SUPERB END TERRACE HOUSE
- TWO LARGE BEDROOMS
- MODERN KITCHEN
- SOUGHT AFTER LOCATION
- SHORT WALK TO TOWN

- 1012 SQ.FT.INCL.GGE
- 23'6 SITTING/DINING ROOM
- GARAGE & PARKING
- SOUTH WEST FACING GARDEN
- NO CHAIN

Description

This end-terraced house enjoys a highly convenient location being just a 'stones throw' from the town centre. Set within a small private mews of just 6 houses each property benefits from a single garage and shared visitor parking.

Internally, the ground floor accommodation includes a recently fitted modern kitchen, cloakroom which has space for a washing machine and 23'6 x 12'4 sitting/dining room with double doors to the garden. Upstairs there are two large double bedrooms and bathroom. There is also sizable eaves storage off bedroom two.

Outside, there is a single garage which also allows a further parking space directly in front. Gated side access leads to a lovely rear garden with South West aspect, terrace, lawn and flower beds.

No onward chain.

Tenure	Freehold
EPC	C
Council Tax Band	D

Situation

Located in Leatherhead's conservation area, this property is within a short walk the town centre, Waitrose, Parish Church, Nuffield Health Fitness & Wellbeing Gym and mainline station.

The town offers a wide variety of quality independent restaurants and coffee shops. Within the area there are highly regarded both state and private schools including in Leatherhead St John's School and Downsend School whilst at nearby Mickleham is Box Hill School.

Leatherhead's mainline railway station offers commuter access to London Waterloo & Victoria and access south to Guildford & Dorking. Junction 9 of the M25 at Leatherhead provides access to the national motorway network together with Heathrow and Gatwick Airports.

The general area abounds in Green Belt countryside, much of which is National Trust owned offering plentiful of outdoor activities at Bocketts Farm, Denbies Wine Estate, and Polesden Lacey.



Approximate Gross Internal Area = 81.9 sq m / 881 sq ft
Garage = 12.2 sq m / 131 sq ft
Total = 94.1 sq m / 1012 sq ft

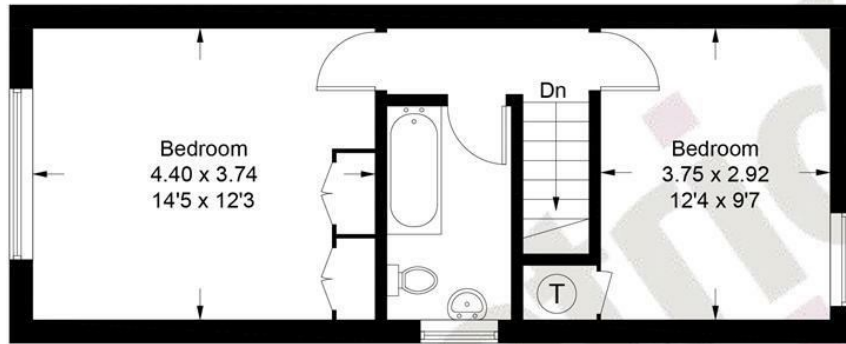

First Floor

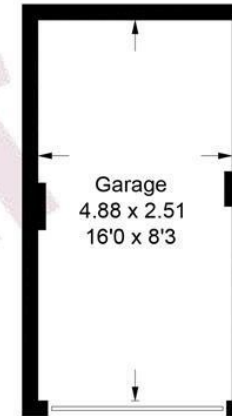

(Not Shown In Actual Location / Orientation)

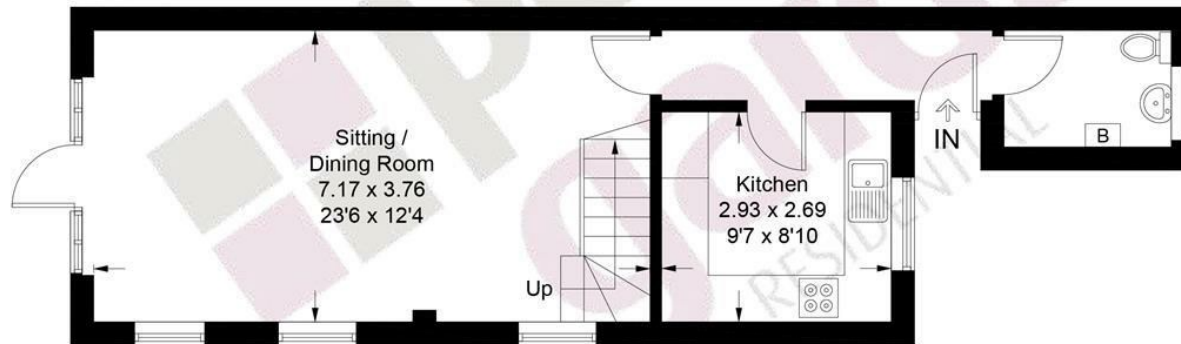

Ground Floor

This plan is for layout guidance only. Not drawn to scale unless stated. Windows and door openings are approximate. Whilst every care is taken in the preparation of this plan, please check all dimensions, shapes and compass bearings before making decisions reliant upon them. (ID1310208)

www.bagshawandhardy.com © 2026

1-3 Church Street, Leatherhead, Surrey, KT22 8DN
Tel: 01372 360078 **Email:** leatherhead@patrickgardner.com
www.patrickgardner.com

These particulars, whilst believed to be accurate are set out as a general outline only for guidance and do not constitute any part of an offer or contract. Intending purchasers should not rely on them as statements of representation of fact, but must satisfy themselves by inspection or otherwise as to their accuracy. No person in this firm's employment has the authority to make or give any representation or warranty in respect of the property.

