

ARENA TOWER, E14

£500,000

This stunning 28th floor one bedroom apartment in Arena Tower with large North-East facing terrace has great views of Canary Wharf, the River Thames and O2. The property is finished to an impeccable standard, featuring sleek oak flooring, a designer kitchen fully integrated with premium Smeg appliances, and a generous double bedroom with built-in storage.

- 24hr Concierge
- Gym, Pool and Cinema
- Service Charge: £4,561
- Ground Rent: £500

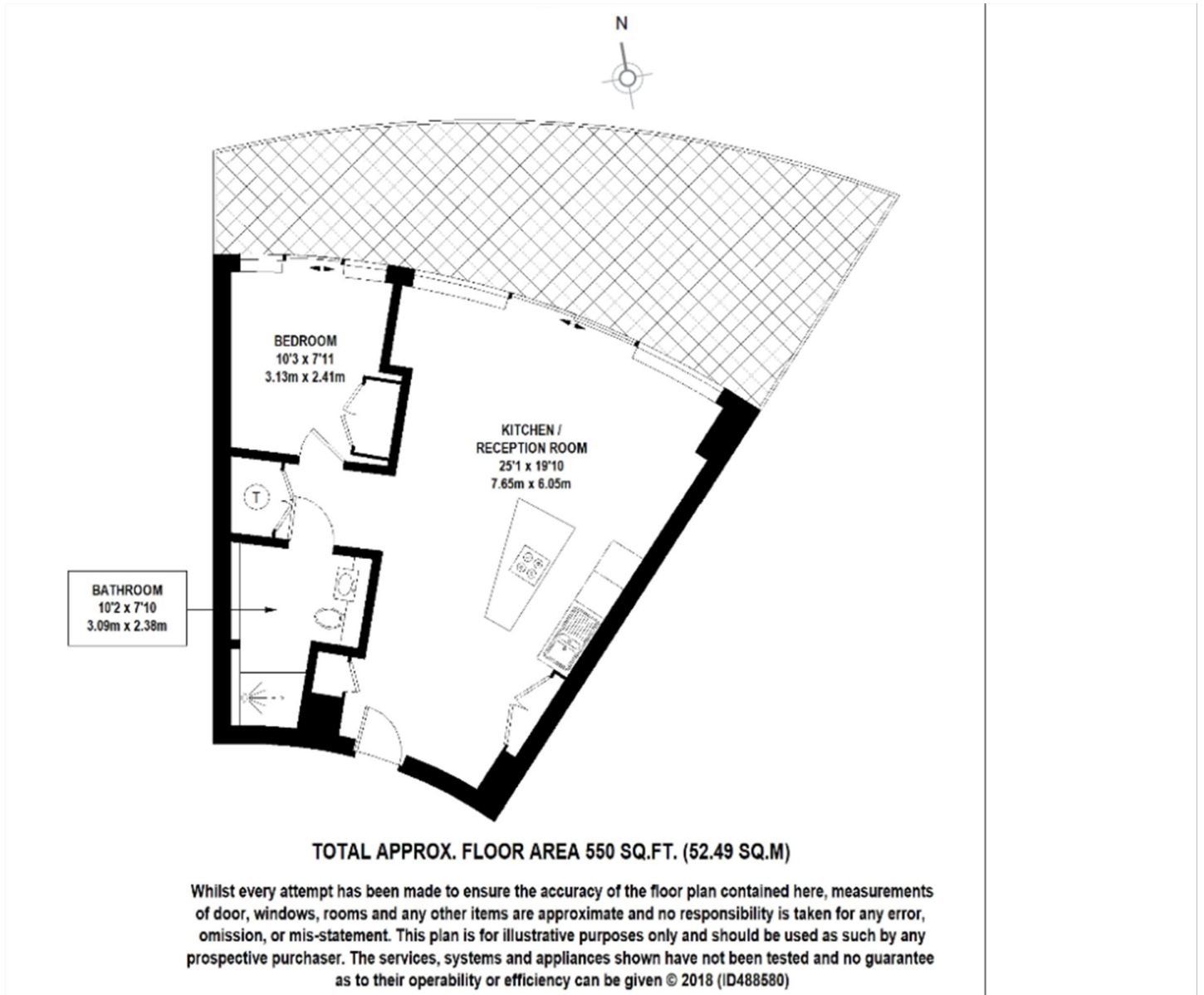

LiFE RESIDENTIAL

36 Millharbour, London, E14

9JS

Sales: 020 3668 1033

Lettings: 020 3668 1030

Energy Rating: B. We aim to make our particulars both accurate and reliable. However they are not guaranteed; nor do they form part of an offer or contract. If you require clarification on any points then please contact us, especially if you're traveling some distance to view. Please note that appliances and heating systems have not been tested and therefore no warranties can be given as to their good working order.