



Property Description

Situated at the end of a quiet cul-de-sac, 5 Priory Close is a well presented three bedroom semi detached home built in the late 1960s, offering generous accommodation and valuable off road parking. The ground floor comprises a welcoming hallway, a spacious kitchen diner and a comfortable lounge. To the first floor there are two double bedrooms, a single bedroom, and a family bathroom, making this an excellent choice for families, first-time buyers, or anyone looking to upsize. Externally, the property enjoys a small front garden, a garage, and a driveway with space for two to three vehicles.

Ground Floor

Approx. 44.8 sq. metres (482.8 sq. feet)

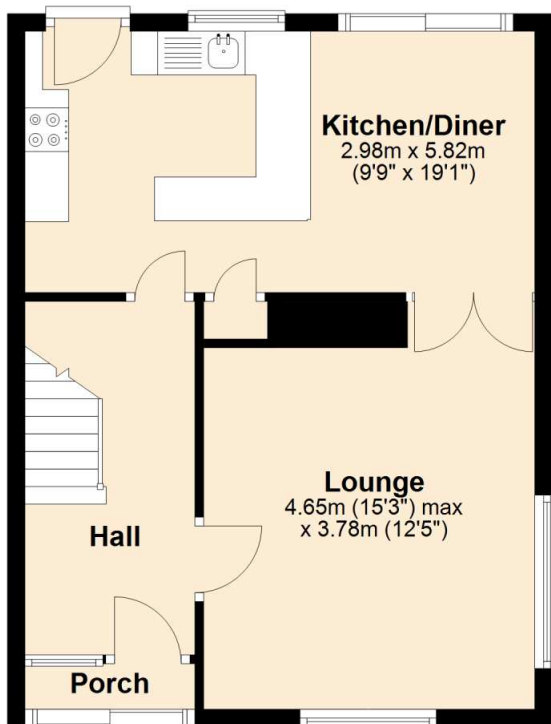

First Floor

Approx. 45.2 sq. metres (486.9 sq. feet)

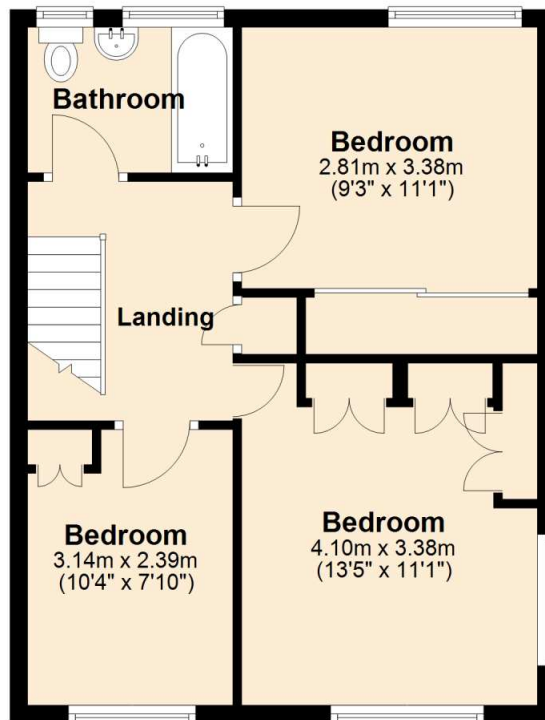

Total area: approx. 90.1 sq. metres (969.7 sq. feet)



Energy performance certificate (EPC)

5 Priory Close Wellington TELFORD TF1 1HZ	Energy rating	Valid until: 23 December 2035
	C	Certificate number: 2575-3957-3202-9885-6204

Property type	Semi-detached house
Total floor area	90 square metres

Rules on letting this property

Properties can be let if they have an energy rating from A to E.

You can read [guidance for landlords on the regulations and exemptions \(https://www.gov.uk/guidance/domestic-private-rented-property-minimum-energy-efficiency-standard-landlord-guidance\)](https://www.gov.uk/guidance/domestic-private-rented-property-minimum-energy-efficiency-standard-landlord-guidance).

Energy rating and score

This property's energy rating is C. It has the potential to be B.

[See how to improve this property's energy efficiency.](#)

The graph shows this property's current and potential energy rating.

Properties get a rating from A (best) to G (worst) and a score. The better the rating and score, the lower your energy bills are likely to be.

For properties in England and Wales:

the average energy rating is D
the average energy score is 60

Score	Energy rating	Current	Potential
92+	A		
81-91	B		82 B
69-80	C	75 C	
55-68	D		
39-54	E		
21-38	F		
1-20	G		

Breakdown of property's energy performance

Features in this property

Features get a rating from very good to very poor, based on how energy efficient they are. Ratings are not based on how well features work or their condition.

Assumed ratings are based on the property's age and type. They are used for features the assessor could not inspect.

Feature	Description	Rating
Wall	Cavity wall, filled cavity	Good
Roof	Pitched, 250 mm loft insulation	Good
Window	Fully double glazed	Poor
Main heating	Boiler and radiators, mains gas	Good
Main heating control	Programmer, room thermostat and TRVs	Good
Hot water	From main system	Good
Lighting	Good lighting efficiency	Good
Floor	Solid, no insulation (assumed)	N/A
Air tightness	(not tested)	N/A
Secondary heating	None	N/A

Primary energy use

The primary energy use for this property per year is 149 kilowatt hours per square metre (kWh/m²).

Smart meters

This property had **no smart meters** when it was assessed.

Smart meters help you understand your energy use and how you could save money. They may help you access better energy deals.

[Find out how to get a smart meter \(https://www.smartenergygb.org/\)](https://www.smartenergygb.org/)

How this affects your energy bills

An average household would need to spend **£954 per year on heating, hot water and lighting** in this property. These costs usually make up the majority of your energy bills.

You could **save £114 per year** if you complete the suggested steps for improving this property's energy rating.

This is **based on average costs in 2025** when this EPC was created. People living at the property may use different amounts of energy for heating, hot water and lighting.

Heating this property

Estimated energy needed in this property is:

- 7,371 kWh per year for heating
 - 2,535 kWh per year for hot water
-

Impact on the environment

This property's environmental impact rating is C. It has the potential to be C.

Properties get a rating from A (best) to G (worst) on how much carbon dioxide (CO₂) they produce each year.

Carbon emissions

An average household produces **6 tonnes of CO₂**

This property produces **2.4 tonnes of CO₂**

This property's potential production **2.0 tonnes of CO₂**

You could improve this property's CO₂ emissions by making the suggested changes. This will help to protect the environment.

These ratings are based on assumptions about average occupancy and energy use. People living at the property may use different amounts of energy.

Steps you could take to save energy

Step	Typical installation cost	Typical yearly saving
1. Floor insulation (solid floor)	£5,000 - £10,000	£60
2. Replacement glazing units	£4,500 - £6,000	£53
3. Solar photovoltaic panels	£8,000 - £10,000	£222

Advice on making energy saving improvements

[Get detailed recommendations and cost estimates \(www.gov.uk/improve-energy-efficiency\)](http://www.gov.uk/improve-energy-efficiency)

Help paying for energy saving improvements

You may be eligible for help with the cost of improvements:

- Heat pumps and biomass boilers: [Boiler Upgrade Scheme \(www.gov.uk/apply-boiler-upgrade-scheme\)](http://www.gov.uk/apply-boiler-upgrade-scheme)

Who to contact about this certificate

Contacting the assessor

If you're unhappy about your property's energy assessment or certificate, you can complain to the assessor who created it.

Assessor's name	Glyn Howells
Telephone	07817773526
Email	glyn@spp-property.co.uk

Contacting the accreditation scheme

If you're still unhappy after contacting the assessor, you should contact the assessor's accreditation scheme.

Accreditation scheme	Elmhurst Energy Systems Ltd
Assessor's ID	EES/029271
Telephone	01455 883 250
Email	enquiries@elmhurstenergy.co.uk

About this assessment

Assessor's declaration	No related party
Date of assessment	23 December 2025
Date of certificate	24 December 2025
Type of assessment	RdSAP

Energy performance certificate (EPC)

5 Priory Close Wellington TELFORD TF1 1HZ	Energy rating	Valid until: 23 December 2035
	C	Certificate number: 2575-3957-3202-9885-6204

Property type	Semi-detached house
Total floor area	90 square metres

Rules on letting this property

Properties can be let if they have an energy rating from A to E.

You can read [guidance for landlords on the regulations and exemptions \(https://www.gov.uk/guidance/domestic-private-rented-property-minimum-energy-efficiency-standard-landlord-guidance\)](https://www.gov.uk/guidance/domestic-private-rented-property-minimum-energy-efficiency-standard-landlord-guidance).

Energy rating and score

This property's energy rating is C. It has the potential to be B.

[See how to improve this property's energy efficiency.](#)

The graph shows this property's current and potential energy rating.

Properties get a rating from A (best) to G (worst) and a score. The better the rating and score, the lower your energy bills are likely to be.

For properties in England and Wales:

the average energy rating is D
the average energy score is 60

Score	Energy rating	Current	Potential
92+	A		
81-91	B		82 B
69-80	C	75 C	
55-68	D		
39-54	E		
21-38	F		
1-20	G		

Breakdown of property's energy performance

Features in this property

Features get a rating from very good to very poor, based on how energy efficient they are. Ratings are not based on how well features work or their condition.

Assumed ratings are based on the property's age and type. They are used for features the assessor could not inspect.

Feature	Description	Rating
Wall	Cavity wall, filled cavity	Good
Roof	Pitched, 250 mm loft insulation	Good
Window	Fully double glazed	Poor
Main heating	Boiler and radiators, mains gas	Good
Main heating control	Programmer, room thermostat and TRVs	Good
Hot water	From main system	Good
Lighting	Good lighting efficiency	Good
Floor	Solid, no insulation (assumed)	N/A
Air tightness	(not tested)	N/A
Secondary heating	None	N/A

Primary energy use

The primary energy use for this property per year is 149 kilowatt hours per square metre (kWh/m²).

Smart meters

This property had **no smart meters** when it was assessed.

Smart meters help you understand your energy use and how you could save money. They may help you access better energy deals.

[Find out how to get a smart meter \(https://www.smartenergygb.org/\)](https://www.smartenergygb.org/)

How this affects your energy bills

An average household would need to spend **£954 per year on heating, hot water and lighting** in this property. These costs usually make up the majority of your energy bills.

You could **save £114 per year** if you complete the suggested steps for improving this property's energy rating.

This is **based on average costs in 2025** when this EPC was created. People living at the property may use different amounts of energy for heating, hot water and lighting.

Heating this property

Estimated energy needed in this property is:

- 7,371 kWh per year for heating
 - 2,535 kWh per year for hot water
-

Impact on the environment

This property's environmental impact rating is C. It has the potential to be C.

Properties get a rating from A (best) to G (worst) on how much carbon dioxide (CO₂) they produce each year.

Carbon emissions

An average household produces **6 tonnes of CO₂**

This property produces **2.4 tonnes of CO₂**

This property's potential production **2.0 tonnes of CO₂**

You could improve this property's CO₂ emissions by making the suggested changes. This will help to protect the environment.

These ratings are based on assumptions about average occupancy and energy use. People living at the property may use different amounts of energy.

Steps you could take to save energy

Step	Typical installation cost	Typical yearly saving
1. Floor insulation (solid floor)	£5,000 - £10,000	£60
2. Replacement glazing units	£4,500 - £6,000	£53
3. Solar photovoltaic panels	£8,000 - £10,000	£222

Advice on making energy saving improvements

[Get detailed recommendations and cost estimates \(www.gov.uk/improve-energy-efficiency\)](http://www.gov.uk/improve-energy-efficiency)

Help paying for energy saving improvements

You may be eligible for help with the cost of improvements:

- Heat pumps and biomass boilers: [Boiler Upgrade Scheme \(www.gov.uk/apply-boiler-upgrade-scheme\)](http://www.gov.uk/apply-boiler-upgrade-scheme)

Who to contact about this certificate

Contacting the assessor

If you're unhappy about your property's energy assessment or certificate, you can complain to the assessor who created it.

Assessor's name	Glyn Howells
Telephone	07817773526
Email	glyn@spp-property.co.uk

Contacting the accreditation scheme

If you're still unhappy after contacting the assessor, you should contact the assessor's accreditation scheme.

Accreditation scheme	Elmhurst Energy Systems Ltd
Assessor's ID	EES/029271
Telephone	01455 883 250
Email	enquiries@elmhurstenergy.co.uk

About this assessment

Assessor's declaration	No related party
Date of assessment	23 December 2025
Date of certificate	24 December 2025
Type of assessment	RdSAP