



**Ballater Road, SW2**

**£550,000**

**Dexters**



## Ballater Road, SW2

A spacious first floor apartment set within an attractive Victorian double fronted building. The property features a generous open-plan kitchen and reception area, recently renovated to include a new kitchen, updated flooring, and double glazed windows, along with two well proportioned double bedrooms and a contemporary family bathroom. Further benefits include a share of freehold, a large loft providing excellent storage, and the property is offered to the market chain free.

Ballater Road is set in a peaceful residential area between Clapham and Brixton, offering convenient access to a wide range of local amenities. Excellent transport links are close at hand, including the Northern and Victoria Underground lines, as well as Overground services.

### Features

- Share of Freehold
- Two Double Bedrooms
- Chain Free
- Double Fronted
- Original Features



# Ballater Road, London, SW2

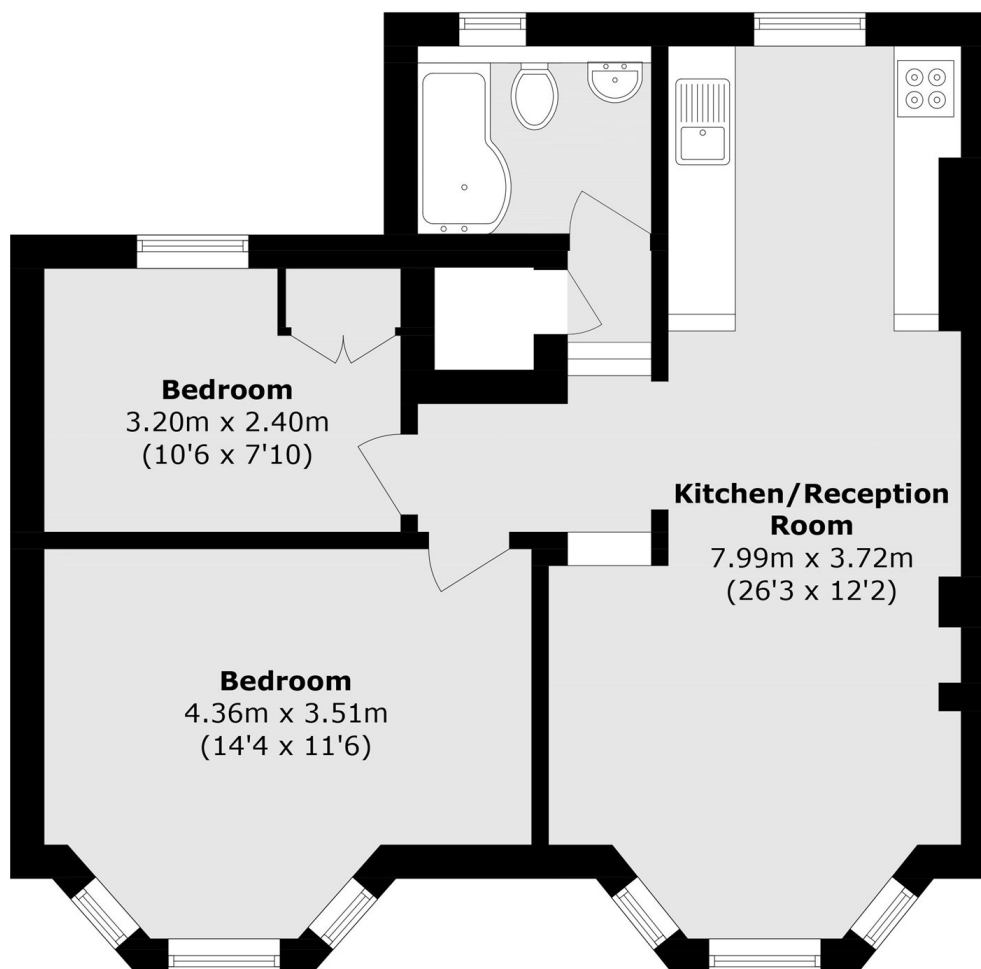

Total area (approx.): 53.2 sq. m (572.6 sq. ft)