



Connells

Braham Crescent
Leavesden WATFORD



Property Description

A superb semi-detached family home located in this sought after development. This prestigious residence boasts numerous features such as the large lounge room overlooking the garden, fitted kitchen, & downstairs WC. On the first floor there are two spacious bedrooms and the family bathroom. On the second floor there is a huge master bedroom and dressing area plus ensuite. There is ample off road parking and a landscaped rear garden. Local sought after schools include Leavesden Green and Alban Wood.

Entrance Hall

Front door.

Cloakroom

WC, wash hand basin.

Kitchen

7' 2" x 10' 10" (2.18m x 3.30m)

Lounge

First Floor Landing

Bedroom 2

14' 7" x 8' (4.45m x 2.44m)



Bedroom 3

14' 7" x 8' 2" (4.45m x 2.49m)

Bathroom

Bath with shower attachment, wash hand basin, WC, extractor fan.

Second Floor

Bedroom 1

14' 6" max x 26' 4" (4.42m max x 8.03m)

Built in wardrobes.

Ensuite

Shower, WC, wash hand basin.

Outside

Front Garden

Paved.

Rear Garden







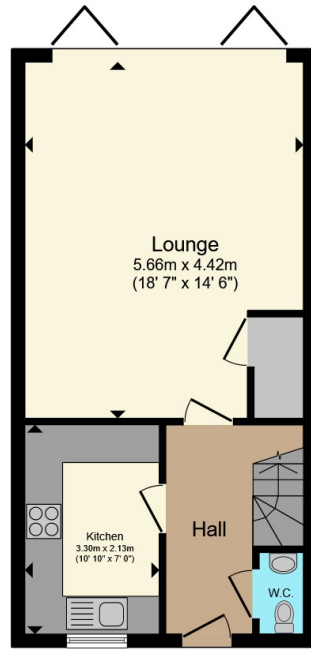

Ground Floor

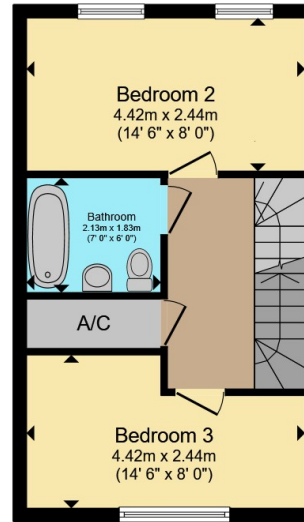

First Floor

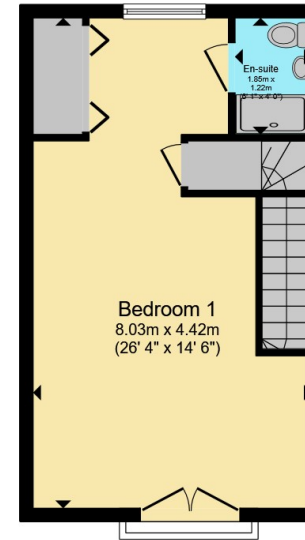

Second Floor

Total floor area 109.1 m² (1,174 sq.ft.) approx

This floor plan is for illustrative purposes only. It is not drawn to scale. Any measurements, floor areas (including any total floor area), openings and orientation are approximate. No details are guaranteed, they cannot be relied upon for any purpose and they do not form part of any agreement. No liability is taken for any error, omission or misstatement. A party must rely upon its own inspection(s). Powered by www.propertybox.io



To view this property please contact Connells on

T 01923 674504

E leavesden@connells.co.uk

1 Cunningham Way Leavesden
Abbots Langley WD25 7NG

EPC Rating: B Council Tax
Band: E

Tenure: Freehold

view this property online connells.co.uk/Property/LEA103610



1. MONEY LAUNDERING REGULATIONS Intending purchasers will be asked to produce identification documentation at a later stage and we would ask for your co-operation in order that there will be no delay in agreeing the sale. 2. These particulars do not constitute part or all of an offer or contract. 3. The measurements indicated are supplied for guidance only and as such must be considered incorrect. Potential buyers are advised to recheck measurements before committing to any expense. 4. We have not tested any apparatus, equipment, fixtures, fittings or services and it is in the buyers interest to check the working condition of any appliances.

Connells Residential is registered in England and Wales under company number 1489613, Registered Office is Cumbria House, 16-20 Hockliffe Street, Leighton Buzzard, Bedfordshire, LU7 1GN. VAT Registration Number is 500 2481 05.

See all our properties at www.connells.co.uk | www.rightmove.co.uk | www.zoopla.co.uk

Property Ref: LEA103610 - 0004