



Hillcourt Road, Romiley, SK6 4QD

A beautifully presented four-bedroom detached family home enjoying a desirable south-facing rear aspect, allowing natural light to stream through the principal living spaces and into the private rear garden. The property enjoys far-reaching views to the rear and offers spacious, well-appointed accommodation including a stylish open-plan kitchen and dining area with adjoining orangery and utility room, a generous living room with two double French doors to Juliet balconies, a separate study, master bedroom with en-suite shower room, 3 further comfortable bedrooms and a modern bathroom ideal for modern family living. The accommodation is presented on split levels and also includes an entrance hall and landings and a.... can't over

Price Guide: £675,000



Cont'd.....: spacious ground floor w.c. Outside, the enclosed garden provides a sunny and secluded setting perfect for relaxing or entertaining, complemented by off-street parking and an integral garage. Tenure: Freehold. Council Tax Band: F. EPC rating: to follow.

ENTRANCE HALL

GROUND FLOOR W.C.

LIVING ROOM

23' 6" x 12' 0" (7.16m x 3.65m)



OFFICE

7' 4" x 5' 1" (2.23m x 1.55m)

OPEN-PLAN DINING ROOM/KITCHEN

23' 6" x 12' 0" (7.16m x 3.65m)



UTILITY ROOM

7' 4" x 6' 4" (2.23m x 1.93m)

ORANGERY

12' 6" x 12' 0" (3.81m x 3.65m)



MASTER BEDROOM

13' 3" x 12' 0" (4.04m x 3.65m)



EN-SUITE SHOWER ROOM

7' 3" x 5' 5" (2.21m x 1.65m)



BEDROOM TWO

12' 8" x 8' 8" (3.86m x 2.64m)

BEDROOM THREE
 13' 7" x 6' 8" (4.14m x 2.03m)



FAMILY BATHROOM
 6' 5" x 6' 4" (1.95m x 1.93m)



BEDROOM FOUR
 7' 7" x 7' 4" (2.31m x 2.23m)



GARAGE
 17' 4" x 8' 4" (5.28m x 2.54m)

OUTSIDE



GROUND AND LOWER FLOORS
 758 sq.ft. (70.5 sq.m.) approx.

UPPER AND 1ST FLOORS
 596 sq.ft. (55.3 sq.m.) approx.

2ND FLOOR
 411 sq.ft. (38.1 sq.m.) approx.

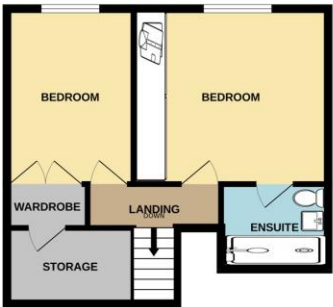

TOTAL FLOOR AREA: 1765 sq.ft. (163.9 sq.m.) approx.
 Whilst every attempt has been made to ensure the accuracy of the floorplan contained here, measurements of doors, windows, rooms and any other items are approximate and no responsibility is taken for any error, omission or mis-statement. This plan is for illustrative purposes only and should be used as such by any prospective purchaser. The services, systems and appliances shown have not been tested and no guarantee as to their operability or efficiency can be given.
 Made with Metropix ©2026



Thomas Lardner Estate Agents, which is a trading name of Romiley Residential Ltd, for themselves and for the vendors or lessors of this property whose agents they are give notice that: (1) all measurements are approximate and any plans provided are not to scale; (2) the particulars are set out as a general outline only for the guidance of intending purchasers or lessors, and do not constitute, nor constitute part of, an offer or contract; (3) we have not tested any apparatus, equipment, fixtures, fittings or services, and so cannot verify that they are in working order or fit for purpose; (4) solicitors should confirm moveable items described in these particulars are, in fact, included in the sale since circumstances change during marketing or negotiations.

T709 Printed by Ravensworth 01670 713330



Thomas Lardner Estate Agents
 4 The Precinct, Romiley, Stockport, Cheshire SK6 4EA
 0161 494 5136
 enquiries@thomaslardner.com
www.thomaslardner.com