



## Westdown Road, SE6

£460,000

A beautifully presented three bedroom period maisonette, offered chain free with a long lease and its own private garden. Blending character and charm with stylish interiors, this is a fantastic opportunity for first-time buyers or investors alike.

Westdown Road is well connected, with Catford, Catford Bridge, Crofton Park and Honor Oak Park railway station all within easy reach, providing convenient links across London. The area is also close to Ladywell Fields and Blythe Hill Fields, offering excellent green spaces for walking, recreation and outdoor leisure. Residents benefit from a wide range of nearby local shops, cafés, supermarkets and everyday amenities, making it a convenient and well-served place to live.

### Features

Period Maisonette  
Three Bedrooms  
Well Presented Throughout  
Long Lease  
Private Garden  
Chain Free

Westdown Road,  
London, SE6

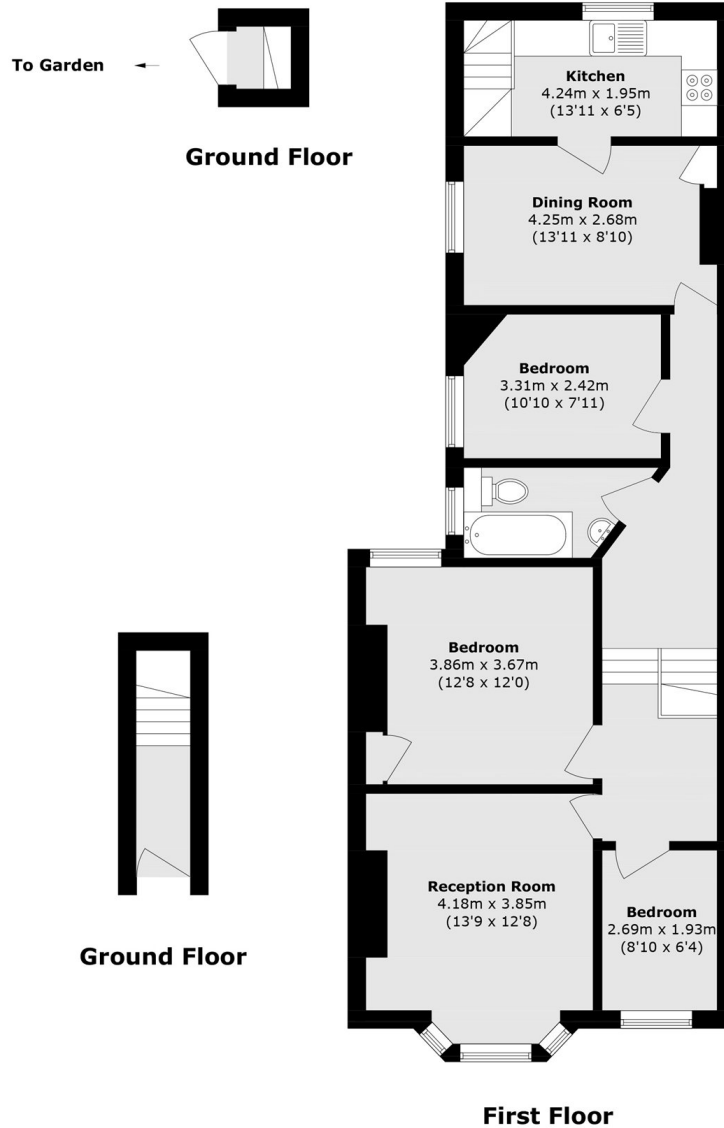

Total area (approx.): 88.2 sq. m (949.3 sq. ft)