



Gloucester Terrace  
Bayswater, W2









This refurbished two-bedroom flat extends to approximately 700 sq ft and is situated on the second floor of an attractive period stucco-fronted building, served by a lift. The apartment is presented in excellent condition throughout, featuring elegant herringbone wood flooring and well-proportioned accommodation. The lease is in the process of being extended to 999 years, providing long-term security for an incoming purchaser. Ideally located on Gloucester Terrace, the property is moments from Hyde Park and benefits from exceptional transport connections via Paddington Station, including Heathrow Express and multiple Underground lines.

- Refurbished throughout
- Two bedrooms
- 700 sq ft
- Second floor
- Lift access
- Period stucco building
- Herringbone wood floors
- 999-year lease
- Close to Hyde Park
- Paddington Station nearby

Asking Price £825,000

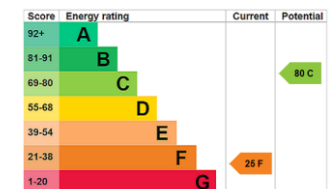

**Tenure:** Leasehold 999 years  
**Service Charge:** £6,315 per annum  
**Ground Rent:** None  
**Local Authority:** City of Westminster  
**Council Tax Band:** E

*Chestertons Hyde Park & Marylebone Sales*

40 Connaught Street  
 London  
 W2 2AB

hydepark@chestertons.co.uk  
 020 7298 5900  
[chestertons.co.uk](http://chestertons.co.uk)

## Gloucester Terrace, W2

○ - Ceiling Height

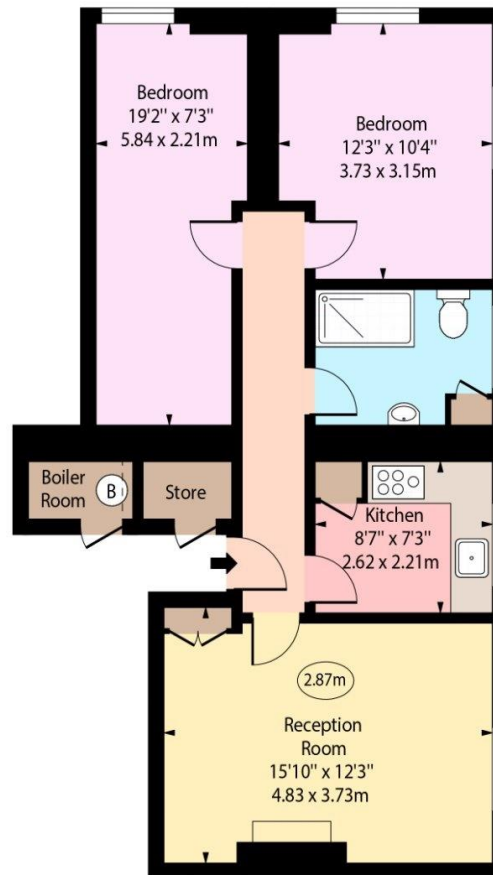

Second Floor

Approx Gross Internal Area      660 Sq Ft - 61.31 Sq M  
(Excluding Boiler Room & Store)

Approx Gross Internal Area      700 Sq Ft - 65.03 Sq M  
(Including Boiler Room & Store)

Every attempt has been made to ensure the accuracy of the floor plan shown.  
However, all measurements, fixtures, fittings, and data shown are approximate interpretations and  
for illustrative purposes only. Measured according to the RICS. Not To Scale.

[www.goldlens.co.uk](http://www.goldlens.co.uk)

Ref. No. 030158E

Chesterton UK Services Limited trading as Chestertons for themselves and for the vendor of this property whose agents they are, give notice that (i) these particulars do not constitute any part of an offer or contract, (ii) all statements contained within these particulars are made without responsibility on the part of Chestertons or the vendor, (iii) whilst made in good faith, none of the statements contained within these particulars are to be relied upon as a statement or representation of fact, (iv) any intending purchasers must satisfy themselves by inspection or otherwise as to the correctness of each of the statements contained within these particulars, (v) the vendor does not make or give either Chestertons or any person in their employment any authority to make or give representation or warranty whatsoever in relation to this property. Wide angle lenses may be used. ©Copyright Chestertons | Chesterton UK Services Limited | Registered Office 40 Connaught Street, Hyde Park, London W2 2AB Registered Company Number 05334580.



This paper is  
100% recyclable