



**CHENSITON GARDENS W8**  
**£1,600 PER MONTH** AVAILABLE 01/07/2026

**Hamptons**

THE HOME EXPERTS

# { THE PARTICULARS

Chensiton Gardens W8

£1,600 Per Month  
Furnished

 1 Bathroom  
 1 Reception

## Features

- Large Studio, - Separate Kitchen, - Large Window, - Prime location, - Furnished, - Close to transport links

## Council Tax

Council Tax Band A

Hamptons  
8 Hornton Street  
Kensington, London, W8 4NW  
020 7937 9372  
KensingtonLettings@hamptons.co.uk  
www.hamptons.co.uk

# { A STUDIO APARTMENT MOMENTS FROM HIGH STREET KENSINGTON

## The Property

A bright and well presented studio apartment located on the 1st floor of this period conversion in the heart of Kensington. The apartment offers a good size studio room with an adjoining separate kitchen and separate modern bathroom. Located moments from High Street Kensington benefiting from eateries, cafes and transport facilities. Offered furnished.

## Location

Chensiton Gardens is a highly sought after street located moments from the amenities of Kensington High Street (District and Circle lines).



# CHENISTON GARDENS

Approximate Gross Internal Area = 187 sq. ft. (17.4 sq. m.)

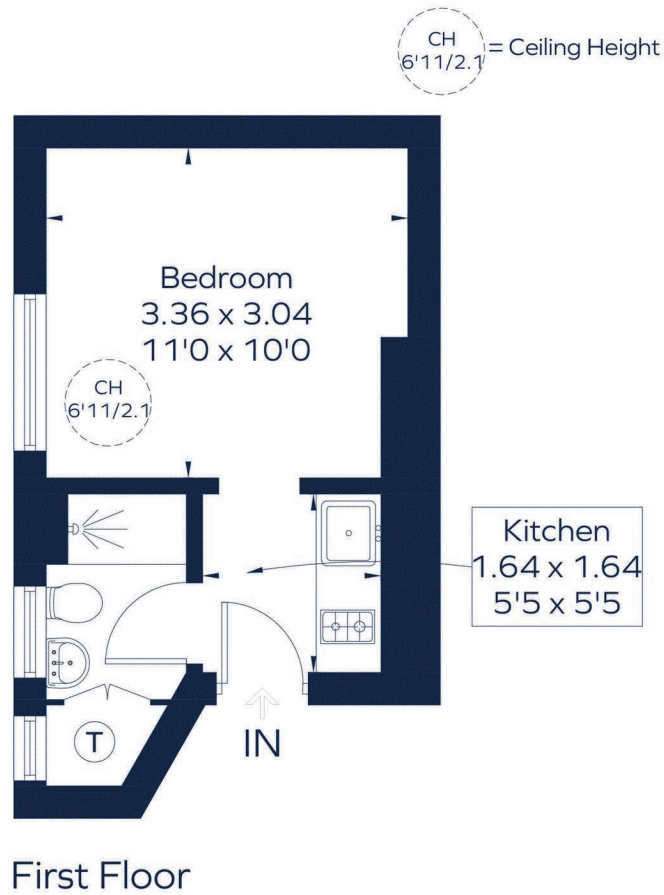

This plan is for layout guidance only. Not drawn to scale unless stated. Windows and door openings are approximate. Whilst every care is taken in the preparation of this plan, please check all dimensions, shapes and compass bearings before making any decisions reliant upon them.  
ID 1257507

#### For Clarification

We wish to inform prospective tenants that we have prepared these particulars as a general guide and they have been confirmed as accurate by the landlord. We have not verified permissions, nor carried out a survey, tested the services, appliances and specific fittings. Room sizes are approximate and measurement figures rounded: they are taken between internal wall surfaces and therefore include cupboards/shelves, etc. Accordingly, they should not be relied upon for

carpets and furnishings. It should also be noted that all fixtures and fittings, carpeted, curtains/blinds, kitchen equipment and garden statuary, whether fitted or not, are deemed removable by the landlord unless specifically itemised with these particulars. Please enquire in office or on our website for details on holding deposit and tenancy deposit figures.

