



ISLINGTON PROPERTIES



## Green Lanes

Stoke Newington, N16

£2,450 Per Month

£2,826 Deposit

Available from: 9th June 2026

This well presented and amply proportioned two bedroom flat occupies the second floor of an imposing converted Victorian house in Stoke Newington, moments from Clissold Park and within easy reach of the bars and restaurants of Stoke Newington Church Street. The flat offers well laid out accommodation and excellent transport links are provided by buses on Green Lanes, with Canonbury overground station and Arsenal underground station both within easy reach.

- Bright and Airy
- Two Double Bedrooms
- Superb Location
- Good Transport Links
- Close to Clissold Park
- Fully Fitted Kitchen
- Elegant Reception Room
- Council Tax: Band D

### Viewing

Please contact our Upper Street Office on 020 7871 4444 if you wish to arrange a viewing appointment for this property or require further information.



2



1



1

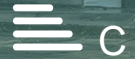

C

## Additional information

Heating: Gas Central Heating

Electricity Supply: Mains

Water Supply: Mains

Sewerage: Mains

Broadband Availability: Predicted Standard, Ultrafast speeds (Ofcom)

Mobile Signal: Predicted likely good indoor and outdoor coverage for Vodafone, O2, Three. Good outdoor coverage only for EE (Ofcom)

Parking: Street parking via permit from local council

## Floor Plan

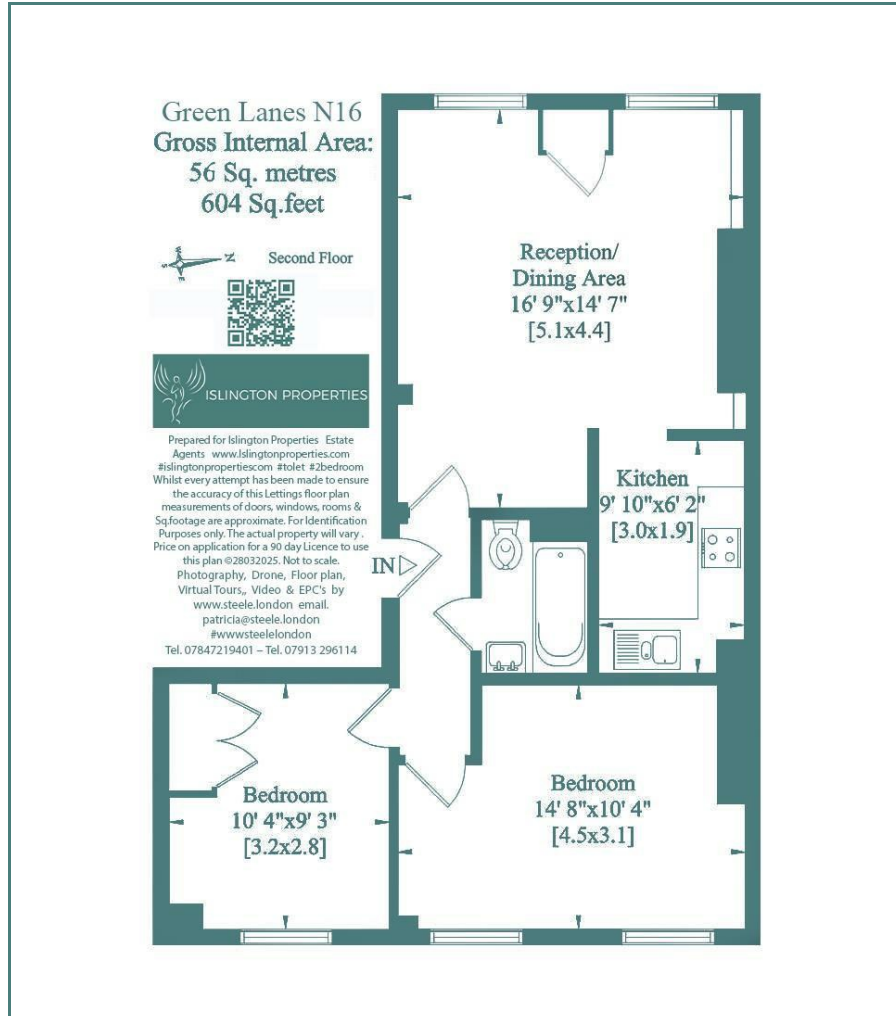

## Area Map



## Energy Efficiency Graph

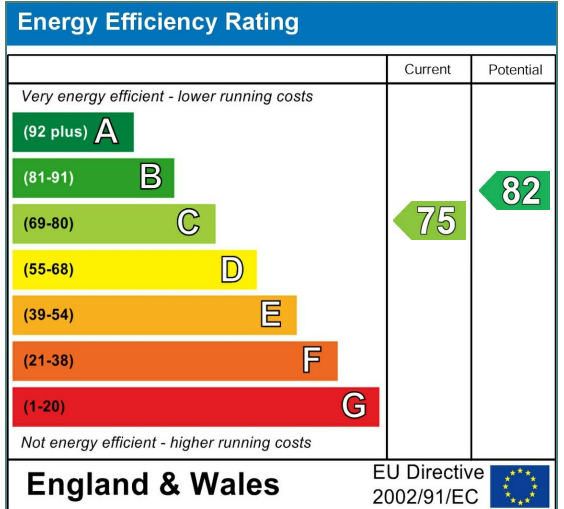

These particulars, whilst believed to be accurate are set out as a general outline only for guidance and do not constitute any part of an offer or contract. Intending purchasers should not rely on them as statements of representation of fact, but must satisfy themselves by inspection or otherwise as to their accuracy. No person in this firm's employment has the authority to make or give any representation or warranty in respect of the property. Council Tax and tenancy information should be confirmed with the Lettings Manager prior to the signature of the tenancy agreement.