



Moor View Holiday Park, Modbury

Guide Price £90,000

3 1 1



- Spacious holiday lodge
- Light and airy lounge diner
- Well-equipped kitchen with side access
- Shower room & separate WC
- Convenient access to Modbury, Ivybridge & wider South Hams
- Peaceful and well-regarded Moor View Park
- Full-width conservatory offering additional reception space
- Three bedrooms (main with fitted wardrobes)
- Generous low-maintenance outdoor space and shed/workshop
- Perfect retreat in the South Hams



A spacious three-bedroom lodge set within a peaceful and sought-after park on the edge of Modbury. Offering a bright lounge/diner, a full-width conservatory, a well-equipped kitchen, a modern shower room, and low-maintenance outdoor space, this property provides comfortable living with great access to amenities and the South Hams.

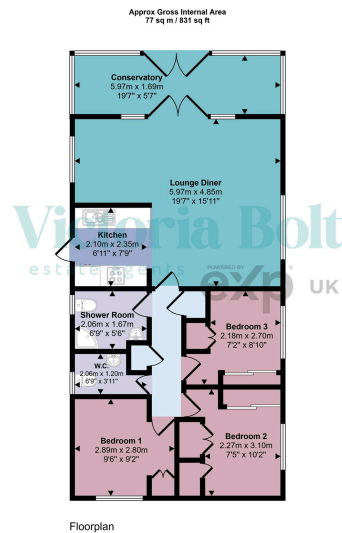

The floorplan is only for illustrative purposes and is not to scale. Measurements of rooms, doors, windows, and any items are approximate and no responsibility is taken for any error, omission or mis-statement. Icons of items such as bathroom suites are representations only and may not look like the real items. Made with Magic Shippy 360.

