



**11, Montrose Place, Gains Park, Shrewsbury, SY3 5EN**

£650 Per Month



11, Montrose Place, Gains Park, Shrewsbury, SY3 5EN

**£650 Per Month**

VIRTUAL TOUR AVAILABLE - A neatly presented and improved one bedroom terraced house, benefiting from private parking and rear garden, situated within this popular residential area, a short distance from Bicton Heath's excellent range of amenities, road links via the bypass and just ten minutes from the town centre.

Available: 16/07/2026

## Description

Comprising: living area, kitchen/dining room with integrated oven/hob and space for washer/dryer and fridge freezer, bedroom, shower room, uPVC double glazed windows, gas fired central heating, garden with shed, allocated parking space. EPC D.



Unfurnished

Council Tax Band: A

Available: 16th July 2026

EPC: D

## Floor Plans

### Ground Floor

Approx. 24.7 sq. metres (266.4 sq. feet)

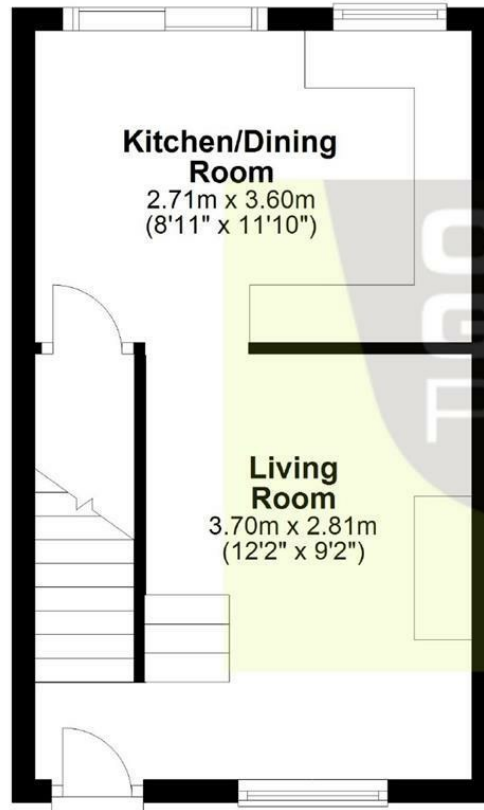

### First Floor

Approx. 19.0 sq. metres (204.6 sq. feet)



Total area: approx. 43.7 sq. metres (470.9 sq. feet)

We accept no responsibility for any mistake or inaccuracy contained within the floorplan. The floorplan is provided as a guide only and should be taken as an illustration only. The measurements, contents and positioning are approximations only and provided as a guidance tool and not an exact replication of the property.  
Plan produced using PlanUp.

These particulars, whilst believed to be accurate are set out as a general outline only for guidance and do not constitute any part of an offer or contract. Intending purchasers should not rely on them as statements of representation of fact, but must satisfy themselves by inspection or otherwise as to their accuracy. No person in this firm's employment has the authority to make or give any representation or warranty in respect of the property.