



12 Old Hall Gardens, Shirley

Solihull

Offers Over **£190,000**

12 Old Hall Gardens

Shirley, Solihull

We are pleased to present this well-maintained and spacious two-bedroom first-floor apartment, ideally located in the highly desirable area of Monkspath, Solihull.

Council Tax band: D

Tenure: Leasehold

EPC Energy Efficiency Rating: C

EPC Environmental Impact Rating: B

- Prime Location
- Two Well-Proportioned Bedrooms
- Private Entrance
- Spacious Lounge
- Modern Bathroom
- Separate Kitchen
- Allocated Parking Space
- Tastefully Presented & Well Maintained
- Quiet Residential Setting
- Appeals to a Range of Buyers





Old Hall Gardens, Shirley

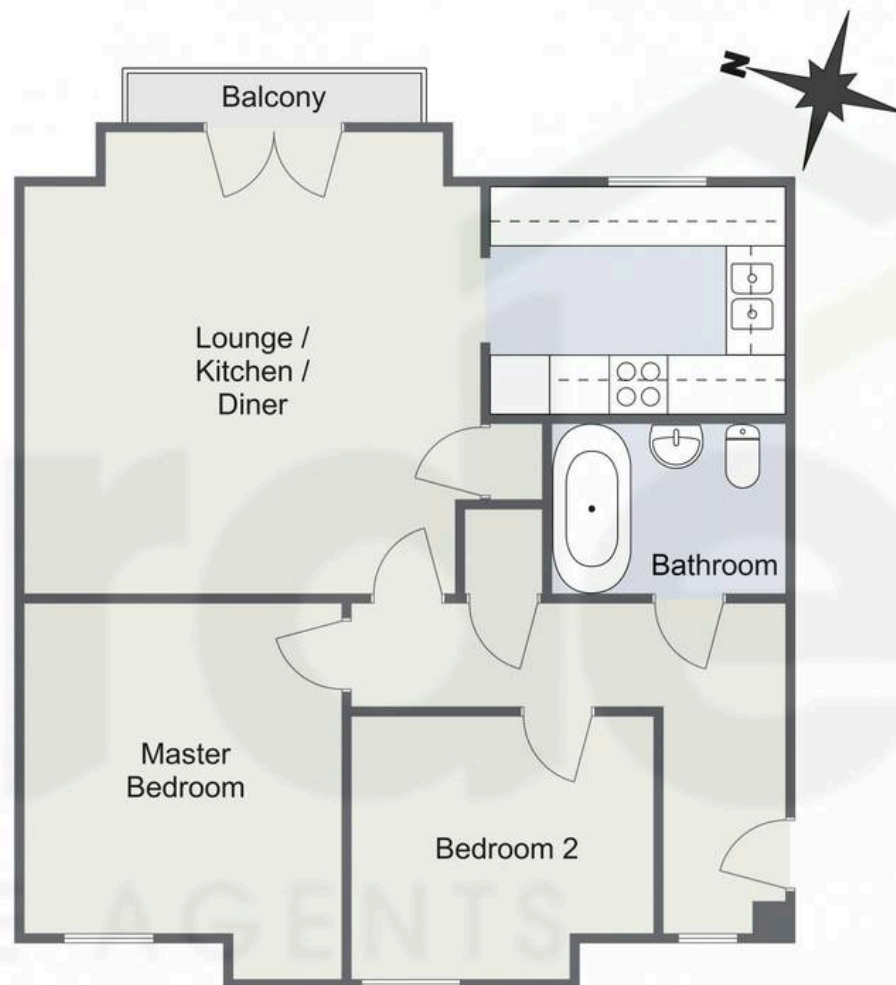

Total Area Approx
63.5 Sq M
683.5 Sq Ft

For illustrative purposes only. Decorative finishes, fixtures & fittings do not represent the current state of the property. Measurements are approximate & not to scale.
Floor Plans made using RoomSketcher.