

Guest Street, Leigh, WN7 2HW
£1,150 PCM

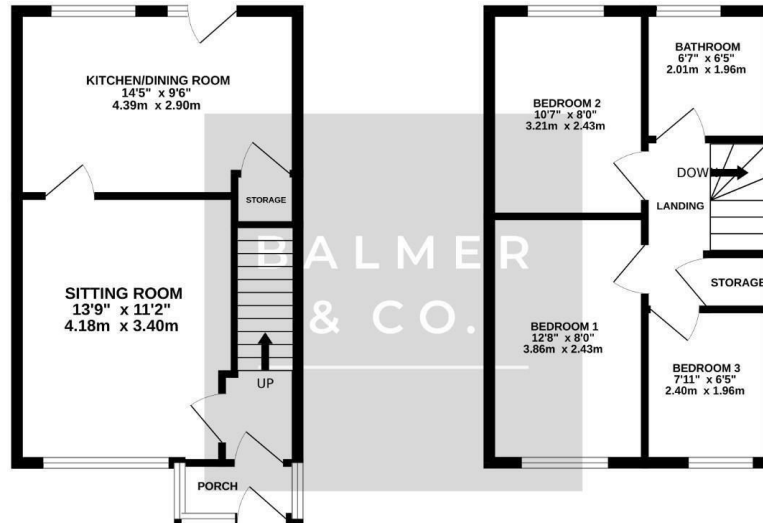

BALMER & CO are delighted to offer TO RENT this three bedroom semi detached property. Ground floor accommodation comprises in brief, entrance porch and hallway with stairs rising to first floor, sitting room with feature fireplace, and kitchen dining room. To the first floor are three well proportioned bedrooms, master with fitted wardrobes, and bathroom. Outside are low maintenance gardens with a driveway to side, providing off road parking.

Floor Plan



TOTAL FLOOR AREA: 685 sq ft. (63.7 sq m.) approx.
 Whilst every attempt has been made to ensure the accuracy of the floorplan contained here, measurements of doors, windows, rooms and any other items are approximate and no responsibility is taken for any error, omission or mis-statement. This plan is for guidance purposes only and should be used as such by any prospective purchaser. The services, systems and appliances shown have not been tested and no guarantee as to their operability or efficiency can be given.
 Made with Floorplan 3.0.2023

Area Map

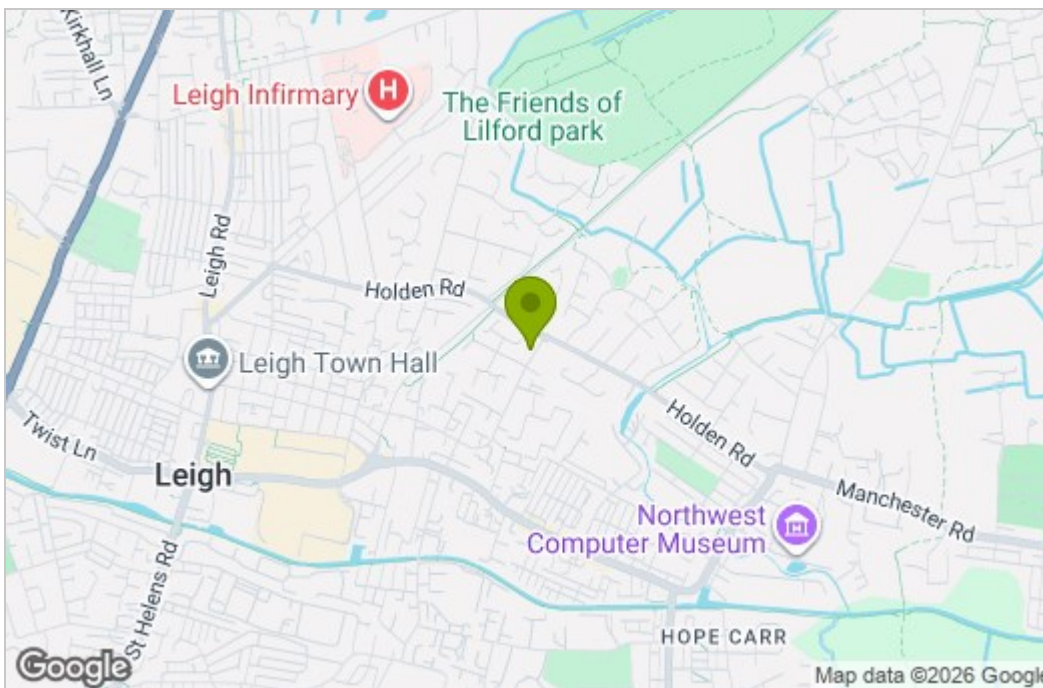

Energy Efficiency Graph

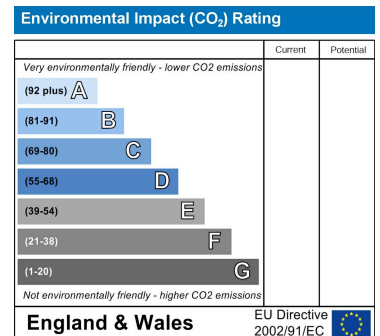
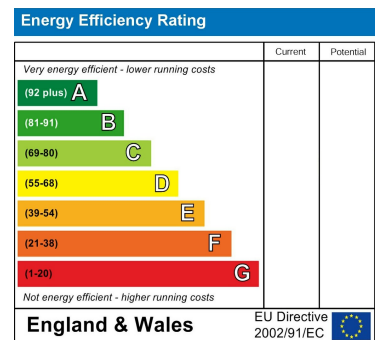

These particulars, whilst believed to be accurate are set out as a general outline only for guidance and do not constitute any part of an offer or contract. Intending purchasers should not rely on them as statements of representation of fact, but must satisfy themselves by inspection or otherwise as to their accuracy. No person in this firm's employment has the authority to make or give any representation or warranty in respect of the property.