

Pennybutts Close, Golborne, WA3 3WQ  
£995 PCM





BALMER & CO are delighted to offer TO RENT this four bedroom semi detached property available for immediate occupancy. Accommodation comprises in brief, entrance hallway with downstairs cloakroom/W.C, living room, and kitchen. To the first floor are three bedrooms and family bathroom. To the second floor is a master double bedroom with en-suite shower room. Outside to the rear is an enclosed garden, and driveway to front providing off road parking.

Floor Plan

1 Pennybutts Close  
Total Approx. Floor Area 900 Sq.ft. (85.4 Sq.M.)

Surveyed and drawn by Lens Media for illustrative purposes only. Not to scale. Whilst every attempt was made to ensure the accuracy of the floor plan, all measurements are approximate and no responsibility is taken for any error.

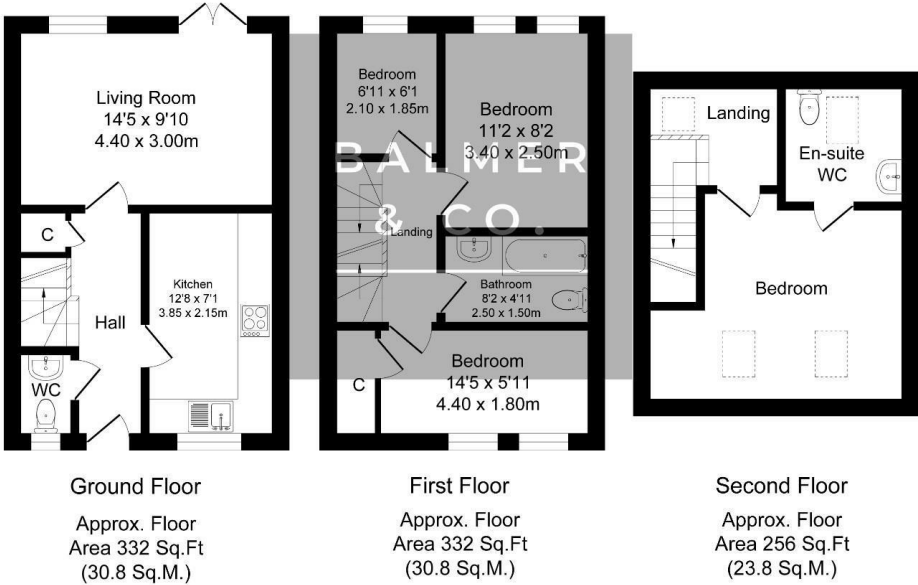

Area Map

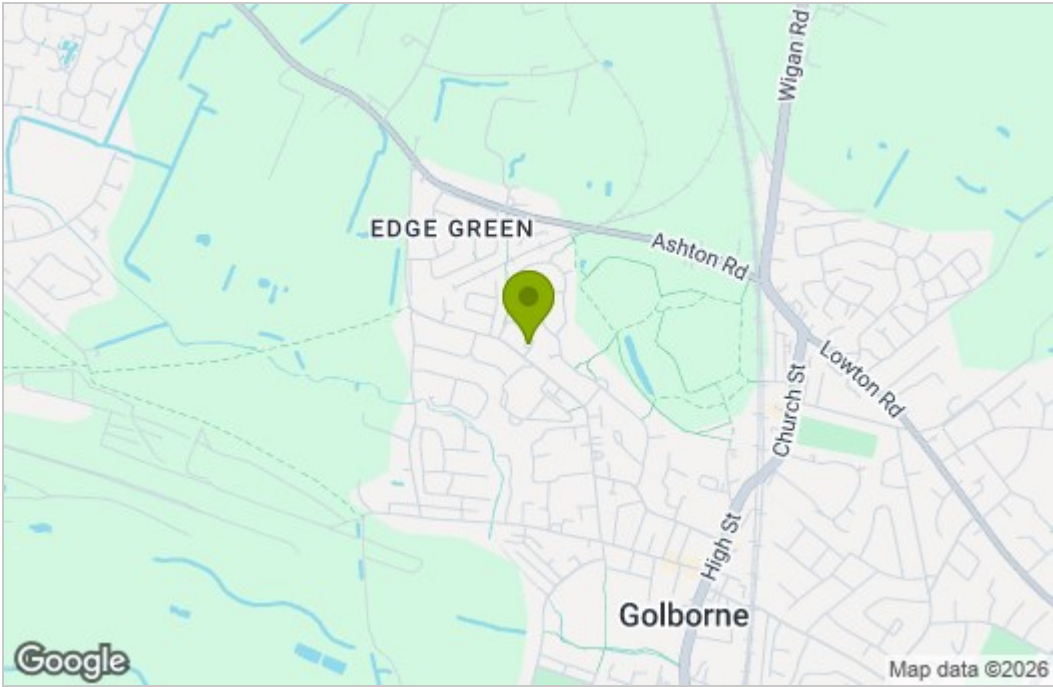

Energy Efficiency Graph

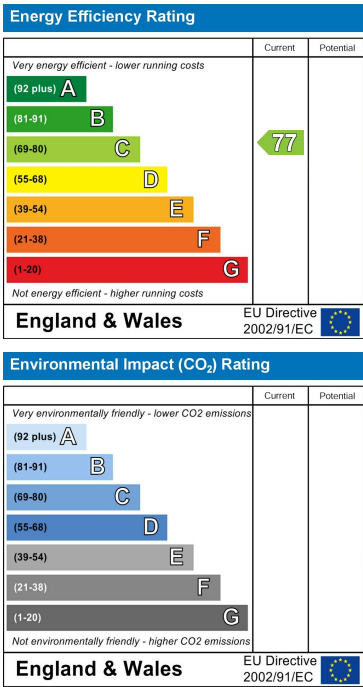

These particulars, whilst believed to be accurate are set out as a general outline only for guidance and do not constitute any part of an offer or contract. Intending purchasers should not rely on them as statements of representation of fact, but must satisfy themselves by inspection or otherwise as to their accuracy. No person in this firms employment has the authority to make or give any representation or warranty in respect of the property.