



Webbs

Helping people move since 1994

Lister Close | Walsall | WS2 7HP

Asking Price £160,000

 **Webbs**
estate agents

Summary

****NO CHAIN**KITCHEN DINER**GENEROUS PLOT**TWO DOUBLE BEDROOMS**FITTED KITCHEN**FITTED BATHROOM**PERFECT FIRST TIME BUY OR INVESTMENT**VIEWING ESSENTIAL**NO CHAIN****

Welcome to this charming end-terrace house located on Lister Close in Walsall. this delightful home is offered for sale with no onward chain, making it an ideal choice for those looking to move in without delay.

Nestled in a popular area, the property is conveniently close to a variety of local amenities, including shops, schools, and excellent road and transport links, ensuring that everything you need is within easy reach.

As you approach the house, you will find a well-maintained front garden featuring a lawn and a paved area, perfect for enjoying the outdoors. Upon entering, you are greeted by a welcoming entrance hall that leads into a spacious through lounge, providing a comfortable space for relaxation and entertaining. The lounge seamlessly flows into the kitchen diner, creating a wonderful area for family meals and gatherings.

On the first floor, you will discover two generous bedrooms, offering ample space for rest and personalisation. The family bathroom is conveniently located to serve both bedrooms, ensuring practicality

Key Features

- TWO BEDROOM HOME
- PERFECT FIRST TIME BUY OR INVESTMENT
- GENEORUS PLOT
- CLOSE TO ALL LOCAL AMENITIES
- DECEPTIVELY SPACIOUS
- NO CHAIN
- VIEWING ESSENTIAL
- POPULAR LOCATION
- KITCHEN DINER
- CALL WEBBS TO SECURE YOUR VIEWING ON 01922 663399!!!!

Rooms and Dimensions

Entrance Hall

Lounge

13'11" x 12'6" (4.263m x 3.828m)

Kitchen Diner

15'11" x 9'5" (4.856m x 2.877m)

Lobby

Store

First Floor Landing

Bedroom One

15'11" x 11'2" (4.864m x 3.409m)

Bedroom Two

12'10" x 7'5" (3.915m x 2.269m)

Shower Room

6'8" x 5'11" (2.044m x 1.823m)

Identification Checks B





GROUND FLOOR

1ST FLOOR

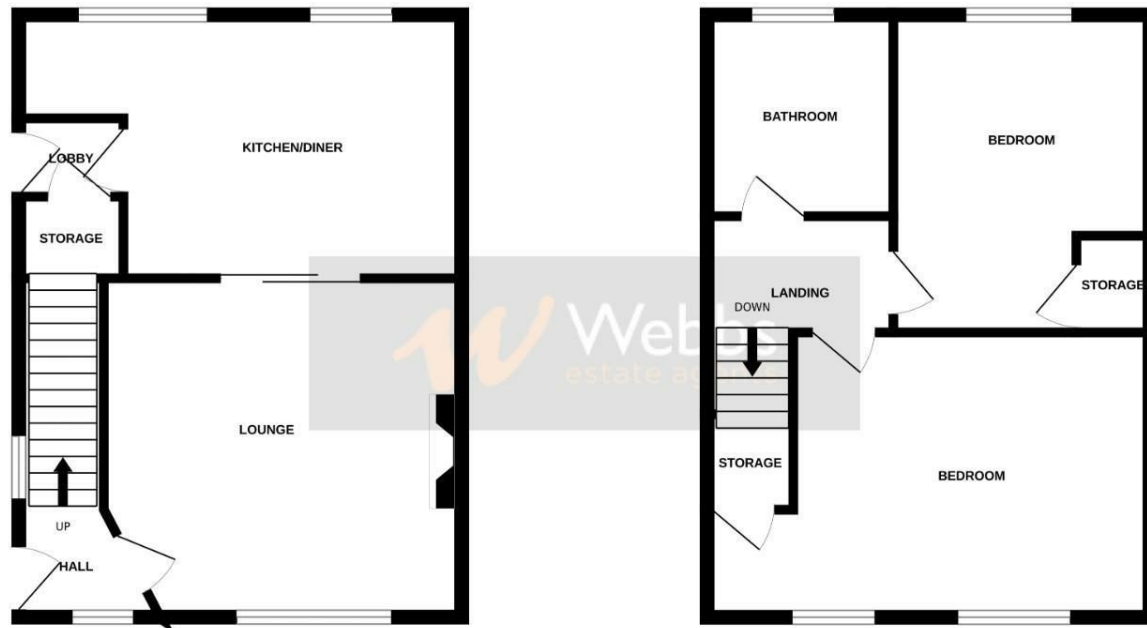

Whilst every attempt has been made to ensure the accuracy of the floorplan contained here, measurements of doors, windows, rooms and any other items are approximate and no responsibility is taken for any error, omission or mis-statement. This plan is for illustrative purposes only and should be used as such by any prospective purchaser. The services, systems and appliances shown have not been tested and no guarantee as to their operability or efficiency can be given.
Made with Metropix ©2026

Webbs Estate Agents - endeavour to maintain accurate depictions of properties in Virtual Tours, Floor Plans and descriptions, however, these are intended only as a guide and purchasers must satisfy themselves by personal inspection.

Energy Efficiency Rating		Environmental Impact (CO ₂) Rating	
Current	Potential	Current	Potential
Best energy efficiency - lower energy costs 100-120 kWh/m ² /year 120-135 kWh/m ² /year 135-150 kWh/m ² /year 150-165 kWh/m ² /year 165-180 kWh/m ² /year 180-200 kWh/m ² /year 200+ kWh/m ² /year	A B C D E F G	Best environmental impact - lower CO ₂ emissions 100-120 g/m ² /year 120-140 g/m ² /year 140-160 g/m ² /year 160-180 g/m ² /year 180-200 g/m ² /year 200-220 g/m ² /year 220+ g/m ² /year	A B C D E F G
87 66			
England & Wales EU Directive 2002/91/EC		England & Wales EU Directive 2002/91/EC	