



14 Wesley Avenue

Hounslow, Hounslow

SALE AGREED BY OAKHILL, SIMILAR PROPERTIES REQUIRED. Situated on a popular residential road, this extended three bedroom family home is ideally located for a choice of excellent local schools, access to Hounslow Central and West tube stations and local amenities. The ground floor has been extended and offers an inviting hallway, a large open plan reception/dining room with bay window, a spacious kitchen with direct access to the rear garden and a WC. The first floor offers a master bedroom with bay window, second double bedroom, a single bedroom and a family bathroom. Externally the property offers driveway parking with EV charging, alongside a large rear garden with side access.

- Three Bedroom
- End of Terrace
- Driveway Parking
- Close to Schools
- Large Rear Garden
- Potential to Extend (STPP)



SCAN HERE
FOR
PROPERTY
DETAILS



Wesley Ave, Hounslow TW3 4LU

Approximate Gross Internal Area
Main House 1033 sq ft - 96 sq m

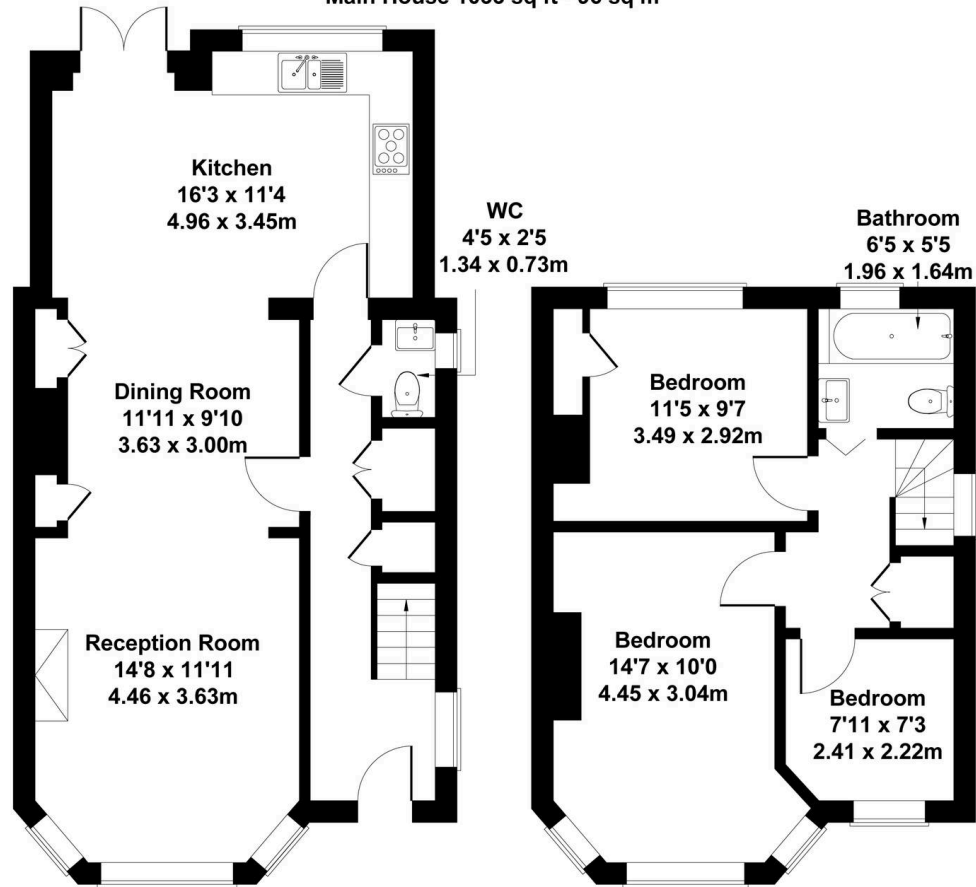

GROUND FLOOR

FIRST FLOOR

This floorplan is for guidance only and does not form part of an offer or contract.
Buyers or tenants should verify all details through inspection, searches, and surveys.
Measurements are approximate and should not be relied upon for valuation or transactions.
Produced by Plan Portal.
www.evolveLondon.co.uk