



DANIEL GREEN

exp<sup>®</sup> UK

@ daniel.green@exp.uk.com

🌐 danielgreen.exp.uk.com

☎ 020 3930 3550 / 07541 999 544

# Ovaltine Court, Kings Langley, WD4

£235,000

🛏️ 2 🚿 2 🛋️ 1



- **\*\*\*PLEASE QUOTE REFERENCE - DG1277\*\*\***
- **Deed of Variation completed capping ground rent**
- **Ideal first-time buy or high-demand rental investment**
- **New PVC windows, Lift access & secure development**
- **\*\*\*INCENTIVE AVAILABLE\*\*\***
- **Two generous double bedrooms & Two modern bathrooms (1 En-suite)**
- **Bright open-plan living & dining space**
- **Excellent condition throughout**
- **Partial Grand Union Canal views**
- **Allocated underground parking**



**\*\*\*PLEASE QUOTE REFERENCE - DG1277\*\*\***

Chain free and stylish two bedroom, two bathroom apartment set within the iconic Ovaltine Building, WD4  
 Perfect for First-Time Buyers & Buy-to-Let Investors |  
 Underground Parking | Moments from the Station

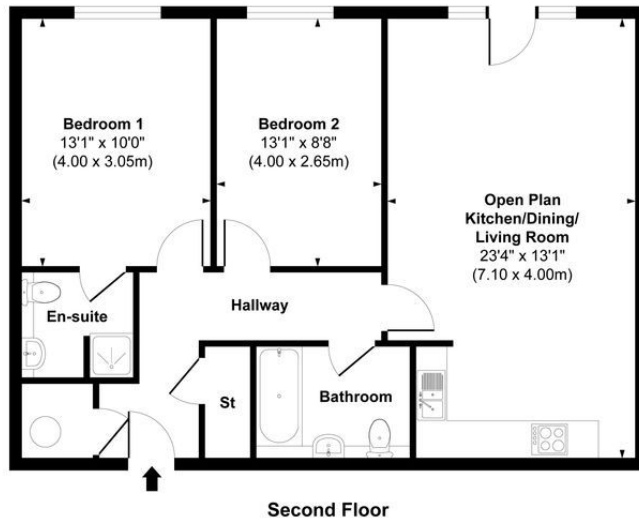

Approx. Gross Internal Floor Area 757 sq. ft / 70.36 sq. m.  
 This floorplan is intended for illustrative purposes only and should be used as a general guide. All measurements are approximate and not to scale.  
 Exact dimensions should be independently verified.

