



**Stellman Close, E5**

**£750,000**

**Dexters**



## Stellman Close, E5

A modern, three bedroom freehold house with private garden and driveway. Recently renovated by its current owners, the home has an open plan kitchen/ living room with Crittal doors, two modern bathrooms and loft space. It is being sold chain free.

Entering on street level, the ground floor consists of a spacious living room with open plan kitchen and built in appliances. Black Crittal doors lead onto the private garden which also has rear access. An additional bathroom with shower is also on this level.

Upstairs are three double bedrooms and modern family bathroom.

The property has been tastefully renovated throughout and benefits from double glazed windows and a plethora of storage. The private driveway has enough space for two cars and there is potential to extend into the loft, subject to planning.

Stellman Close is a quiet residential cul-de-sac located around the corner from Hackney Downs Park which offers many opportunities for outdoor recreation, including tennis. Rectory Road, Clapton, Hackney Downs and Hackney Central Overground stations are all half a mile away providing numerous transport links across London. The many shops, cafés and restaurants on Kingsland Road, Mare Street and Chatsworth Road are also within walking distance.

### Features

- Freehold Terrace
- Three Double Bedrooms
- Two Bathrooms
- Private Garden
- Loft Potential, STPP
- Private Driveway



# Stellman Close, London, E5

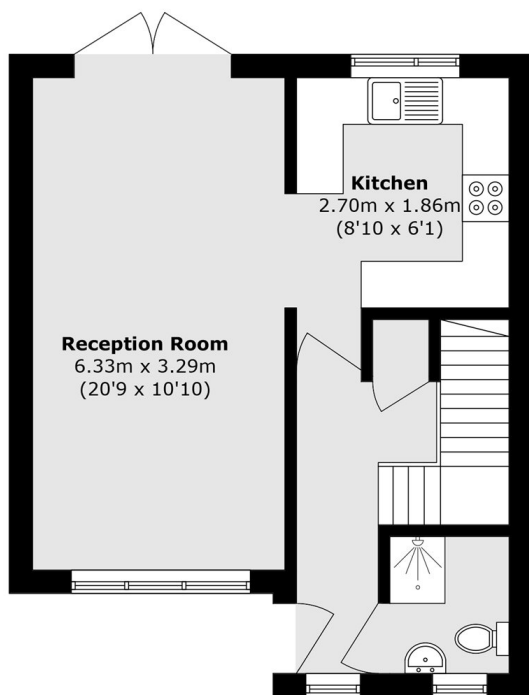

**Ground Floor**

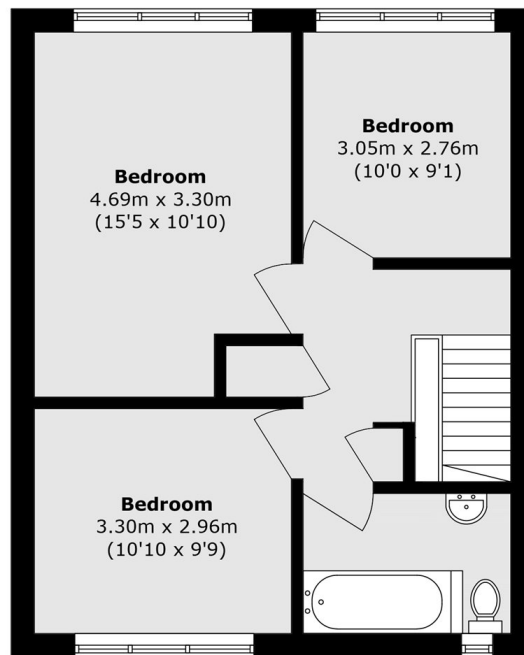

**First Floor**

Total area (approx.): 89.6 sq. m (964.4 sq. ft)