



**Kingfisher Way, Cheswick Green, B90 4LW**  
**Marketed by Tom Cooper powered by eXp**



# Description

Kingfisher Way is ideally positioned in the heart of Cheswick Green, a popular village known for its friendly community feel and attractive surroundings. The property is just a short walk from the centre of the village where you will find local shops, amenities and everyday conveniences, along with easy access to nearby countryside walks and open green spaces that make this area particularly appealing for families and dog walkers alike. The location also offers convenient access to Solihull town centre and surrounding areas, combining village living with strong transport links.

This three bedroom mid terraced home is offered through shared ownership, presenting a fantastic opportunity for buyers looking to step onto the property ladder in a sought after location.

To the front of the property there are two allocated parking spaces, providing convenient off road parking. Stepping inside, you are welcomed by an entrance hallway which includes a downstairs toilet, a practical feature for day to day living.

Positioned to the front of the property is the modern fitted kitchen, offering plenty of cupboard and worktop space, making it well suited for both everyday cooking and entertaining. To the rear sits the lounge diner, a bright and comfortable living space with a window and door leading out to the garden, allowing natural light to flow in. The room also benefits from access to an understairs storage cupboard, providing useful additional storage.

Upstairs, the property offers a modern bathroom fitted with a bath and shower over, along with a handy airing cupboard. There are two large double bedrooms, both offering generous proportions, while the third bedroom is a good size single room that would work perfectly as a child's bedroom, nursery or home office. Additional storage space further adds to the practicality of the home.

To the rear is a pleasant garden, providing an outdoor space to relax, entertain or enjoy time with family and friends.

With its village setting, nearby countryside walks and easy access to local amenities, this home offers a great opportunity for buyers looking to enjoy the lifestyle that Cheswick Green is known for while taking an affordable first step into home ownership.

Tenure: Leasehold 114 years remaining (approx.)

Sellers onwards position: No onward chain

EPC Rating: B

Council Tax Band: D

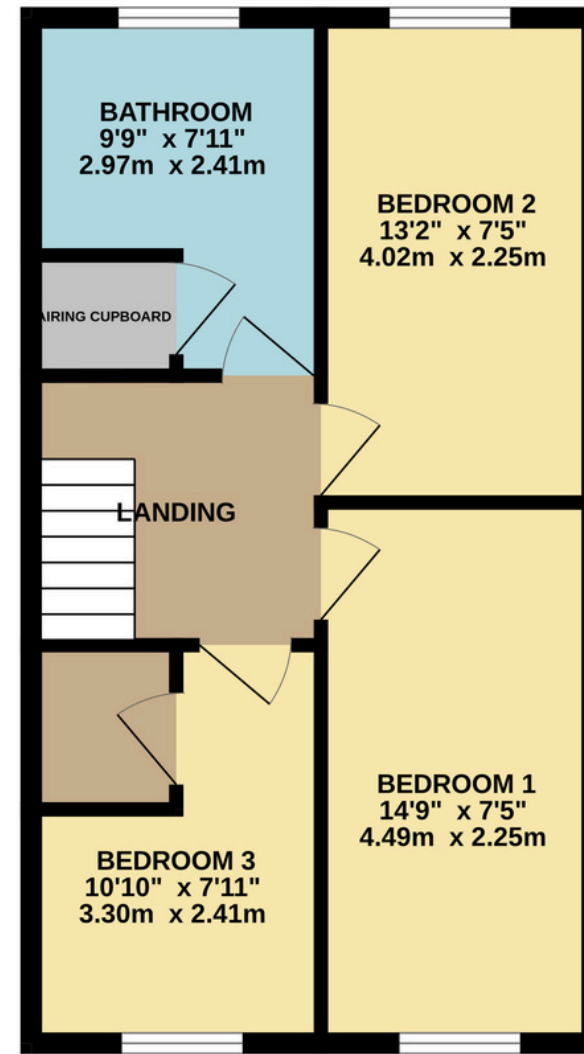
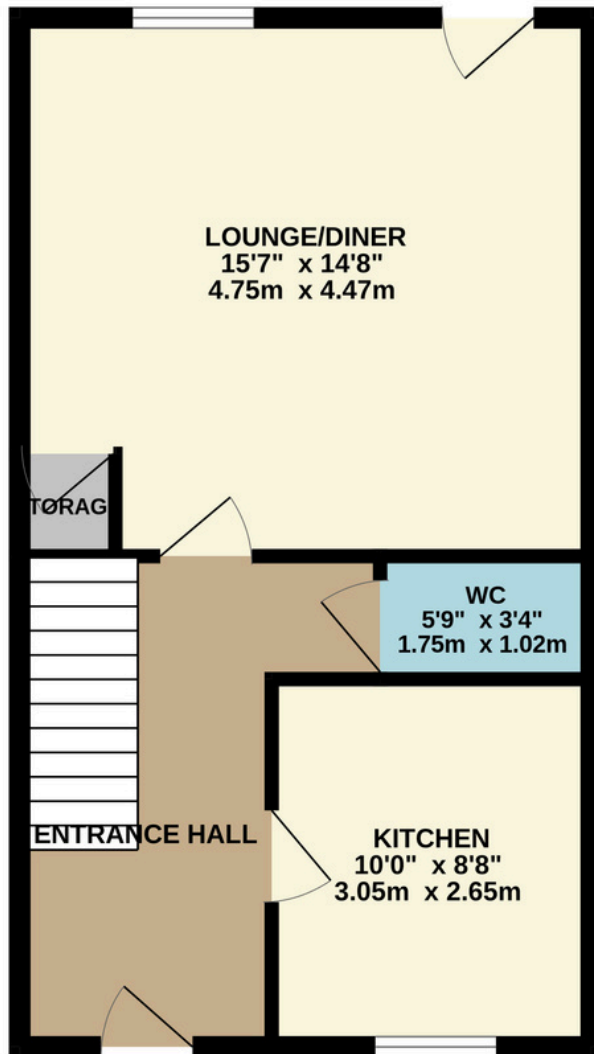





# Why sell with Tom?

As an experienced estate agent covering Solihull, Birmingham, and Warwickshire, I take pride in delivering a fresh and innovative approach to buying and selling properties. With **over 10 years of experience**, I've built a bespoke agency that prioritizes a personal and modern service designed to make your property journey seamless and **stress-free**. Communication is key, which is why I offer a direct line for my clients to call, text, or WhatsApp me anytime with a guaranteed response. My services are available **seven days a week**, including evenings, ensuring you can reach me at a time that suits you. I operate on a **no sale, no fee** basis with no upfront commission or lengthy tie-in periods, giving you peace of mind and flexibility. I offer **professional photography**, detailed floor plans, and engaging video tours, all tailored to showcase your home at its best. Unlike traditional agencies, I don't believe in tying clients into long contracts. Instead, I focus on delivering results and providing a service that speaks for itself. Let me show you how selling your home should be done.

Get in touch to experience a modern, **hassle-free** way of moving.

TOM COOPER  
exp<sup>®</sup>

