



Beech Drive  
Camberley, GU17 0NA

£525,000 Guide Price

## Property Details

 3 bedrooms

 2 baths

 EPC Rating TBC

 1561sqft (inc garage)

 Blackwater Station (0.4 miles)

- Three Bedroom Chalet Bungalow
- Modern Kitchen/Breakfast Room in Excellent Condition
- Two Reception Rooms
- Conservatory
- Driveway Parking for Several Cars
- Large & Private Rear Garden
- Detached Single Garage 21' Long
- Walking Distance to Great Local Schools & Shops
- Direct Access into 'Monkey Woods'

Situated in a sought-after residential road in Blackwater, this well-presented chalet bungalow offers versatile and spacious accommodation, ideal for a range of buyers.

The property is conveniently located within walking distance of local shops, well-regarded schools and everyday amenities, making it perfectly suited for family living.

Internally, the home features a bright and airy living room to the front, along with a generous dining room providing an excellent space for entertaining and flows nicely into a conservatory overlooking the rear garden. The kitchen/breakfast room is presented in lovely condition, offering ample storage and workspace with room for informal dining. There are three well-proportioned bedrooms across the ground and first floors, serviced by two modern bathrooms.

The rear garden is a particular highlight-enjoying a sunny aspect and a high degree of privacy, it backs directly onto woodland with gated access into the popular Monkey Woods, perfect for walking. To the front, there is a driveway providing off-road parking for several vehicles, in addition to a long detached single garage offering further storage or workshop potential.

An excellent opportunity to acquire a versatile home in a desirable location-early viewing is highly recommended.

.....  
[01276 534100](tel:01276534100) / [james@seymours-blackwater.co.uk](mailto:james@seymours-blackwater.co.uk)



## Property Details

### Beech Drive

Approximate Gross Internal Area = 129.4 sq m / 1393 sq ft  
Approximate Garage Internal Area = 15.6 sq m / 168 sq ft  
Approximate Total Internal Area = 145 sq m / 1561 sq ft

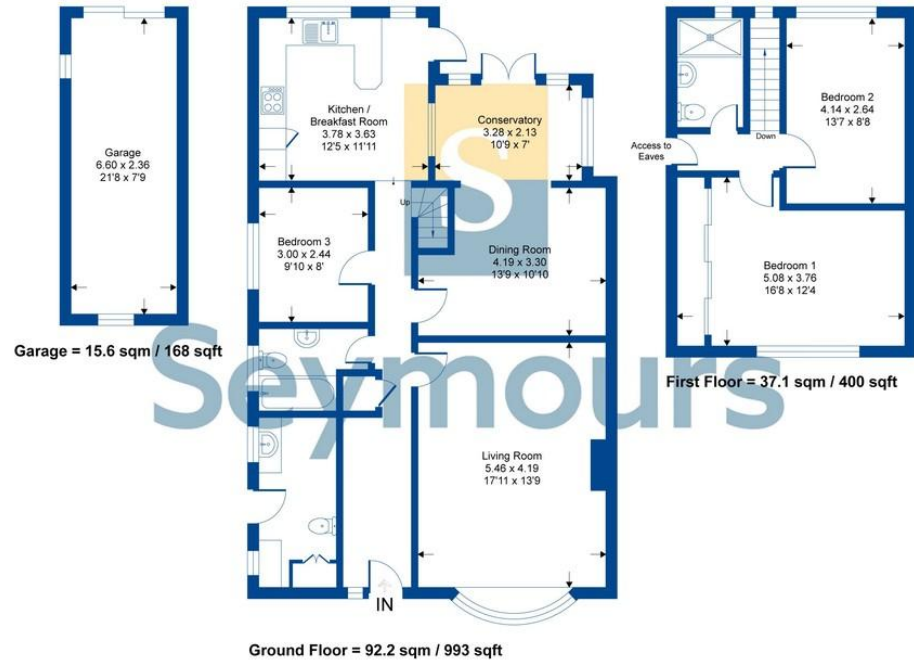

Whilst every attempt has been made to ensure the accuracy of the floor plan contained here, measurements of doors, windows, rooms and any other items are approximate and no responsibility is taken for any error, omission or mis-statement. This plan is for illustrative purposes only and should be used as such by any prospective purchaser.



Seymours Blackwater Office 6 Kings Parade, 34 London Road, Blackwater, Camberley, Surrey, GU17 9AA  
01276 534100 / james@seymours-blackwater.co.uk / seymours-estates.co.uk

The information contained in these Sales Particulars does not form part of any contract neither is any warranty given or implied by Seymours or their clients as to the accuracy of measurements of details stated. Every effort is made to ensure that our Sales Particulars are correct and reliable. We do not test service, systems and appliances and we are unable to verify they are in working order.