



Airmyn Avenue
Hull

Asking price £110,000

 WIGWAM

- 2 reception rooms
- Off-street parking
- Close to local amenities
- No onward chain

This two-bedroom mid-terrace house offers a wonderful blend of comfort and practicality, perfectly suited for first-time buyers, young professionals, those looking to downsize, or investors.

Situated in a sought-after residential area, the property is ideally located within easy reach of local shops, reputable schools, and excellent transport links, ensuring convenience for every-day living.

As you step inside, you are greeted by a welcoming entrance hall that leads to two generously proportioned reception rooms, providing versatile spaces for relaxing, entertaining, or working from home.

The reception rooms are flooded with natural light, creating a warm and inviting atmosphere throughout.

The kitchen boasts modern fittings and ample storage.



Upstairs, you will find two spacious bedrooms, each thoughtfully designed to offer peace and privacy, and each benefiting from built-in wardrobe storage. There is also a family bathroom.

The property benefits from off-street parking; a rare and valuable asset in this area and a private rear garden with lawn and decked area.

Offered with no onward chain, this home allows for a smooth and speedy purchase process, making it an ideal choice for those eager to settle in quickly.

With its combination of versatile living spaces, practical amenities, and a prime location close to all essential facilities, this mid-terrace house stands out as a fantastic opportunity not to be missed.

Tenure: Freehold

Council Tax band: A

Tenure: Freehold





Living room

With carpet, bay window, and electric fire.

Dining room

With carpet, storage, and window.

Kitchen

With laminate flooring, shaker style kitchen units, oven with gas hob, sink and tap, plumbing for washing machine, window, and door to rear garden.

Bedroom 1

With carpet, large bay window, and built in storage.

Bathroom

With carpet, bath with shower, toilet, wash basin on pedestal, and window.

Bedroom 2

With carpet, built in storage, and window.

Garden

Private garden with lawn and decked area.

Driveway

Drive way in front of the property for 1 vehicle





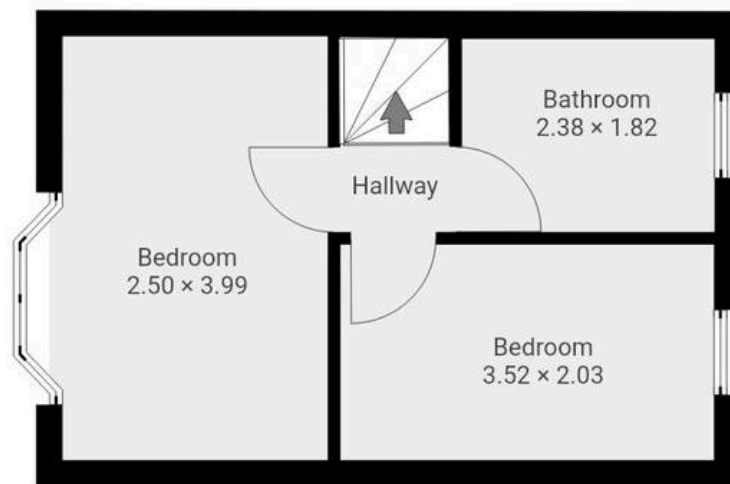



Wigwam

Block A, Unit 7B, Flemingate, Beverley - HU17 0NQ

01482505152 • hello@wigwamhomes.co.uk • www.wigwamhomes.co.uk