



## 30 PATERDALE AVENUE

WARRINGTON, WA2 9NP

£160,000  
FREEHOLD

Offered with NO ONWARD CHAIN this three bedroom terraced property in a very popular residential area of Orford, Warrington. The generously sized home provides gardens to front and back and has fantastic living space internally. The family home is positioned in a very convenient location just a short drive from Warrington Town Centre as well as excellent M6 and M62 motorway links to Liverpool, Manchester and further afield.



GROUND FLOOR  
354 sq.ft. (32.9 sq.m.) approx.

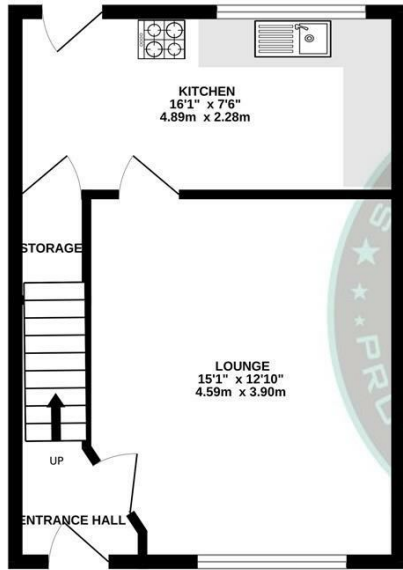

1ST FLOOR  
444 sq.ft. (41.2 sq.m.) approx.

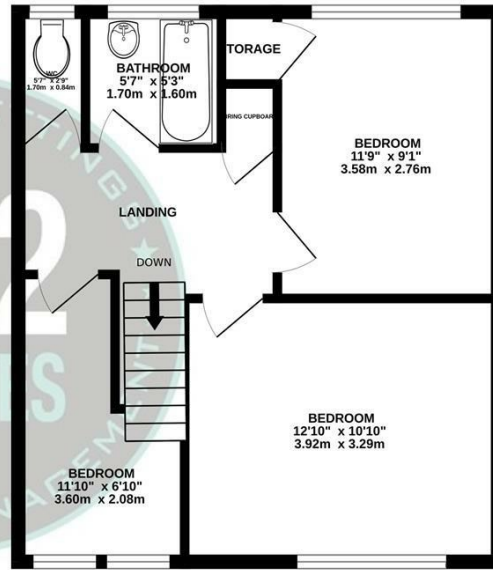

TOTAL FLOOR AREA : 798 sq.ft. (74.1 sq.m.) approx.

Whilst every attempt has been made to ensure the accuracy of the floorplan contained here, measurements of doors, windows, rooms and any other items are approximate and no responsibility is taken for any error, omission or mis-statement. This plan is for illustrative purposes only and should be used as such by any prospective purchaser. The services, systems and appliances shown have not been tested and no guarantee as to their operability or efficiency can be given.  
Made with Metropix ©2026

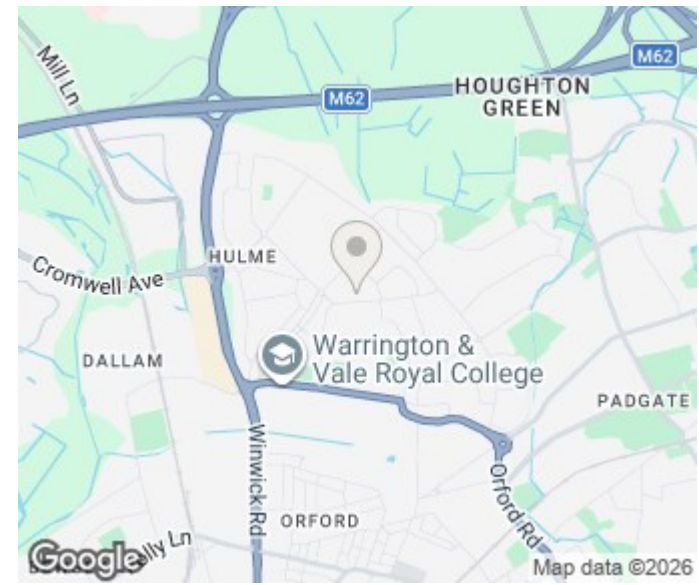

Energy Efficiency Rating		Current	Potential
Very energy efficient - lower running costs			
(92 plus) <b>A</b>			
(81-91) <b>B</b>			
(69-80) <b>C</b>			
(55-68) <b>D</b>		<b>67</b>	<b>82</b>
(39-54) <b>E</b>			
(21-38) <b>F</b>			
(1-20) <b>G</b>			
Not energy efficient - higher running costs			
<b>England &amp; Wales</b>		EU Directive 2002/91/EC	

Agents Note: Whilst every care has been taken to prepare these particulars, they are for guidance purposes only. All measurements are approximate and are for general guidance purposes only and whilst every care has been taken to ensure their accuracy, they should not be relied upon and potential buyers/tenants are advised to recheck the measurements

222 Estates Lettings and Sales  
222 Orford Lane Orford  
Warrington  
Cheshire  
WA2 7BB

01925 499599  
info@222estates.co.uk  
www.222estates.co.uk

