



VILLAGE ESTATES

• EST.1993 •



93 Main Road, Sidcup, Kent DA14 6ND

Tel: 0208 302 1002

www.village-estates.com

Email: sidcup@village-estates.com



**SIDCUP & NEW ELTHAM TRAIN
ST**

GROUND FLOOR FLAT

LONG LEASE 981 YEARS

ALLOCATED PARKING SPACE

AMPLE HALLWAY STORAGE

WELL PRESENTED

THROUGHOUT



**3 Chelsiter Court Main Road
Sidcup, DA14 6PL**

**Guide Price £290,000-
£300,000**

ALLOCATED PARKING SPACE / LONG LEASE / NO CHAIN / CLOSE TO SIDCUP HIGH STREET. Village Estates present a two bedroom ground floor flat situated within a well maintained building nearby to Longlands primary school, an array of high street shops, cafes and restaurants also between two mainline train stations.

EPC RATING: C

COUNCIL TAX BAND: C

TENURE: Share of Freehold

LEASE TERM: 981 YEARS REMAINING



Chelsiter Court, Main Road, DA14



Approximate Gross Internal Area = 61.5 sq m / 662 sq ft

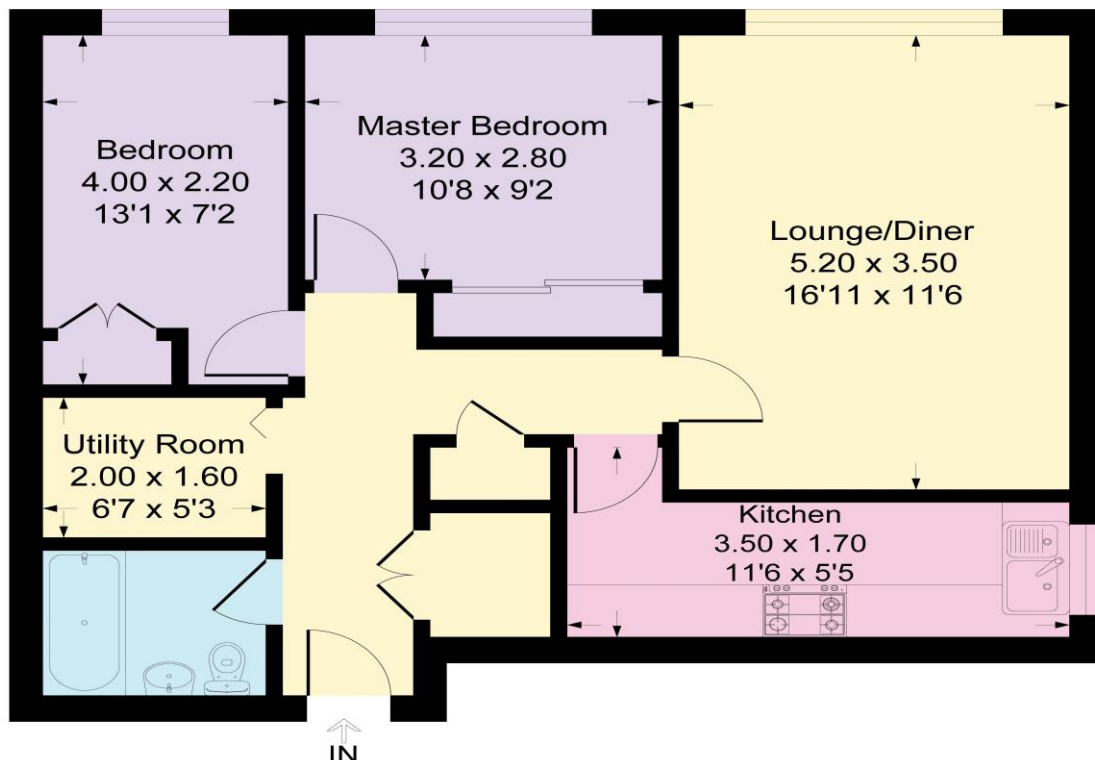

CONSUMER PROTECTION FROM UNFAIR TRADING REGULATIONS 2008

Please note that any services, heating system or appliances have not been tested, and no warranty can be given or implied as to their working order. You are advised to obtain verification from your solicitor or surveyor. References to the tenure of a property are based on information supplied by the seller. We have not had sight of the title documents and a buyer is advised to obtain verification from their solicitor. Items shown in photographs are not included unless specifically mentioned within the sales particulars, but may be available by separate negotiation. Whilst every attempt has been made to ensure the accuracy of the floor plan contained here, measurements of doors, windows, rooms and any other items are approximate and no responsibility is taken for any error, omission, or mis-statement. We advise you to book an appointment to view before embarking on any journey to see a property, and check its availability. The accuracy of these details are not guaranteed and they do not form part of the contract.