

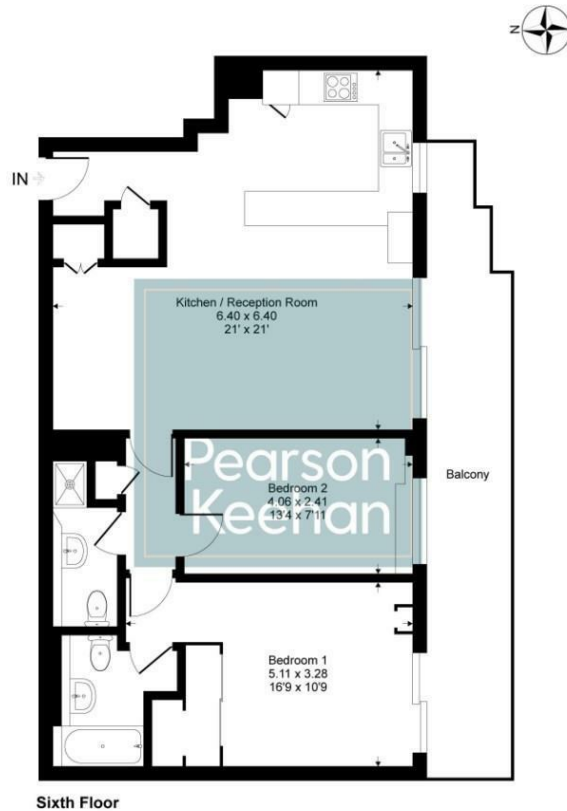

Queens Gardens, Hove, BN3 2LP

£1,900 Per month - Per Calendar Month

Kingsway Court, BN3
Approximate Gross Internal Area = 75 sq m / 807 sq ft



This floor plan is for representation purposes only as defined by the RICS code of Measuring Practice (and IPMS where requested) and should be used as such by any prospective purchaser. Whilst every attempt has been made to ensure the accuracy contained here, the measurement of doors, windows and rooms is approximate and no responsibility is taken for any error, omission or mis-statement. Specifically no guarantee is given on the total area of the property if quoted on the plan. Any figure provided is for guidance only and should not be used for valuation purposes.
Copyright Cassaphotos Ltd. 2022 - Produced for Pearson Keehan

These property details are set out as a general outline only and do not constitute any part of an Offer or Contract. Any services, equipment, fittings or central heating systems have not been tested and no warranty is given or implied that these are in working order. Buyers are advised to obtain verification from their solicitor or surveyor. Fixtures, fittings and other items are not included unless specially described. All measurements, distances and areas are approximate and for guidance only. Room measurements are taken to be the nearest 10 cm and prospective buyers are advised to check these for any particular purpose, e.g. Fitted carpets and furniture. This material is protected by the laws of copyright. The owner of the copyright is Pearson Keehan Estate Agents. This property sheet forms part of our database rights and copyright laws. No unauthorised copying or distribution without permission.

A well-presented sixth-floor apartment situated within the sought-after Kingsway Court development on Queens Gardens, offering stunning sea views and a fantastic seafront location.

The property features a bright and spacious open-plan kitchen, living and dining area with direct access to a private balcony overlooking the seafront, providing the perfect space to relax and enjoy the coastal outlook. There are two good-sized double bedrooms, with the principal bedroom also benefiting from access to the balcony and beautiful sea views.

Further accommodation includes a modern bathroom and separate shower room, offering added convenience for sharers, couples or small families.

Ideally positioned on Brighton and Hove's vibrant seafront, Kingsway Court is moments from the beach, Hove Lawns, popular cafés, restaurants and local amenities, while excellent transport links provide easy access throughout the city and beyond.

Offering spacious accommodation, a private sea-facing balcony and breathtaking coastal views, this is a superb opportunity to enjoy seafront living in one of the area's most desirable locations.

Hot and Heating billed

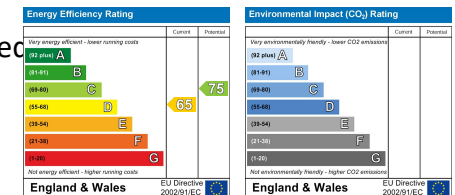

Pearson Keehan

95 Portland Road, Hove, East Sussex, BN3 5DP

Tel: 01273 206999 Email: hove@pearsonkeehan.com

pearsonkeehan.com