



2
B

RICHMONDS

Immaculate Four-Bedroom Semi-Detached Home with a Landscaped Garden

This beautifully presented four-bedroom semi-detached home offers modern living in a highly desirable position on the edge of Hedge End village, conveniently close to local shops, amenities, and transport links.

The property features a spacious open-plan living arrangement, complemented by a welcoming entrance hallway that creates an immediate sense of space and light. The home benefits from tasteful, neutral décor throughout, allowing prospective buyers to easily personalise the space.

Accommodation comprises four well-proportioned bedrooms, including a principal bedroom with an ensuite shower room, in addition to a contemporary family bathroom and convenient ground-floor cloakroom.

Externally, the property boasts a professionally landscaped private rear garden, ideal for both relaxing and entertaining. Further benefits include off-road parking for two vehicles, a garage, gas central heating, and double glazing throughout. Additional features include a partially boarded loft complete with ladder access and lighting, providing excellent storage potential.

Other Information

Tenure: Freehold

Approximate Age: Built approx. 2008

Heating: Gas central heating

Windows: Double glazing

Loft: Partially boarded with ladder and light

Energy Rating: TBC

Sellers Position: Looking for a local property

Local Information:

Council Tax: C

Local Authority: Eastleigh Borough Council



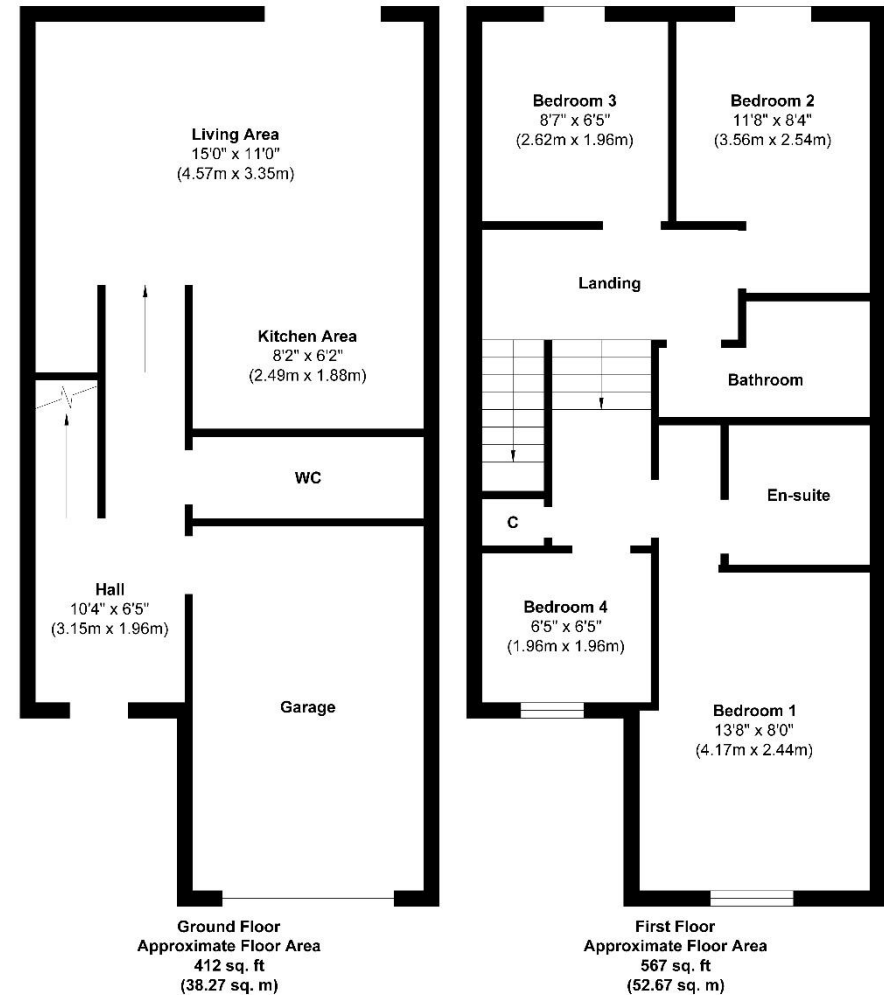

Approx. Gross Internal Floor Area 979 sq. ft / 90.94 sq. m (Excluding Garage)

Illustration for identification purposes only, measurements are approximate, not to scale.
Produced by Elements Property

Agents Note: The sellers of the property have provided the above information to us and we are therefore reliant on them providing the correct information. The floor plan and sizes are to be used as a guide only. Please check room sizes prior to ordering carpets or furniture. If you require confirmation on any particular point for specific purposes please contact our office for further information. If you have other questions about this property, please telephone **01489 789933**

R545 Ravensworth 01670 713330

Lankester House, 1 Freegrounds Road, Hedge End, Southampton SO30 0HG • 01489 789933 • admin@richmondsproperty.co.uk

