

Frank Harris & Co.



Pakenham Street, WC1X

£1,375,000

A very charming period house tucked away in the heart of Bloomsbury. Configured over three floors and boasting high ceilings, the well proportioned accommodation features, a generous eat in kitchen and reception room on the ground floor, an impressive second reception room on the first floor, bedroom and bathroom, whilst the lower ground floor comprises two further double bedrooms, shower room and access to the large patio garden to the rear. The current configuration is as a three-bedroom, two reception property.



Pakenham Street is a quiet road in a conservation area running between Cubitt Street and Wren Street, just to the east of Gray's Inn Road, giving easy access to both the City and the West End, in addition to Kings Cross and St Pancras.

- Freehold house • Centrally located • Large garden •
- Eat-in kitchen • Three double bedrooms • Great transport links •







Frank Harris & Co.

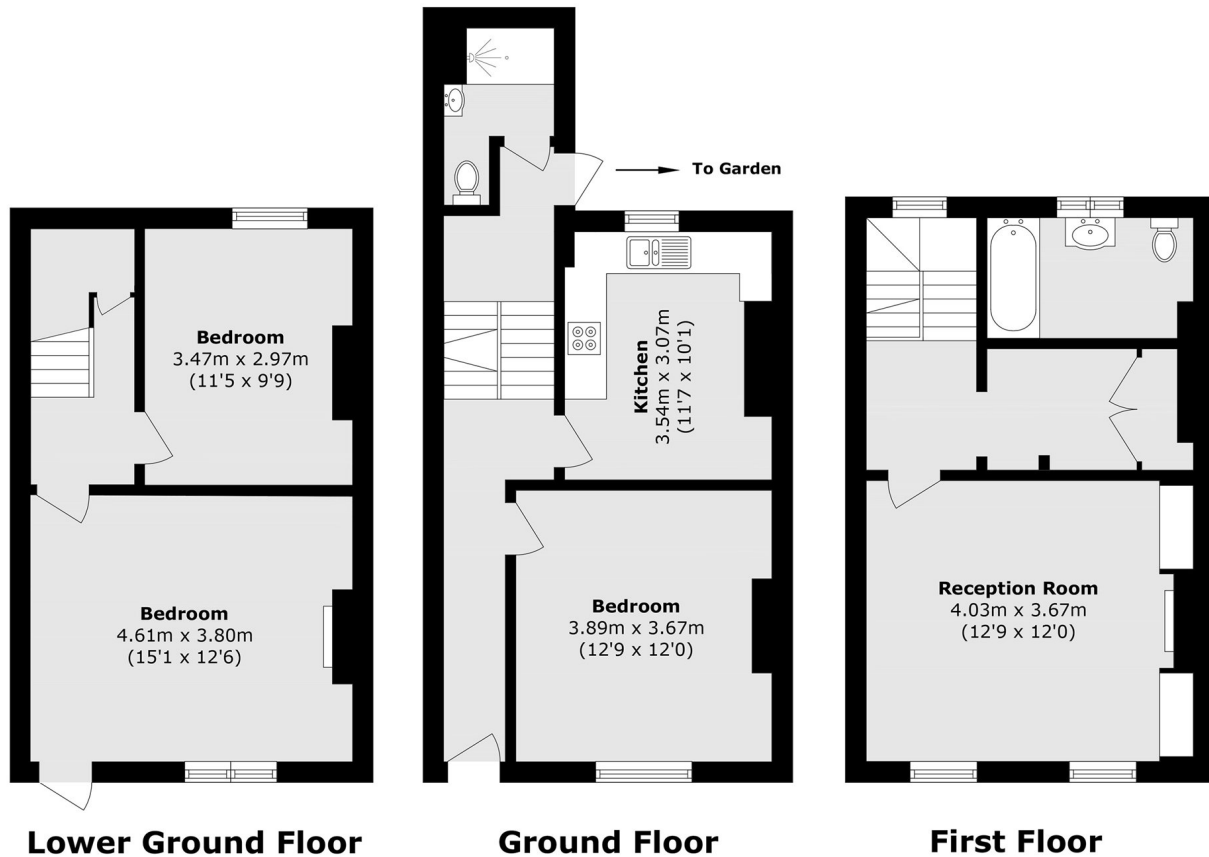

Total area (approx.): 112.1 sq. m (1206.6 sq. ft)

Frank Harris & Co. Bloomsbury and Kings Cross
81 Marchmont Street,
London, WC1N 1AL
020 7405 4444
bloomsburysales@frankharris.co.uk

Energy Rating: . We aim to make our particulars both accurate and reliable. However they are not guaranteed; nor do they form part of an offer or contract. If you require clarification on any points then please contact us, especially if you're traveling some distance to view. Please note that appliances and heating systems have not been tested and therefore no warranties can be given as to their good working order.

