



1 Albert Road, Rufford

Ormskirk

Guide Price £235,000

# 1 Albert Road

Rufford, Ormskirk

Two bedroom semi-detached bungalow on a large corner plot in Rufford. Requires modernisation. Gardens, driveway, garage. Great potential for extension (STPP). Close to amenities and transport. Council Tax band: B

Tenure: Leasehold

EPC Energy Efficiency Rating: E

EPC Environmental Impact Rating:

- Ideal Renovation Project
- Two Bedroom Semi-Detached Bungalow
- Generous Corner Plot
- Excellent Development Potential (STPP)
- Conservatory
- Detached Garage
- Driveway Providing Off-Road Parking





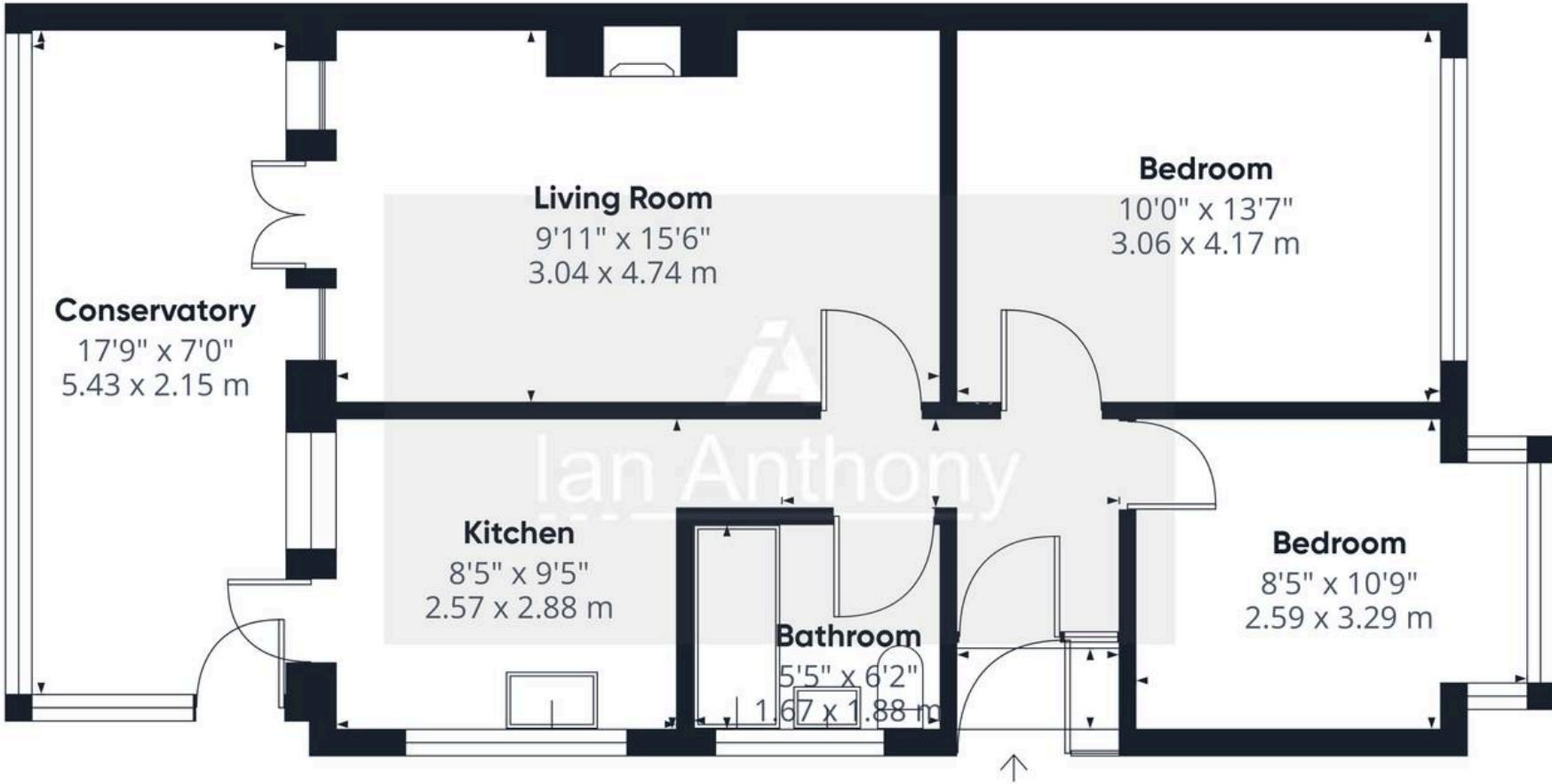

Approximate total area<sup>(1)</sup>

694 ft<sup>2</sup>  
64.4 m<sup>2</sup>

(1) Excluding balconies and terraces

Calculations reference the RICS IPMS 3C standard. Measurements are approximate and not to scale. This floor plan is intended for illustration only.





## IAN ANTHONY

5 Burscough Street, Ormskirk - L39 2EG

01695580888

[enquiries@iananthonyestates.co.uk](mailto:enquiries@iananthonyestates.co.uk)

[iananthonyestates.co.uk/](http://iananthonyestates.co.uk/)

