

Sussex Way, N19

£450,000

A charming two bedroom apartment located on the ground floor of a Victorian conversion. The property is in excellent condition, benefits from private outside space, and comes with a share of the freehold.

Sussex Way is located just off one of the most vibrant high streets in North London, offering a wide array of shops, cafés and restaurants. Holloway Road and Archway stations are also close by.

Features

- Two Bedrooms
- Ground Floor
- Share of Freehold
- Period Conversion
- Good Transport Links
- Excellent Condition

Sussex Way, London, N19

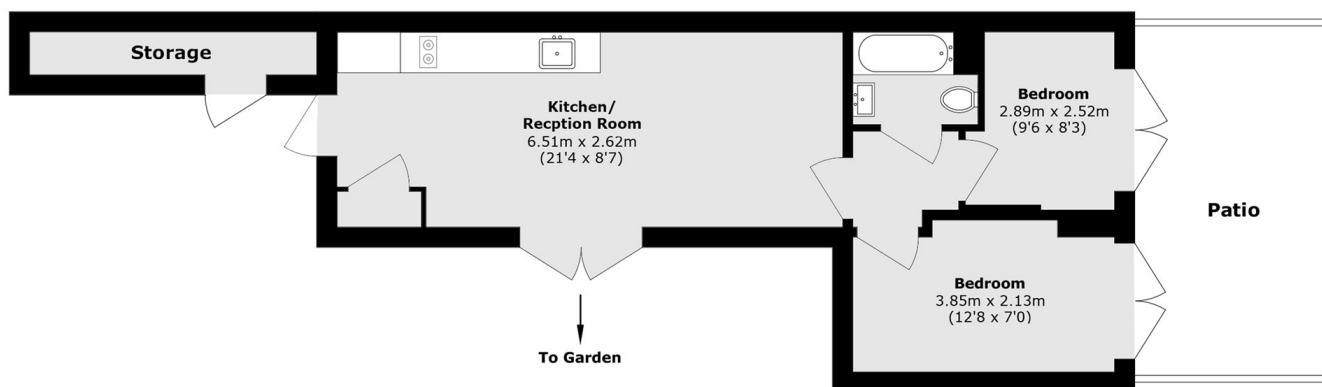

Total area (approx.): 41.0 sq. m (441.3 sq. ft)