



LIGHTERMAN TOWERS

London SW10



LOCATED WITHIN AFTER CHELSEA NEIGHBOURHOOD

An immaculately presented apartment on Chelsea Island at Harbour Avenue in South West London benefitting from rare private underground parking



Local Authority: London Borough of Hammersmith and Fulham

Council Tax band: F

Tenure: Share of Freehold Approximately 990 years remaining on the lease.

Ground rent: £550 per annum - fixed, please enquire for next review period and date.

Service charge: £5,670 per annum, reviewed annually, please enquire for next review date.

Guide Price: £795,000



A VILLAGE-LIKE NEIGHBOURHOOD

A bright, one-bed apartment featuring a southeast-facing balcony with spectacular views of the Shard, the London Eye and the Thames. The interiors feature high-end appliances, premium fittings, smart-home control panel manages lighting, cooling and underfloor heating. The open-plan reception room and state-of-the-art kitchen share balcony access with the bedroom and boasts floor-to-ceiling windows throughout. The reception room has ample of space for living and dining. The principal bedroom is generous in size and has excellent fitted wardrobes. This apartment includes a private 24/7 secured parking space, close to an EV charger, a 24hr concierge and a well-equipped gym.

We have been informed that the primary external wall materials of the building/block have been assessed for fire safety. The assessor concluded that the fire risk of the external wall materials is sufficiently low that no remedial works are required. If you have any further questions, you should seek independent professional advice







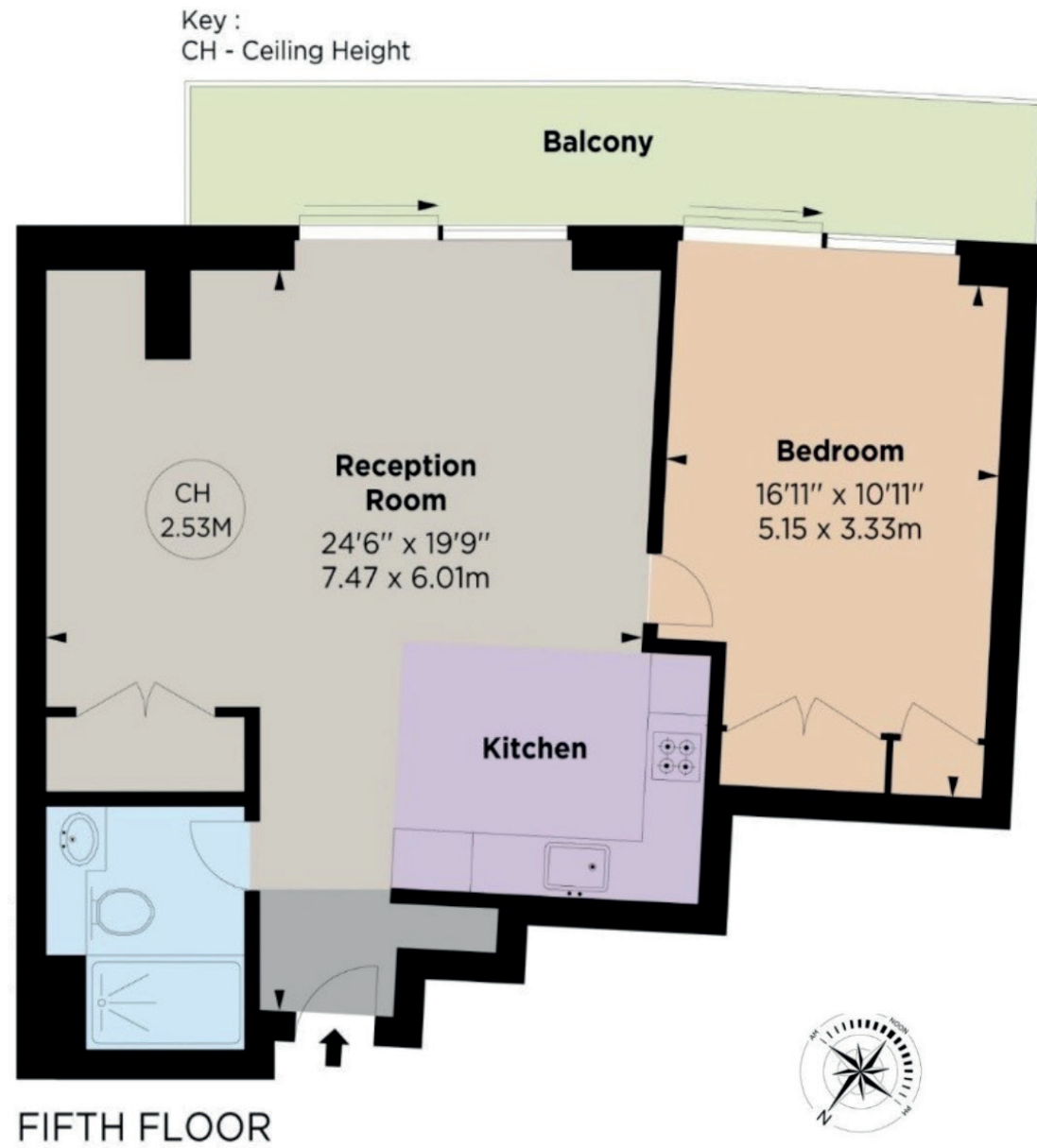

Harbour Avenue, SW10
Approximate Gross Internal Area = 64.06 sq m / 689 sq ft

This plan is for layout guidance only. Not drawn to scale unless stated. Windows and door openings are approximate. Whilst every care is taken in the preparation of this plan, please check all dimensions, shapes and compass bearings before making any decisions reliant upon them. (ID767266)

We would be delighted
to tell you more.

Claire Mengham

02039782462

claire.mengham@knightfrank.com

Knight Frank South Kensington & Chelsea

352A Kings Road

Chelsea, London SW3 5UU

[knightfrank.co.uk](https://www.knightfrank.co.uk)

Your partners in property

1. Particulars: These particulars are not an offer or contract, nor part of one. You should not rely on statements given by Knight Frank in the particulars, by word of mouth or in writing ("information") as being factually accurate about the property, its condition or its value. Neither Knight Frank nor any joint agent has any authority to make any representations about the property, and accordingly any information given is entirely without responsibility on the part of Knight Frank. 2. Material Information: Please note that the material information is provided to Knight Frank by third parties and is provided here as a guide only. While Knight Frank has taken steps to verify this information, we advise you to confirm the details of any such material information prior to any offer being submitted. If we are informed of changes to this information by the seller or another third party, we will use reasonable endeavours to update this as soon as practical. 3. Photos, Videos etc: The photographs, property videos and virtual viewings etc. show only certain parts of the property as they appeared at the time they were taken. Areas, measurements and distances given are approximate only. 4. Regulations etc: Any reference to alterations to, or use of, any part of the property does not mean that any necessary planning, building regulations or other consent has been obtained. A buyer must find out by inspection or in other ways that these matters have been properly dealt with and that all information is correct. 5. Fixtures and fittings: A list of the fitted carpets, curtains, light fittings and other items fixed to the property which are included in the sale (or may be available by separate negotiation) will be provided by the Seller's Solicitors. 6. VAT: The VAT position relating to the property may change without notice. 7. To find out how we process Personal Data, please refer to our Group Privacy Statement and other notices at <https://www.knightfrank.com/legals/privacy-statement>. Particulars dated May 2026. Photographs and videos dated May 2026. All information is correct at the time of going to print. Knight Frank is the trading name of Knight Frank LLP. Knight Frank LLP is a limited liability partnership registered in England and Wales with registered number OC305934. Our registered office is at 55 Baker Street, London W1U 8AN. We use the term 'partner' to refer to a member of Knight Frank LLP, or an employee or consultant. A list of members names of Knight Frank LLP may be inspected at our registered office. If you do not want us to contact you further about our services then please contact us by either calling 020 3544 0692, email to marketing.help@knightfrank.com or post to our UK Residential Marketing Manager at our registered office (above) providing your name and address.

We have made reasonable enquiries regarding the fire safety (including, but not limited to, the external wall of the building), but have been advised that there is no information available. You should ensure you take independent professional advice and carry out your own investigations before making an