

# LANES

SALES & LETTINGS

Joanna Bufton  
Lettings Consultant

# LANES

SALES & LETTINGS

Tel: 01908 508037

Email: [Joanna@lanesmk.co.uk](mailto:Joanna@lanesmk.co.uk)



## 38 Kercroft, Two Mile Ash, Milton Keynes, Bucks, MK8 8AR

Lanes are pleased to present to the market this 1-bed ground floor apartment situated in Two Mile Ash within driving distance to local amenities.

The property comprises of lounge, modern kitchen with white goods included, a double bedroom and bathroom. The home further benefits from being in a cul-de-sac area, a small front garden and allocated parking for one car.

Please note this home is going through a redecoration stage, and will be available mid-February 2026.

Viewing recommended and available February 2026 on an unfurnished basis.

- One Bedroom
- Modern Bathroom
- Professionals Only
- White Goods
- Allocated Parking
- Council Tax Band A
- Modern Kitchen
- Available Beginning of February

## £895 PCM

38 Kercroft, Two Mile Ash, Milton Keynes, Bucks, MK8 8AR  
14355736  
£895 PCM

Ground Floor

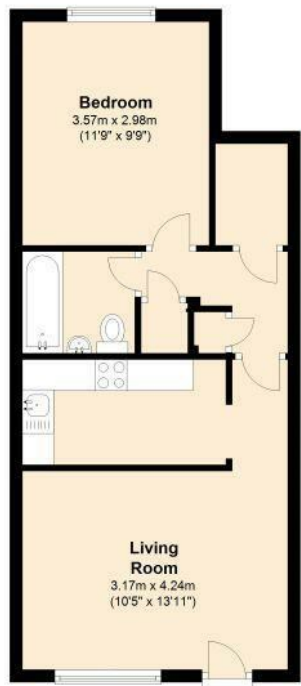

Ground Floor



Energy Efficiency Rating		
	Current	Potential
Very energy efficient - lower running costs		
(92 plus) A		
(81-91) B		
(69-80) C		
(55-68) D		
(39-54) E		
(21-38) F		
(1-20) G		
Not energy efficient - higher running costs		
	71	81
England & Wales		
EU Directive 2002/91/EC		

Environmental Impact (CO <sub>2</sub> ) Rating		
	Current	Potential
Very environmentally friendly - lower CO <sub>2</sub> emissions		
(92 plus) A		
(81-91) B		
(69-80) C		
(55-68) D		
(39-54) E		
(21-38) F		
(1-20) G		
Not environmentally friendly - higher CO <sub>2</sub> emissions		
	64	69
England & Wales		
EU Directive 2002/91/EC		