



Mulberry Way,

Price £310,000

**FOR SALE**



- Ground Floor Apartment
- Spacious
- Balcony
- Two Bedrooms
- En-suite to Main Bedroom
- Allocated Parking

## THE PROPERTY

This well-presented ground floor apartment offers comfortable and practical living space, ideal for first-time buyers, downsizers, or investors. The property benefits from an allocated parking space and a well-designed layout extending to approximately 728sq ft.

Approx Gross Internal Area  
68 sq m / 728 sq ft

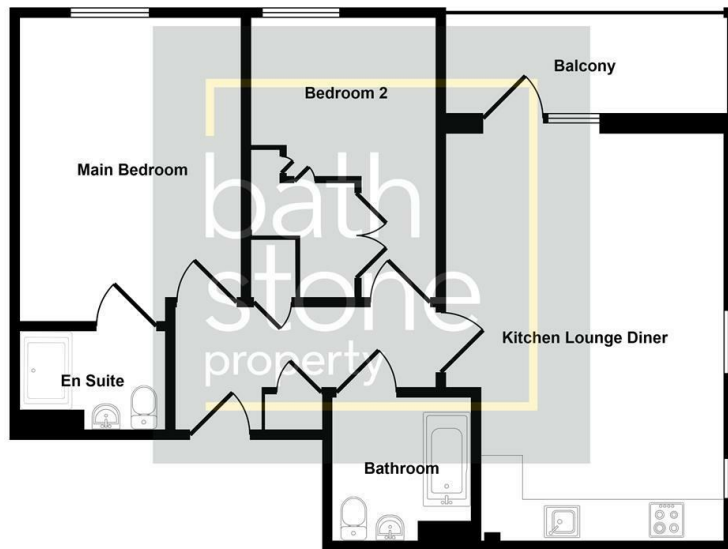

Floorplan

This floorplan is only for illustrative purposes and is not to scale. Measurements of rooms, doors, windows, and any items are approximate and no responsibility is taken for any error, omission or mis-statement. Icons of items such as bathroom suites are representations only and may not look like the real items. Made with Made Snappy 360.

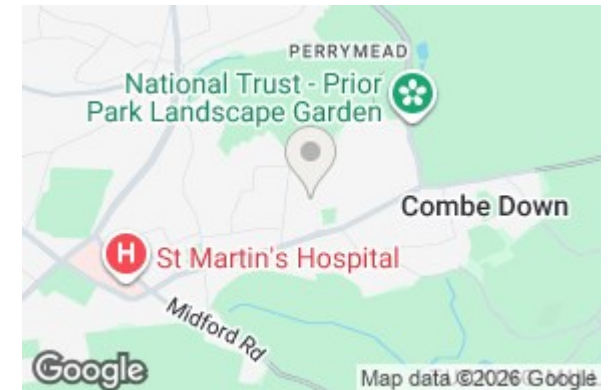

Energy Efficiency Rating		Current	Potential
Very energy efficient - lower running costs			
(92 plus) <b>A</b>			
(81-91) <b>B</b>		<b>83</b>	<b>83</b>
(69-80) <b>C</b>			
(55-68) <b>D</b>			
(39-54) <b>E</b>			
(21-38) <b>F</b>			
(1-20) <b>G</b>			
Not energy efficient - higher running costs			
<b>England &amp; Wales</b>		EU Directive 2002/91/EC	