



Newton Avenue, W3

£550,000

A ground floor two bedroom apartment with its own entrance situated on the Chiswick/ Acton border. The flat has a private front and rear garden and will be sold with a share of freehold.

Under a quarter of a mile from South Acton station (Overground) and just over half a mile from Acton Town tube station (District and Piccadilly lines).

Features

- Ground Floor Maisonette
- Own Entrance
- Private Front Garden
- Private Rear Garden
- Share Of Freehold
- No Onward Chain

Newton Avenue, London, W3

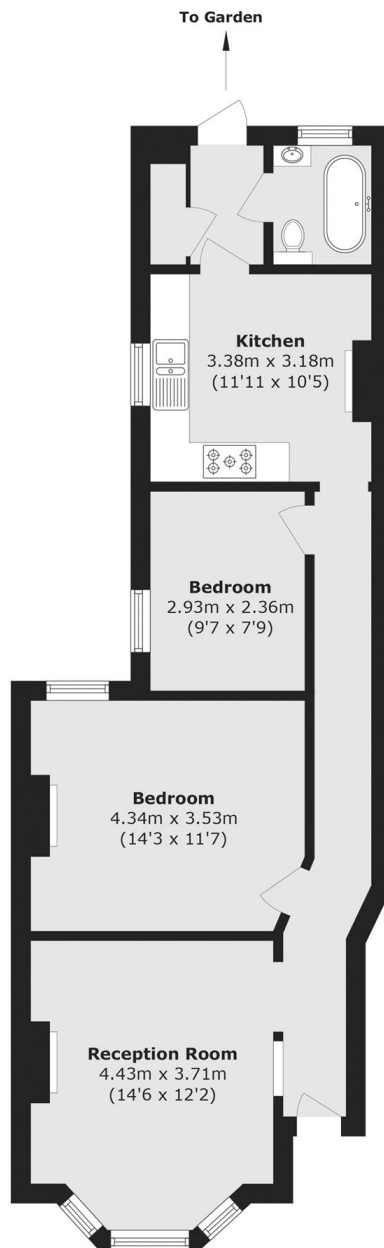

Total area (approx.): 65.9 sq. m (709.3 sq. ft)