

Frank Harris & Co.



Herbal Hill Gardens, Farringdon, EC1R

£850,000

A stylish top floor apartment with a west facing, full width balcony. There is a contemporary open plan kitchen with integrated appliances, wooden flooring throughout, two double bedrooms, air conditioning and a shower room. The flat benefits from a long lease (approx. 968 years) and a central Clerkenwell location.



Herbal Hill Gardens has newly redecorated common areas, an experienced concierge, gymnasium, recreation space, swimming pool and courtyard garden along with excellent transport connections.

Clerkenwell is renowned for the quality and variety of its bars and restaurants. There is a thriving specialist coffee scene, and in addition to a Waitrose and numerous supermarkets, just steps away there is a good range of artisan food and wine purveyors. Filled with narrow streets, cobbled alleyways and secret squares, Clerkenwell boasts a wealth of green space.

Conveniently located close to the City's financial district as well as the four Inns of Court all of which are within walking distance.

Situated close to Farringdon Station (Circle, Hammersmith and City, Metropolitan and Elizabeth Line), and City Thameslink under a quarter of a mile walk.

- Top Floor Apartment • Two Bedrooms • Full Width Balcony •
- Secure Parking Space • Daytime Concierge • Residents Pool And Gym •



Frank Harris & Co.

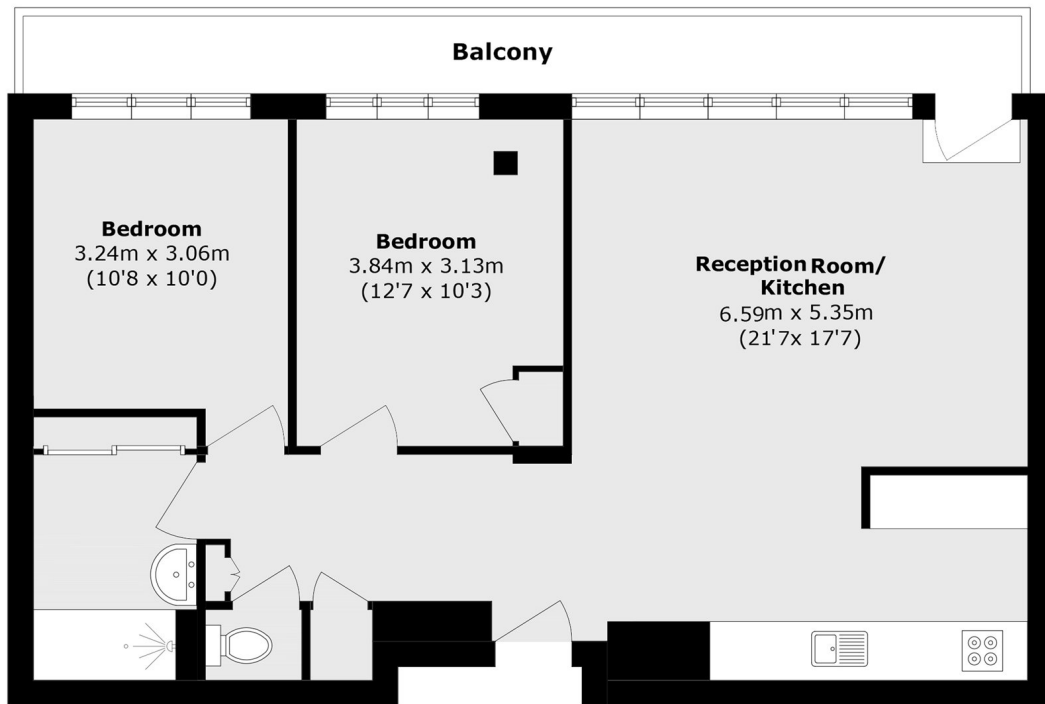

Total area (approx.): 75.6 sq. m (813.7 sq. ft)
Balcony area (approx.): 10.6 sq. m (114.0 sq. ft)

Frank Harris & Co. Barbican and City
87 Long Lane, London,
EC1A 9ET
020 7600 7000
citysales@frankharris.co.uk

Energy Rating: C. We aim to make our particulars both accurate and reliable. However they are not guaranteed; nor do they form part of an offer or contract. If you require clarification on any points then please contact us, especially if you're traveling some distance to view. Please note that appliances and heating systems have not been tested and therefore no warranties can be given as to their good working order.

