



Tower Cottages

Portsmouth Road, Esher, KT10 9JH

£850 Per Week

This is an extremely spacious five double bedroom detached cottage style property with private patio/garden and on site parking for several cars. The property is set within a secure gated entry amongst the delightful grounds of 'Tower Court' on the edge of Esher in Surrey, with a marvellous range of shops and restaurant/café's along the High Street as well as, Waitrose, which is just a short drive away. The property comprises of: Large entrance hallway, living room, dining room, good sized kitchen, five double bedrooms (master on the first floor), three bathrooms (two of these are en-suite). The property also benefits from having French doors leading out to own patio and use of the impressive communal grounds and verdant views surrounding the Cottage. It is neutrally decorated and is offered unfurnished and can be furnished at extra cost. Well trained dog/cat and children are welcome in this house. Available NOW for long let.

- Five Double Bedrooms
- Three Bathrooms
- Reception
- Dining room
- Private Patio
- Ample Parking
- Short Drive to town centre

Viewing

Please contact our Messila Residential Office on 020 7586 6699 if you wish to arrange a viewing appointment for this property or require further information.



Floor Plan

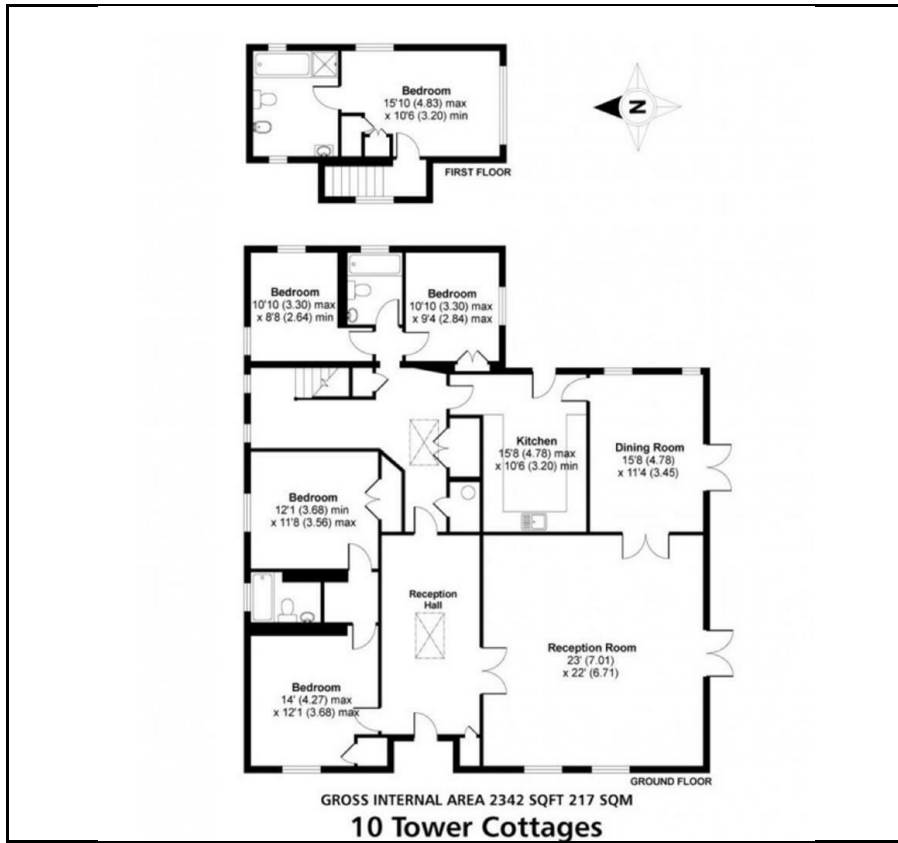

Area Map



Energy Efficiency Graph

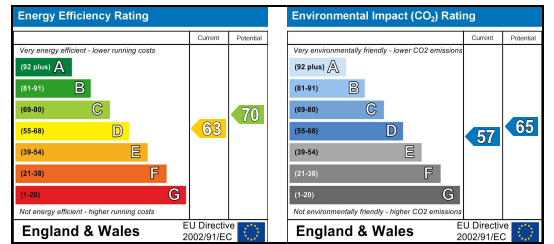

These particulars, whilst believed to be accurate are set out as a general outline only for guidance and do not constitute any part of an offer or contract. Intending purchasers should not rely on them as statements of representation of fact, but must satisfy themselves by inspection or otherwise as to their accuracy. No person in this firm's employment has the authority to make or give any representation or warranty in respect of the property.

Messila Residential

137 Park Road, London, NW8 7HT

T: 020 7586 6699 E: regentspark@messilaresidential.com W: messilaresidential.com